



Highfields Sutton Common Road, Sutton SM1 3HW



welcome to
Highfields Sutton Common Road, Sutton

Presenting a desirable flat, now on the market for sale. This property is in good condition, thus promising a comfortable living experience. Crafted to accommodate modern living, this flat comprises two well-proportioned bedrooms, a single bathroom, and a reception room. It also features a practical and inviting kitchen.

This property has a lease of 50 years.

The location of this flat also adds considerable value. It is situated in close proximity to public transport links, ensuring easy commuting. Moreover, it is conveniently located near schools, making it an ideal choice for families seeking easy access to educational establishments.

This property is particularly suitable for couples seeking a cozy and comfortable space to call their own. Additionally, it can also be an attractive investment opportunity for investors due to its prime location and unique features.

In conclusion, this well-maintained flat offers a perfect blend of comfort, convenience, and investment potential. The short lease feature, coupled with its strategic location, make it an attractive proposition for a range of prospective buyers. Don't miss out on this wonderful opportunity to acquire a property that caters to modern living needs while also offering considerable investment potential.



HIGHFIELDS

APPROXIMATE GROSS INTERNAL FLOOR AREA: 593 SQ FT - 55.11 SQ M

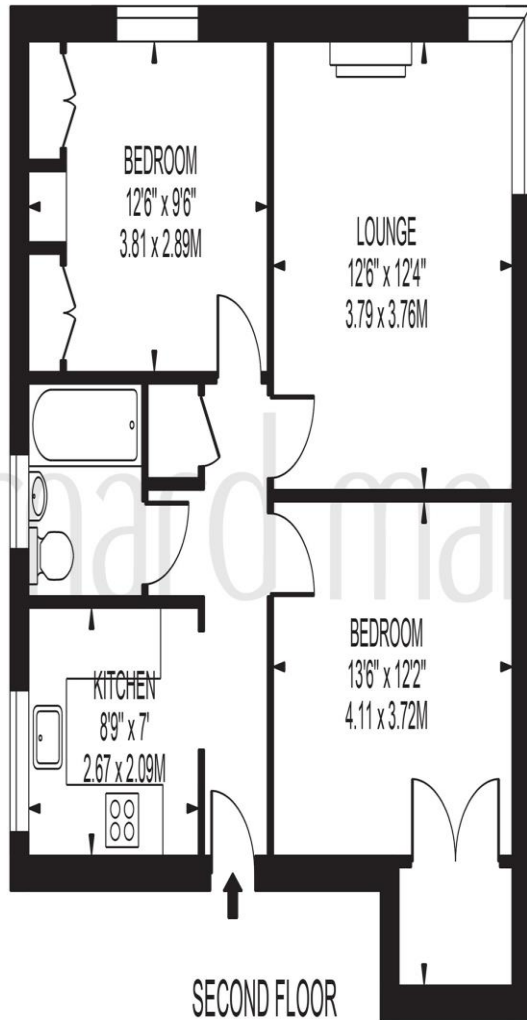

SECOND FLOOR

FOR ILLUSTRATION PURPOSES ONLY

THIS FLOOR PLAN SHOULD BE USED AS A GENERAL OUTLINE FOR GUIDANCE ONLY AND DOES NOT CONSTITUTE IN WHOLE OR IN PART AN OFFER OR CONTRACT. ANY INTENDING PURCHASER OR LESSEE SHOULD SATISFY THEMSELVES BY INSPECTION, SEARCHES, ENQUIRIES AND FULL SURVEY AS TO THE CORRECTNESS OF EACH STATEMENT. ANY AREAS, MEASUREMENTS OR DISTANCES QUOTED ARE APPROXIMATE AND SHOULD NOT BE USED TO VALUE A PROPERTY OR BE THE BASIS OF ANY SALE OR LET.



Auctioneer's Comments

This property is offered through Modern Method of Auction. Should you view, offer or bid your data will be shared with the Auctioneer, iamsold Limited. This method requires both parties to complete the transaction within 56 days, allowing buyers to proceed with mortgage finance (subject to lending criteria, affordability and survey).

The buyer is required to sign a reservation agreement and make payment of a non-refundable Reservation Fee of 4.5% of the purchase price including VAT, subject to a minimum of £6600.00 including VAT. This fee is paid in addition to purchase price and will be considered as part of the chargeable consideration for the property in the calculation for stamp duty liability. Buyers will be required to complete an identification process with iamsold and provide proof of how the purchase would be funded.

The property has a Buyer Information Pack containing documents about the property. The documents may not tell you everything you need to know, so you must complete your own due diligence before bidding. A sample of the Reservation Agreement and

terms and conditions are contained within this pack. The buyer will also make payment of £300 inc VAT towards the preparation cost of the pack.

The estate agent and auctioneer may recommend the services of other providers to you, in which they will be paid for the referral. These services are optional, and you will be advised of any payment, in writing before any services are accepted. Listing is subject to a start price and undisclosed reserve price that can change.

welcome to

Highfields Sutton Common Road, Sutton

- Sale by Modern Auction (T&Cs apply)
- Subject to an undisclosed Reserve Price
- Buyers fees apply
- Two well-proportioned bedrooms
- Good condition

Tenure: Leasehold EPC Rating: E

This is a Leasehold property. We are awaiting further details about the Term of the lease. For further information please contact the branch. Please note additional fees could be incurred for items such as Leasehold packs.

guide price

£200,000



Please note the marker reflects the postcode not the actual property

view this property online [barnardmarcus.co.uk/Property/SUT110133](https://www.barnardmarcus.co.uk/Property/SUT110133)



Property Ref:
SUT110133 - 0002

1. MONEY LAUNDERING REGULATIONS Intending purchasers will be asked to produce identification documentation at a later stage and we would ask for your co-operation in order that there is no delay in agreeing the sale. 2. These particulars do not constitute part or all of an offer or contract. 3. The measurements indicated are supplied for guidance only and as such must be considered incorrect. Potential buyers are advised to recheck measurements before committing to any expense. 4. We have not tested any apparatus, equipment, fixtures or services and it is in the buyers interest to check the working condition of any appliances. 5. Where an EPC, or a Home Report (Scotland only) is held for this property, it is available for inspection at the branch by appointment. If you require a printed version of a Home Report, you will need to pay a reasonable production charge reflecting printing and other costs. 6. We are not able to offer an opinion either written or verbal on the content of these reports and this must be obtained from your legal representative. 7. Whilst we take care in preparing these reports, a buyer should ensure that his/her legal representative confirms as soon as possible all matters relating to title including the extent and boundaries of the property and other important matters before exchange of contracts.

Barnard Marcus is a trading name of Sequence (UK) Limited which is registered in England and Wales under company number 4268443, Registered Office is Cumbria House, 16-20 Hockliffe Street, Leighton Buzzard, Bedfordshire, LU7 1GN. VAT Registration Number is 500 2481 05.



barnard marcus



020 8643 8245



Sutton@barnardmarcus.co.uk



2&3 Regent Parade, Brighton Road, SUTTON,
Surrey, SM2 5BL



[barnardmarcus.co.uk](https://www.barnardmarcus.co.uk)