



Knollmead, Surbiton, KT5 9QR

welcome to
Knollmead, Surbiton

Residing in the highly sought after Sunray Estate, this three bedroom mid-terrace home offers a wonderfully airy open plan living/kitchen/dining area whilst further benefiting from a garage as well as a drive way.



KNOLLMEAD

APPROXIMATE GROSS INTERNAL FLOOR AREA: 676 SQ FT - 62.84 SQ M

(EXCLUDING GARAGE)

APPROXIMATE GROSS INTERNAL FLOOR AREA OF GARAGE: 156 SQ FT - 14.46 SQ M

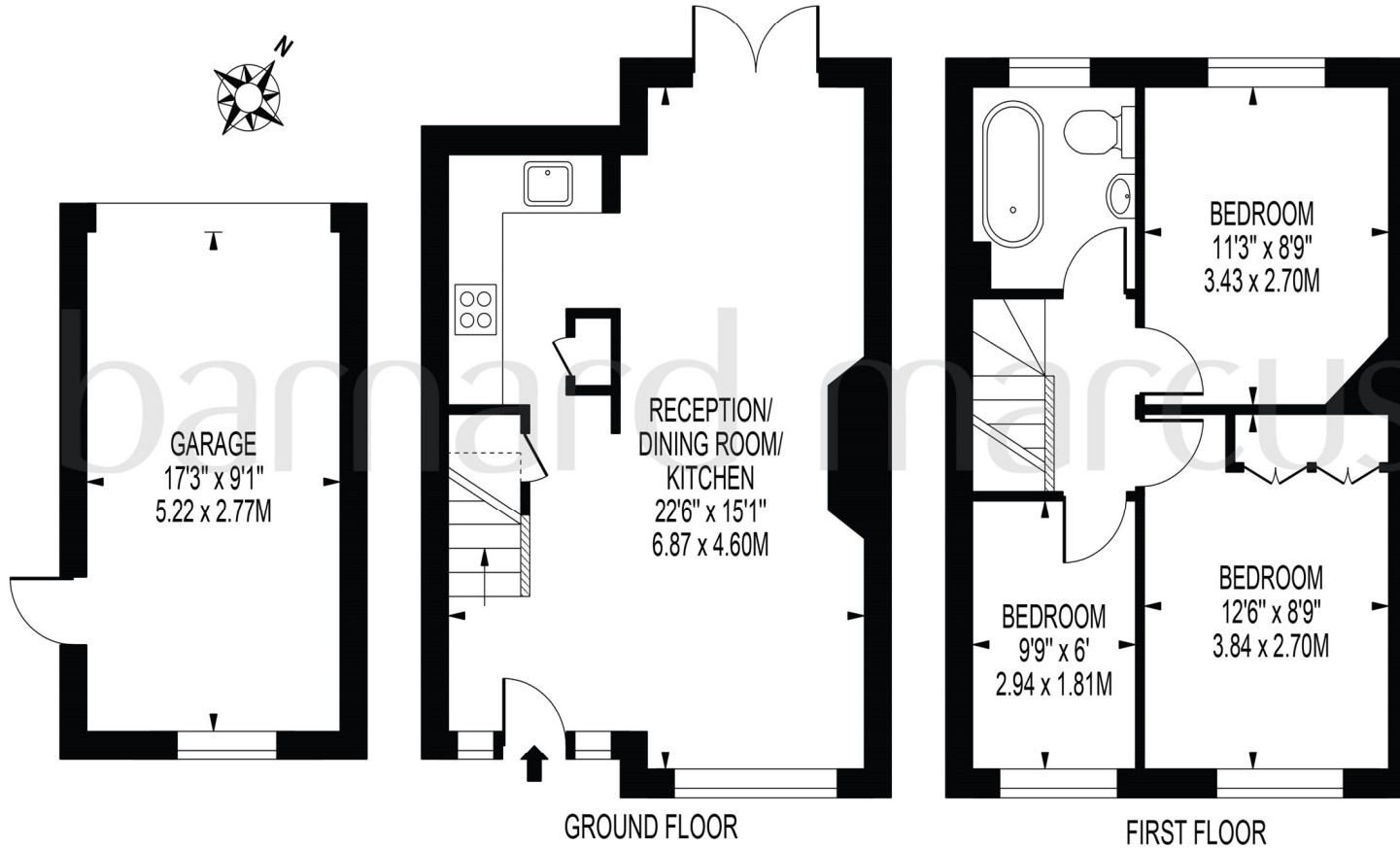

FOR ILLUSTRATION PURPOSES ONLY

THIS FLOOR PLAN SHOULD BE USED AS A GENERAL OUTLINE FOR GUIDANCE ONLY AND DOES NOT CONSTITUTE IN WHOLE OR IN PART AN OFFER OR CONTRACT. ANY INTENDING PURCHASER OR LESSEE SHOULD SATISFY THEMSELVES BY INSPECTION, SEARCHES, ENQUIRIES AND FULL SURVEY AS TO THE CORRECTNESS OF EACH STATEMENT. ANY AREAS, MEASUREMENTS OR DISTANCES QUOTED ARE APPROXIMATE AND SHOULD NOT BE USED TO VALUE A PROPERTY OR BE THE BASIS OF ANY SALE OR LET.

Residing in the highly sought after Sunray Estate, this three bedroom mid-terrace home benefits from an incredibly convenient distance of 0.4 miles to Tolworth Rail Station whilst also falling within the catchments for a variety of good to outstanding primary/secondary schools making this an ideal family home.

The heart of the home lies within the vast open plan living/kitchen/dining area that boasts a contemporary condition throughout as well as benefiting from an unlimited amount of natural light.

The kitchen includes an ample amount of integrated appliances as well as stylish/modern finish. Completing the ground floor of this exciting home is a generously sized rear garden that also includes a garage.

The top floor consists of three very well proportioned bedrooms, the master of which includes built in wardrobe space, as well as a contemporary three piece family bathroom.

With the additional benefit of a drive way, this property is certain to be popular so immediate inspection is advised to avoid disappointment.

welcome to

Knollmead, Surbiton

- Three bedrooms
- Mid-terrace
- Open plan living/kitchen/dining
- Garage
- Drive way

Tenure: Freehold EPC Rating: C

offers in the region of

£425,000



Please note the marker reflects the postcode not the actual property

view this property online barnardmarcus.co.uk/Property/SUR108202



Property Ref:
SUR108202 - 0006

1. MONEY LAUNDERING REGULATIONS Intending purchasers will be asked to produce identification documentation at a later stage and we would ask for your co-operation in order that there is no delay in agreeing the sale. 2. These particulars do not constitute part or all of an offer or contract. 3. The measurements indicated are supplied for guidance only and as such must be considered incorrect. Potential buyers are advised to recheck measurements before committing to any expense. 4. We have not tested any apparatus, equipment, fixtures or services and it is in the buyers interest to check the working condition of any appliances. 5. Where an EPC, or a Home Report (Scotland only) is held for this property, it is available for inspection at the branch by appointment. If you require a printed version of a Home Report, you will need to pay a reasonable production charge reflecting printing and other costs. 6. We are not able to offer an opinion either written or verbal on the content of these reports and this must be obtained from your legal representative. 7. Whilst we take care in preparing these reports, a buyer should ensure that his/her legal representative confirms as soon as possible all matters relating to title including the extent and boundaries of the property and other important matters before exchange of contracts.

Barnard Marcus is a trading name of Sequence (UK) Limited which is registered in England and Wales under company number 4268443, Registered Office is Cumbria House, 16-20 Hockliffe Street, Leighton Buzzard, Bedfordshire, LU7 1GN. VAT Registration Number is 500 2481 05.



barnard marcus



020 8390 8181



Surbiton@barnardmarcus.co.uk



5A Surbiton Parade St. Marks Hill, SURBITON,
Surrey, KT6 4RB



barnardmarcus.co.uk