



The Lodge Leigham Court Road, London SW16 2PL

welcome to
The Lodge Leigham Court Road, London

A lovely two double bedroom ground floor apartment set within this gated development which has been recently decorated and offered to the market chain free.



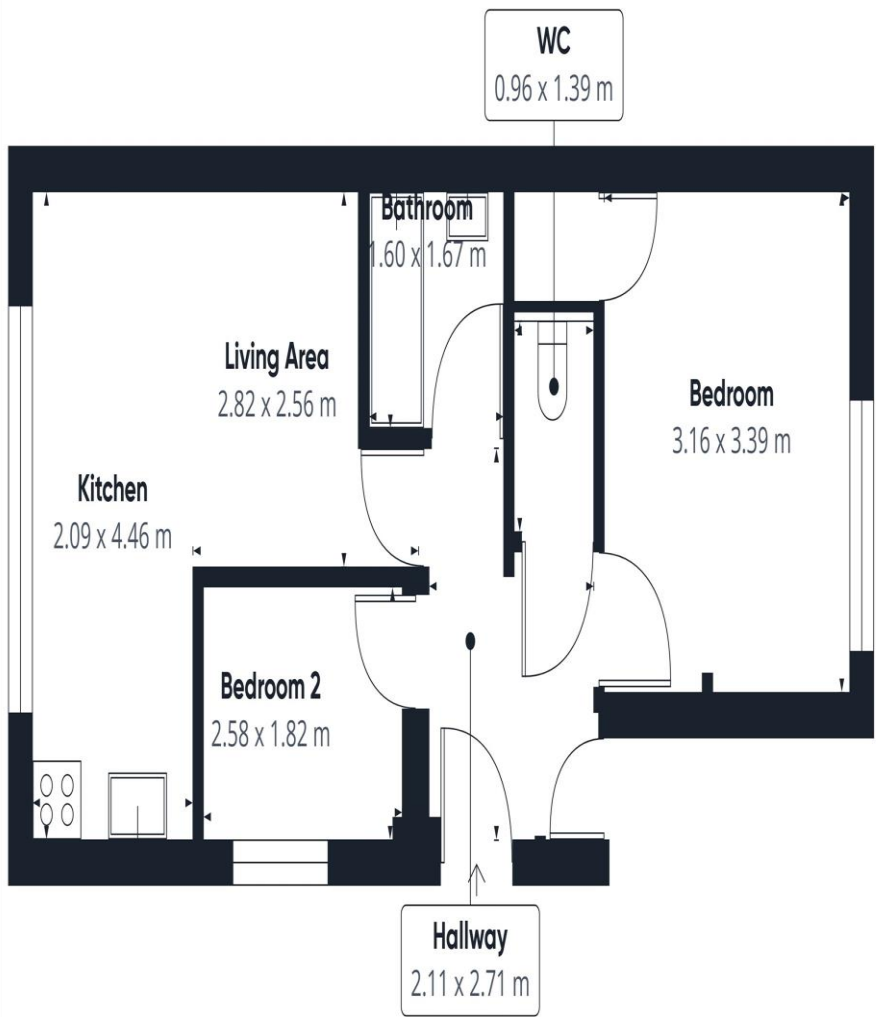

Approximate total area⁽¹⁾
41.53 m²

(1) Excluding balconies and terraces

While every attempt has been made to ensure accuracy, all measurements are approximate, not to scale. This floor plan is for illustrative purposes only.

GIRAFFE 360



welcome to

The Lodge Leigham Court Road, London

- Two Double Bedrooms
- Chain Free
- Long Lease
- Private Gated Development
- Close To Transport Links

Tenure: Leasehold EPC Rating: D

This is a Leasehold property. We are awaiting further details about the Term of the lease. For further information please contact the branch. Please note additional fees could be incurred for items such as Leasehold packs.

£325,000



Please note the marker reflects the postcode not the actual property

check out more properties at [barnardmarcus.co.uk](https://www.barnardmarcus.co.uk)



Property Ref:
STM109546 - 0002

1. MONEY LAUNDERING REGULATIONS Intending purchasers will be asked to produce identification documentation at a later stage and we would ask for your co-operation in order that there is no delay in agreeing the sale. 2. These particulars do not constitute part or all of an offer or contract. 3. The measurements indicated are supplied for guidance only and as such must be considered incorrect. Potential buyers are advised to recheck measurements before committing to any expense. 4. We have not tested any apparatus, equipment, fixtures or services and it is in the buyers interest to check the working condition of any appliances. 5. Where an EPC, or a Home Report (Scotland only) is held for this property, it is available for inspection at the branch by appointment. If you require a printed version of a Home Report, you will need to pay a reasonable production charge reflecting printing and other costs. 6. We are not able to offer an opinion either written or verbal on the content of these reports and this must be obtained from your legal representative. 7. Whilst we take care in preparing these reports, a buyer should ensure that his/her legal representative confirms as soon as possible all matters relating to title including the extent and boundaries of the property and other important matters before exchange of contracts.



020 8769 9393



Streatham@barnardmarcus.co.uk



120 Mitcham Lane, Streatham, London, SW16 6NS



[barnardmarcus.co.uk](https://www.barnardmarcus.co.uk)