



**Waterford Place, Normanton WF6 1RJ**

**welcome to**

**Waterford Place, Normanton**

Thinking of making a move? At a Guide Price of £250,000 - £260,000 this FOUR BEDROOM home could be RIGHT UP YOUR STREET! Set over three floors, this well presented end town house offers fantastic living accommodation throughout which includes THREE BATHROOMS, a UTILITY ROOM plus a GARAGE & Garden!





## Ground Floor

### Entrance Hall

Having the entrance door to the front aspect, a gas central heating radiator, useful under stair storage cupboard, a door to the garage and stairs to the first floor landing.

### Utility Room

Equipped with wall units, a work surfaces, plumbing for a washing machine and a gas central heating radiator.

### Shower Room

Fitted with a shower cubicle, a wash hand basin and a low level flush w.c, plus a heated towel rail.

### Bedroom Two

9' 7" max x 11' 3" max ( 2.92m max x 3.43m max )  
With double glazed French doors leading out to the rear garden, and a gas central heating radiator.

## First Floor

### Open Plan Living Kitchen

15' 3" max x 26' 6" max ( 4.65m max x 8.08m max )  
Comprising of a modern fitted kitchen with a range of both wall and base units with complimentary work surfaces over. Includes an electric oven with integrated microwave, an induction hob and a cooker hood unit over. Also includes a one and a half bowl sink and drainer, a breakfast bar seating area, two double glazed windows to the rear and a gas central heating radiator.

The lounge area includes a double glazed window to the front aspect and a gas central heating radiator.

## Second Floor

### Bedroom One

13' 7" max x 15' 5" max ( 4.14m max x 4.70m max )  
Featuring a double glazed window to the front aspect, a built in storage cupboard housing the hot water tank, and a door to the en-suite.

### En-Suite

Consisting of a shower cubicle, a wash hand basin set within a vanity storage unit, and a low level flush w.c. Also has a heated towel rail and a double glazed window to the front.

### Bedroom Three

11' 5" max x 8' 6" max ( 3.48m max x 2.59m max )  
Double glazed window to the rear and a gas central heating radiator.

### Bedroom Four

6' 5" max x 7' 4" max ( 1.96m max x 2.24m max )  
Double glazed window to the rear and a gas central heating radiator.

### House Bathroom

Fitted with a three piece bathroom suite which includes a white panel bath, a wash hand basin and the low level flush w.c. Also has a heated towel rail and part tiled walls.

### Exterior

Externally the property has a buffer garden to the front aspect, with a driveway and access to the side.

To the rear is an enclosed garden space with a patio seating area, an artificial lawn and both wall and fenced boundaries.



**view this property online** [williamhbrown.co.uk/Property/CAF113159](http://williamhbrown.co.uk/Property/CAF113159)



welcome to

## Waterford Place, Normanton

- Guide Price £250,000 - £260,000
- Modern End Town House
- Accommodation Over Three Floors
- Four Bedrooms
- En-Suite, Shower Room & Family Bathroom

Tenure: Freehold EPC Rating: C

guide price

**£250,000 - £260,000**

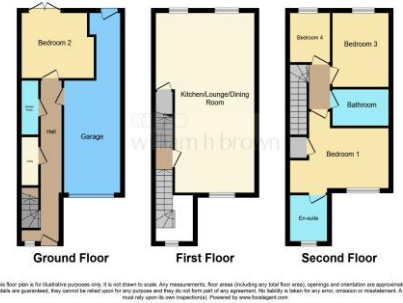

**view this property online** [williamhbrown.co.uk/Property/CAF113159](http://williamhbrown.co.uk/Property/CAF113159)

Please note the marker reflects the postcode not the actual property



Property Ref:  
CAF113159 - 0002

1. MONEY LAUNDERING REGULATIONS Intending purchasers will be asked to produce identification documentation at a later stage and we would ask for your co-operation in order that there is no delay in agreeing the sale. 2. These particulars do not constitute part or all of an offer or contract. 3. The measurements indicated are supplied for guidance only and as such must be considered incorrect. Potential buyers are advised to recheck measurements before committing to any expense. 4. We have not tested any apparatus, equipment, fixtures or services and it is in the buyers interest to check the working condition of any appliances. 5. Where an EPC, or a Home Report (Scotland only) is held for this property, it is available for inspection at the branch by appointment. If you require a printed version of a Home Report, you will need to pay a reasonable production charge reflecting printing and other costs. 6. We are not able to offer an opinion either written or verbal on the content of these reports and this must be obtained from your legal representative. 7. Whilst we take care in preparing these reports, a buyer should ensure that his/her legal representative confirms as soon as possible all matters relating to title including the extent and boundaries of the property and other important matters before exchange of contracts.

William H Brown is a trading name of Sequence (UK) Limited which is registered in England and Wales under company number 4268443, Registered Office is Cumbria House, 16-20 Hockliffe Street, Leighton Buzzard, Bedfordshire, LU7 1GN. VAT Registration Number is 500 2481 05.



william h brown



**01977 512628**



[castleford@williamhbrown.co.uk](mailto:castleford@williamhbrown.co.uk)



10 Bank Street, CASTLEFORD, West Yorkshire,  
WF10 1HZ



[williamhbrown.co.uk](http://williamhbrown.co.uk)