



**PORTFOLIO**  
from

 **barnard marcus**

Jephtha Villas, Jephtha Road, Southfields, SW18 1QH



# Jephtha Villas, Jephtha Road, Southfields, SW18 1QH

*Welcome to 1 Jephtha Villas—a rarely available and beautifully restored Victorian residence offering a perfect balance of period charm and cutting-edge contemporary living.*



A meticulously renovated 3-bedroom Victorian home in the heart of prime SW18.

Welcome to 1 Jephtha Villas—a rarely available and beautifully restored Victorian residence offering a perfect balance of period charm and cutting-edge contemporary living. Situated over three floors on a peaceful residential street in the highly sought after SW18 area of London, this stunning three-bedroom, two-bathroom home has been reimagined to an exceptional standard by London Heritage Properties, a developer renowned for their sympathetic restorations of London's architectural heritage with a focus on performance, comfort and finish. Located just a 16-minute walk to Southfields Underground Station (District Line), residents enjoy direct access to Wimbledon Station in 6 minutes and Earl's Court in just 14 minutes, making this an ideal location for commuters. The home is also within easy reach of Ofsted Outstanding local schools and a selection of prestigious private schools, as well as a range of boutique shops, cafes, and green spaces.



This elegant home boasts the following superior features:

- Three spacious bedrooms, ideal for families or professionals
- Two luxurious bathrooms with premium fittings and underfloor heating
- A stylish open-plan kitchen and living space, flooded with natural light and finished with bespoke cabinetry, quartz worktops, and integrated appliances
- Ample built-in storage
- A private garden, perfect for entertaining or relaxing
- Underfloor Heating (Ground Floor) - Providing even and comfortable radiant heat across all ground floor areas, eliminating the need for radiators and enhancing the layout and design of living spaces.
- A high-efficiency air-source heat pump - offering year-round comfort and energy savings
- Integrated Air Conditioning System (Cooling & Heating) - A fully concealed, ducted air conditioning system provides both cooling and heating to all principal rooms. Zone-controlled for maximum efficiency, this system allows each area of the home to be set at a desired temperature year-round — offering ideal climate comfort in both summer and winter.
- Mist Fire Suppression System - Installed at ground floor level and the first floor landing, this system offers enhanced fire safety without compromising ceiling height or aesthetics — providing peace of mind with discreet integration.
- Superior Soundproofing & Insulation All floors, walls, and party structures are built to exceed standard regulations, creating a quiet, energy-efficient environment inside the home.
- On-street parking and excellent local transport connections





About the Developer – London Heritage Properties.

London Heritage Properties is an award-winning boutique developer known for reviving London's architectural legacy with integrity, innovation, and craftsmanship with over 25 years experience.

Led by Edward Church, a trained architect with a background in conservation and listed property work, the company brings together thoughtful design and modern construction expertise, specialising in retaining the architectural character of London's historic housing stock while rebuilding behind original façades using modern construction methods.

With over 170 completed homes, the company has a reputation for attention to detail with every home thoughtfully restored or created to reflect the unique character of its location, while integrating the latest in modern sustainability and design.

1 Jephtha Villas offers a rare opportunity to own a piece of history—reborn for modern living. Early viewing is highly recommended.





## JEPHTHA ROAD

APPROXIMATE GROSS INTERNAL FLOOR AREA: 1281 SQ FT - 119.03 SQ M

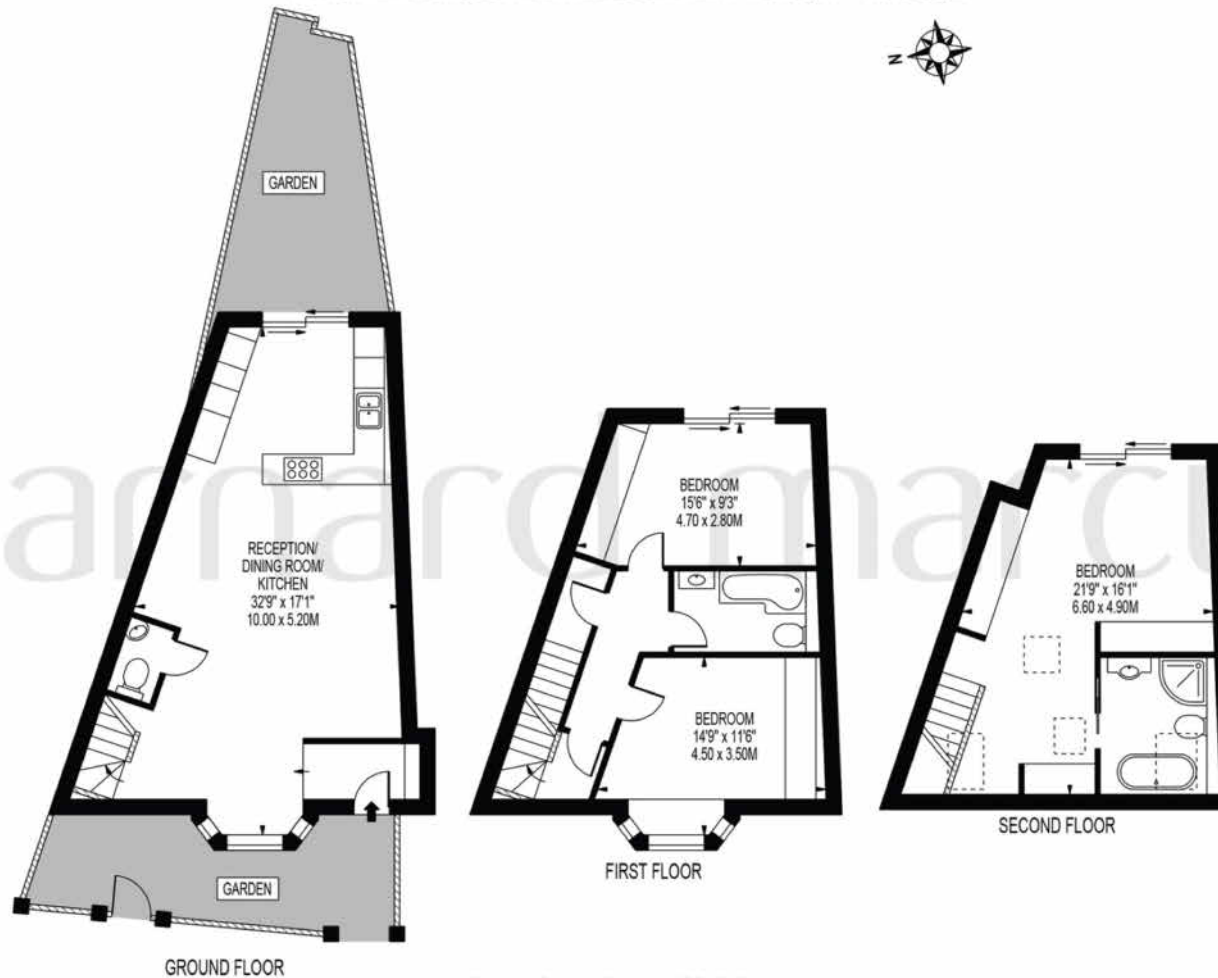

FOR ILLUSTRATION PURPOSES ONLY

THIS FLOOR PLAN SHOULD BE USED AS A GENERAL OUTLINE FOR GUIDANCE ONLY AND DOES NOT CONSTITUTE IN WHOLE OR IN PART AN OFFER OR CONTRACT.  
ANY INTENDING PURCHASER OR LESSEE SHOULD SATISFY THEMSELVES BY INSPECTION, SEARCHES, ENQUIRIES AND FULL SURVEY AS TO THE CORRECTNESS OF EACH STATEMENT.  
ANY AREAS, MEASUREMENTS OR DISTANCES QUOTED ARE APPROXIMATE AND SHOULD NOT BE USED TO VALUE A PROPERTY OR BE THE BASIS OF ANY SALE OR LET.

# welcome to

## Jephtha Villas, Jephtha Road, Southfields, SW18 1QH

A meticulously renovated 3-bedroom Victorian home in the heart of prime SW18. A rarely available restored Victorian residence offering a perfect balance of period charm and cutting-edge contemporary living by renowned developer London Heritage Properties.

Properties.

Price

# £1,395,000

- Meticulously renovated Victorian Home
- High contemporary specification
- Prime SW18 location with parking available
- Energy Efficient - with ASHP, Airconditioning & Ground floor underfloor heating

EPC Rating: D

Council Tax Band: F

Tenure: Freehold

**PORTFOLIO**  
from

  
barnard marcus



To find out more information or to arrange a viewing call

# 020 8874 4106

or email [Southfields@barnardmarcus.co.uk](mailto:Southfields@barnardmarcus.co.uk)

245 Wimbledon Park Road, Southfields, London SW18 5RJ

[barnardmarcus.co.uk](http://barnardmarcus.co.uk)

1. MONEY LAUNDERING REGULATIONS Intending purchasers will be asked to produce identification documentation at a later stage and we would ask for your co-operation in order that there is no delay in agreeing the sale. 2. These particulars do not constitute part or all of an offer or contract. 3. The measurements indicated are supplied for guidance only and as such must be considered incorrect. Potential buyers are advised to recheck measurements before committing to any expense. 4. We have not tested any apparatus, equipment, fixtures or services and it is in the buyers interest to check the working condition of any appliances. 5. Where an EPC, or a Home Report (Scotland only) is held for this property, it is available for inspection at the branch by appointment. If you require a printed version of a Home Report, you will need to pay a reasonable production charge reflecting printing and other costs. 6. We are not able to offer an opinion either written or verbal on the content of these reports and this must be obtained from your legal representative. 7. Whilst we take care in preparing these reports, a buyer should ensure that his/her legal representative confirms as soon as possible all matters relating to title including the extent and boundaries of the property and other important matters before exchange of contracts.

Trading name of Sequence (UK) Limited which is registered in England and Wales under company number 4268443, Registered Office is Cumbria House, 16-20 Hockliffe Street, Leighton Buzzard, Bedfordshire, LU7 1GN. VAT Registration Number is 500 2481 05.

