



Moselle Avenue, LONDON N22 6EY

welcome to

Moselle Avenue, LONDON

This delightful one bedroom garden flat occupies the ground floor of a pretty character house located on the sought-after Noel Park Development, conveniently situated to the North East of Wood Green. The flat offers well-proportioned living and bedroom, a spacious kitchen, and a 50' private garden, and is priced to reflect the opportunity to update.

The Noel Park Conservation Area is an attractive collection of period homes planned and developed by The Artisans, Labourers and General Dwellings Company circa 1881 to 1913. The houses were designed to house the families of artisans, skilled workers and labourers in fashionable cottage style dwellings. The area still retains its homogenous and distinguished appearance today and was designated as a conservation area in 1982 in recognition of its special architectural and historic significance and to preserve and enhance its character and appearance.

A peaceful and convenient location, there's a choice of good nurseries and Noel Park Primary School is rated Outstanding by Ofsted. Wood Green Underground Station (Piccadilly Line Zone 3) is within just 5 minutes' walking distance. There's lots of green space nearby; Russell Park and Belmont Park, Downhills Park and Lordship Rec are all within a few minutes' walk. The Hub at Lordship Rec offers a range of community activities like yoga and children's clubs, and Alexandra Palace is good for walks, concerts, the newly reopened theatre and the farmers' market on Sundays.



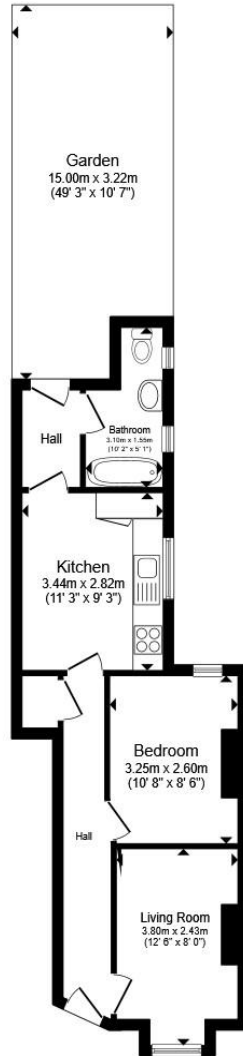

Total floor area 41.0 m² (442 sq.ft.) approx

This floor plan is for illustrative purposes only. It is not drawn to scale. Any measurements, floor areas (including any total floor area), openings and orientation are approximate. No details are guaranteed, they cannot be relied upon for any purpose and they do not form part of any agreement. No liability is taken for any error, omission or misstatement. A party must rely upon its own inspection(s). Powered by www.propertybox.io

welcome to

Moselle Avenue, LONDON

- Ground floor flat
- Period conversation
- Private garden
- Noel Park Conservation Area
- Priced to reflect opportunity to update.

Tenure: Leasehold EPC Rating: F

Council Tax Band: A Service Charge: £876.00

Ground Rent: 10.00

This is a Leasehold property with details as follows; Term of Lease 125 years from 30 Nov 1998. Should you require further information please contact the branch. Please Note additional fees could be incurred for items such as Leasehold packs.

£300,000



Please note the marker reflects the postcode not the actual property

check out more properties at barnardmarcus.co.uk



Property Ref:
MUH106298 - 0002

1. MONEY LAUNDERING REGULATIONS Intending purchasers will be asked to produce identification documentation at a later stage and we would ask for your co-operation in order that there is no delay in agreeing the sale. 2. These particulars do not constitute part or all of an offer or contract. 3. The measurements indicated are supplied for guidance only and as such must be considered incorrect. Potential buyers are advised to recheck measurements before committing to any expense. 4. We have not tested any apparatus, equipment, fixtures or services and it is in the buyers interest to check the working condition of any appliances. 5. Where an EPC, or a Home Report (Scotland only) is held for this property, it is available for inspection at the branch by appointment. If you require a printed version of a Home Report, you will need to pay a reasonable production charge reflecting printing and other costs. 6. We are not able to offer an opinion either written or verbal on the content of these reports and this must be obtained from your legal representative. 7. Whilst we take care in preparing these reports, a buyer should ensure that his/her legal representative confirms as soon as possible all matters relating to title including the extent and boundaries of the property and other important matters before exchange of contracts.

Barnard Marcus is a trading name of Sequence (UK) Limited which is registered in England and Wales under company number 4268443, Registered Office is Cumbria House, 16-20 Hockliffe Street, Leighton Buzzard, Bedfordshire, LU7 1GN. VAT Registration Number is 500 2481 05.



barnard marcus



020 8444 4215



MuswellHill@barnardmarcus.co.uk



262 Muswell Hill Broadway, Muswell Hill,
London, N10 3SH



barnardmarcus.co.uk