



**Lewes Court Chatsworth Place, Mitcham CR4 4NG**



**welcome to**

**Lewes Court Chatsworth Place, Mitcham**

**\*\*\*WARDEN ASSISTED | OVER 55's  
APARTMENT\*\*\***

A spacious and well maintained TWO Bedroom ground floor RETIREMENT apartment built CIRCA 1987 and available with NO ONWARD CHAIN. The property is located in the HEART of Mitcham town centre just off the London Road near to the Cricket green.

The property comprises SPACIOUS reception room, modern fully fitted kitchen, two bedrooms, double glazing, electric storage heating and modern Wet room/shower. Other features include lift service and communal areas.

The development has the benefit of a communal lounge with regular events for the residents scheduled during the week.

The property is bought with a 70% share ownership with the remaining 30% being retained by Optivo housing association.

Viewing's are a MUST!



# LEWES COURT

APPROXIMATE GROSS INTERNAL FLOOR AREA: 602 SQ FT - 55.94 SQ M

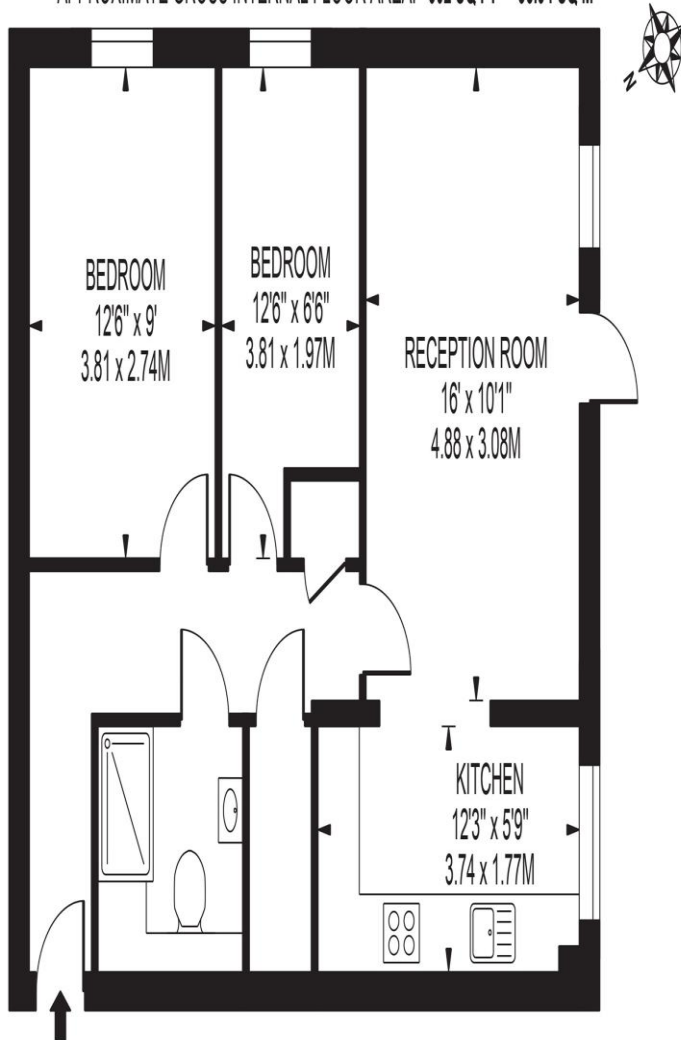

FOR ILLUSTRATION PURPOSES ONLY

THIS FLOOR PLAN SHOULD BE USED AS A GENERAL OUTLINE FOR GUIDANCE ONLY AND DOES NOT CONSTITUTE IN WHOLE OR IN PART AN OFFER OR CONTRACT.  
ANY INTENDING PURCHASER OR LESSEE SHOULD SATISFY THEMSELVES BY INSPECTION, SEARCHES, ENQUIRIES AND FULL SURVEY AS TO THE CORRECTNESS OF EACH STATEMENT.  
ANY AREAS, MEASUREMENTS OR DISTANCES QUOTED ARE APPROXIMATE AND SHOULD NOT BE USED TO VALUE A PROPERTY OR BE THE BASIS OF ANY SALE OR LET.



welcome to

## Lewes Court Chatsworth Place, Mitcham

- Chain free
- over 55s only
- Retirement home
- Good condition
- Town centre locations

Tenure: Leasehold EPC Rating: C

This is a Leasehold property. We are awaiting further details about the Term of the lease. For further information please contact the branch. Please note additional fees could be incurred for items such as Leasehold packs.

# £160,000



Please note the marker reflects the postcode not the actual property

[view this property online](https://www.barnardmarcus.co.uk/Property/MTM109110) barnardmarcus.co.uk/Property/MTM109110



Property Ref:  
MTM109110 - 0002

1. MONEY LAUNDERING REGULATIONS Intending purchasers will be asked to produce identification documentation at a later stage and we would ask for your co-operation in order that there is no delay in agreeing the sale. 2. These particulars do not constitute part or all of an offer or contract. 3. The measurements indicated are supplied for guidance only and as such must be considered incorrect. Potential buyers are advised to recheck measurements before committing to any expense. 4. We have not tested any apparatus, equipment, fixtures or services and it is in the buyers interest to check the working condition of any appliances. 5. Where an EPC, or a Home Report (Scotland only) is held for this property, it is available for inspection at the branch by appointment. If you require a printed version of a Home Report, you will need to pay a reasonable production charge reflecting printing and other costs. 6. We are not able to offer an opinion either written or verbal on the content of these reports and this must be obtained from your legal representative. 7. Whilst we take care in preparing these reports, a buyer should ensure that his/her legal representative confirms as soon as possible all matters relating to title including the extent and boundaries of the property and other important matters before exchange of contracts.

Barnard Marcus is a trading name of Sequence (UK) Limited which is registered in England and Wales under company number 4268443, Registered Office is Cumbria House, 16-20 Hockliffe Street, Leighton Buzzard, Bedfordshire, LU7 1GN. VAT Registration Number is 500 2481 05.

  
barnard marcus



**020 8646 1616**



Mitcham@barnardmarcus.co.uk



1 Langdale Parade, Upper Green East,  
MITCHAM, Surrey, CR4 2PF



**barnardmarcus.co.uk**