



Felton Close, Broxbourne EN10 6BT

welcome to

Felton Close, Broxbourne

William H Brown are pleased to bring to the market this lovely three bedroom family home situated in a popular residential location, with allocated parking. An early viewing is a must to see how nice this house is!

Accommodation Comprises Of:

Lounge

15' 2" x 14' 7" (4.62m x 4.45m)

Double glazed window to front aspect, laminate floor, radiator.

Kitchen

14' 8" x 12' 2" (4.47m x 3.71m)

Double glazed window to rear aspect, double glazed door to rear aspect, a range of wall and base units with complimenting worktops, integrated oven, hob, extractor fan, tiled floor.

Landing

Double glazed window to side aspect, radiator, storage cupboard.

Bedroom 1

12' 7" x 8' 1" (3.84m x 2.46m)

Double glazed window to rear aspect, radiator, storage cupboard.

Bedroom 2

15' 2" x 8' 1" (4.62m x 2.46m)

Double glazed window to front aspect, fitted wardrobe, radiator.

Bedroom 3

9' 6" x 6' 4" (2.90m x 1.93m)

Double glazed window to front aspect, radiator.

Exterior

Rear Garden

To the rear of the property is a lawn area, patio area, side access, shed.





view this property online williamhbrown.co.uk/Property/BRX109409



welcome to

Felton Close, Broxbourne

- Three good sized bedrooms
- End of terrace
- Popular location
- Close to local schools and transport links
- Allocated parking

Tenure: Freehold EPC Rating: D

Council Tax Band: D

offers in excess of

£435,000

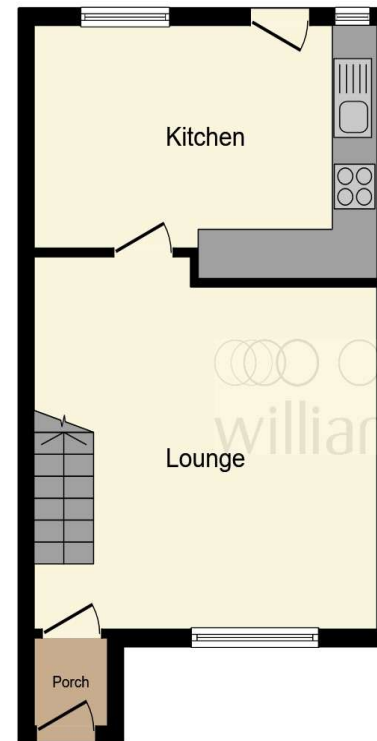

Ground Floor

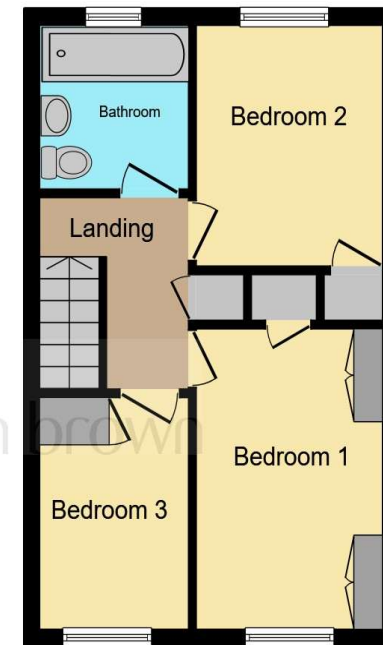

First Floor

Total floor area 69.0 m² (743 sq.ft.) approx

This floor plan is for illustrative purposes only. It is not drawn to scale. Any measurements, floor areas (including any total floor area), openings and orientation are approximate. No details are guaranteed, they cannot be relied upon for any purpose and they do not form part of any agreement. No liability is taken for any error, omission or misstatement. A party must rely upon its own inspection(s). Powered by www.focalagent.com

view this property online williamhbrown.co.uk/Property/BRX109409



Property Ref:
BRX109409 - 0003

1. MONEY LAUNDERING REGULATIONS Intending purchasers will be asked to produce identification documentation at a later stage and we would ask for your co-operation in order that there is no delay in agreeing the sale. 2. These particulars do not constitute part or all of an offer or contract. 3. The measurements indicated are supplied for guidance only and as such must be considered incorrect. Potential buyers are advised to recheck measurements before committing to any expense. 4. We have not tested any apparatus, equipment, fixtures or services and it is in the buyers interest to check the working condition of any appliances. 5. Where an EPC, or a Home Report (Scotland only) is held for this property, it is available for inspection at the branch by appointment. If you require a printed version of a Home Report, you will need to pay a reasonable production charge reflecting printing and other costs. 6. We are not able to offer an opinion either written or verbal on the content of these reports and this must be obtained from your legal representative. 7. Whilst we take care in preparing these reports, a buyer should ensure that his/her legal representative confirms as soon as possible all matters relating to title including the extent and boundaries of the property and other important matters before exchange of contracts.

William H Brown is a trading name of Sequence (UK) Limited which is registered in England and Wales under company number 4268443, Registered Office is Cumbria House, 16-20 Hockliffe Street, Leighton Buzzard, Bedfordshire, LU7 1GN. VAT Registration Number is 500 2481 05.

william h brown



01992 464174



Broxbourne@williamhbrown.co.uk



47 High Road, BROXBOURNE, Hertfordshire,
EN10 7HX



williamhbrown.co.uk



Felton Close, Broxbourne EN10 6BT

welcome to

Felton Close, Broxbourne

William H Brown are pleased to bring to the market this lovely three bedroom family home situated in a popular residential location, with allocated parking. An early viewing is a must to see how nice this house is!

Accommodation Comprises Of:

Lounge

15' 2" x 14' 7" (4.62m x 4.45m)

Double glazed window to front aspect, laminate floor, radiator.

Kitchen

14' 8" x 12' 2" (4.47m x 3.71m)

Double glazed window to rear aspect, double glazed door to rear aspect, a range of wall and base units with complimenting worktops, integrated oven, hob, extractor fan, tiled floor.

Landing

Double glazed window to side aspect, radiator, storage cupboard.

Bedroom 1

12' 7" x 8' 1" (3.84m x 2.46m)

Double glazed window to rear aspect, radiator, storage cupboard.

Bedroom 2

15' 2" x 8' 1" (4.62m x 2.46m)

Double glazed window to front aspect, fitted wardrobe, radiator.

Bedroom 3

9' 6" x 6' 4" (2.90m x 1.93m)

Double glazed window to front aspect, radiator.

Exterior

Rear Garden

To the rear of the property is a lawn area, patio area, side access, shed.





view this property online williamhbrown.co.uk/Property/BRX109409



welcome to

Felton Close, Broxbourne

- Three good sized bedrooms
- End of terrace
- Popular location
- Close to local schools and transport links
- Allocated parking

Tenure: Freehold EPC Rating: D

Council Tax Band: D

offers in excess of

£435,000

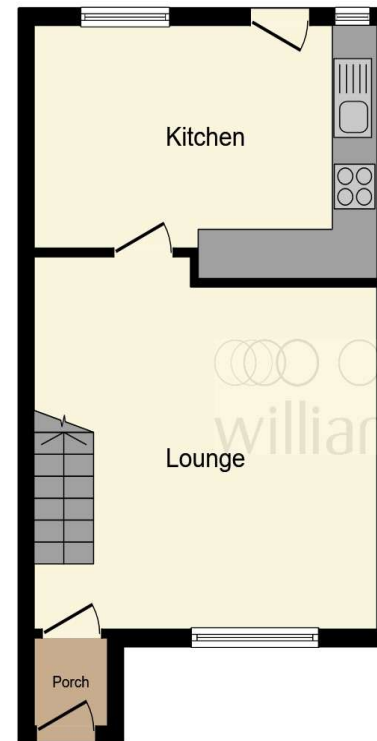

Ground Floor

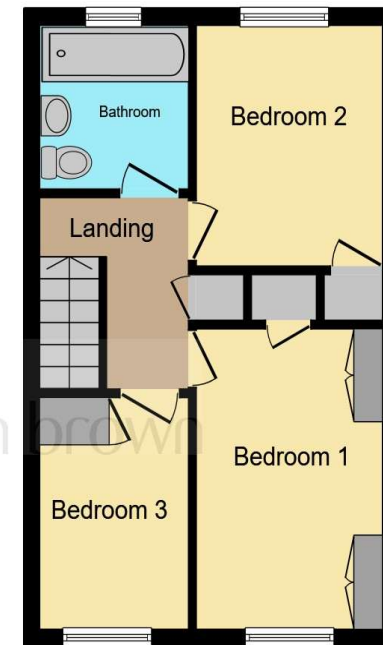

First Floor

Total floor area 69.0 m² (743 sq.ft.) approx

This floor plan is for illustrative purposes only. It is not drawn to scale. Any measurements, floor areas (including any total floor area), openings and orientation are approximate. No details are guaranteed, they cannot be relied upon for any purpose and they do not form part of any agreement. No liability is taken for any error, omission or misstatement. A party must rely upon its own inspection(s). Powered by www.focalagent.com

view this property online williamhbrown.co.uk/Property/BRX109409



Property Ref:
BRX109409 - 0003

1. MONEY LAUNDERING REGULATIONS Intending purchasers will be asked to produce identification documentation at a later stage and we would ask for your co-operation in order that there is no delay in agreeing the sale. 2. These particulars do not constitute part or all of an offer or contract. 3. The measurements indicated are supplied for guidance only and as such must be considered incorrect. Potential buyers are advised to recheck measurements before committing to any expense. 4. We have not tested any apparatus, equipment, fixtures or services and it is in the buyers interest to check the working condition of any appliances. 5. Where an EPC, or a Home Report (Scotland only) is held for this property, it is available for inspection at the branch by appointment. If you require a printed version of a Home Report, you will need to pay a reasonable production charge reflecting printing and other costs. 6. We are not able to offer an opinion either written or verbal on the content of these reports and this must be obtained from your legal representative. 7. Whilst we take care in preparing these reports, a buyer should ensure that his/her legal representative confirms as soon as possible all matters relating to title including the extent and boundaries of the property and other important matters before exchange of contracts.

William H Brown is a trading name of Sequence (UK) Limited which is registered in England and Wales under company number 4268443, Registered Office is Cumbria House, 16-20 Hockliffe Street, Leighton Buzzard, Bedfordshire, LU7 1GN. VAT Registration Number is 500 2481 05.

william h brown



01992 464174



Broxbourne@williamhbrown.co.uk



47 High Road, BROXBOURNE, Hertfordshire,
EN10 7HX



williamhbrown.co.uk



Felton Close, Broxbourne EN10 6BT

welcome to

Felton Close, Broxbourne

William H Brown are pleased to bring to the market this lovely three bedroom family home situated in a popular residential location, with allocated parking. An early viewing is a must to see how nice this house is!

Accommodation Comprises Of:

Lounge

15' 2" x 14' 7" (4.62m x 4.45m)

Double glazed window to front aspect, laminate floor, radiator.

Kitchen

14' 8" x 12' 2" (4.47m x 3.71m)

Double glazed window to rear aspect, double glazed door to rear aspect, a range of wall and base units with complimenting worktops, integrated oven, hob, extractor fan, tiled floor.

Landing

Double glazed window to side aspect, radiator, storage cupboard.

Bedroom 1

12' 7" x 8' 1" (3.84m x 2.46m)

Double glazed window to rear aspect, radiator, storage cupboard.

Bedroom 2

15' 2" x 8' 1" (4.62m x 2.46m)

Double glazed window to front aspect, fitted wardrobe, radiator.

Bedroom 3

9' 6" x 6' 4" (2.90m x 1.93m)

Double glazed window to front aspect, radiator.

Exterior

Rear Garden

To the rear of the property is a lawn area, patio area, side access, shed.





view this property online williamhbrown.co.uk/Property/BRX109409



welcome to

Felton Close, Broxbourne

- Three good sized bedrooms
- End of terrace
- Popular location
- Close to local schools and transport links
- Allocated parking

Tenure: Freehold EPC Rating: D

Council Tax Band: D

offers in excess of

£435,000

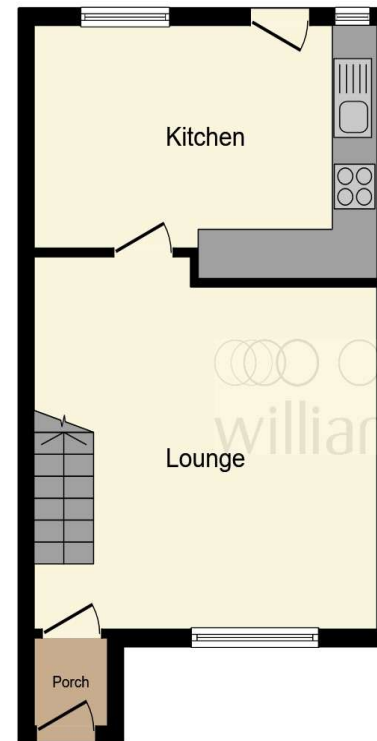

Ground Floor

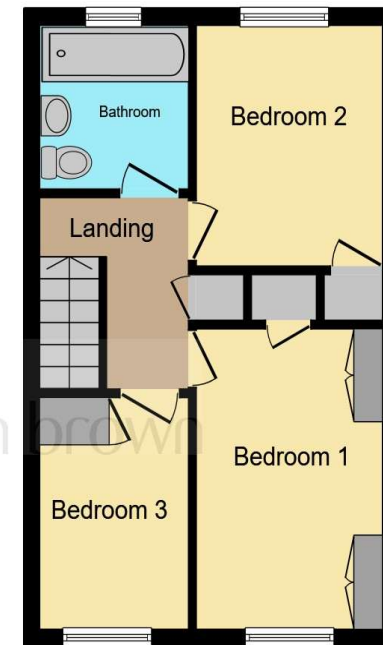

First Floor

Total floor area 69.0 m² (743 sq.ft.) approx

This floor plan is for illustrative purposes only. It is not drawn to scale. Any measurements, floor areas (including any total floor area), openings and orientation are approximate. No details are guaranteed, they cannot be relied upon for any purpose and they do not form part of any agreement. No liability is taken for any error, omission or misstatement. A party must rely upon its own inspection(s). Powered by www.focalagent.com

view this property online williamhbrown.co.uk/Property/BRX109409



Property Ref:
BRX109409 - 0003

1. MONEY LAUNDERING REGULATIONS Intending purchasers will be asked to produce identification documentation at a later stage and we would ask for your co-operation in order that there is no delay in agreeing the sale. 2. These particulars do not constitute part or all of an offer or contract. 3. The measurements indicated are supplied for guidance only and as such must be considered incorrect. Potential buyers are advised to recheck measurements before committing to any expense. 4. We have not tested any apparatus, equipment, fixtures or services and it is in the buyers interest to check the working condition of any appliances. 5. Where an EPC, or a Home Report (Scotland only) is held for this property, it is available for inspection at the branch by appointment. If you require a printed version of a Home Report, you will need to pay a reasonable production charge reflecting printing and other costs. 6. We are not able to offer an opinion either written or verbal on the content of these reports and this must be obtained from your legal representative. 7. Whilst we take care in preparing these reports, a buyer should ensure that his/her legal representative confirms as soon as possible all matters relating to title including the extent and boundaries of the property and other important matters before exchange of contracts.

William H Brown is a trading name of Sequence (UK) Limited which is registered in England and Wales under company number 4268443, Registered Office is Cumbria House, 16-20 Hockliffe Street, Leighton Buzzard, Bedfordshire, LU7 1GN. VAT Registration Number is 500 2481 05.

william h brown



01992 464174



Broxbourne@williamhbrown.co.uk



47 High Road, BROXBOURNE, Hertfordshire,
EN10 7HX



williamhbrown.co.uk



Felton Close, Broxbourne EN10 6BT

welcome to

Felton Close, Broxbourne

William H Brown are pleased to bring to the market this lovely three bedroom family home situated in a popular residential location, with allocated parking. An early viewing is a must to see how nice this house is!

Accommodation Comprises Of:

Lounge

15' 2" x 14' 7" (4.62m x 4.45m)

Double glazed window to front aspect, laminate floor, radiator.

Kitchen

14' 8" x 12' 2" (4.47m x 3.71m)

Double glazed window to rear aspect, double glazed door to rear aspect, a range of wall and base units with complimenting worktops, integrated oven, hob, extractor fan, tiled floor.

Landing

Double glazed window to side aspect, radiator, storage cupboard.

Bedroom 1

12' 7" x 8' 1" (3.84m x 2.46m)

Double glazed window to rear aspect, radiator, storage cupboard.

Bedroom 2

15' 2" x 8' 1" (4.62m x 2.46m)

Double glazed window to front aspect, fitted wardrobe, radiator.

Bedroom 3

9' 6" x 6' 4" (2.90m x 1.93m)

Double glazed window to front aspect, radiator.

Exterior

Rear Garden

To the rear of the property is a lawn area, patio area, side access, shed.





view this property online williamhbrown.co.uk/Property/BRX109409



welcome to

Felton Close, Broxbourne

- Three good sized bedrooms
- End of terrace
- Popular location
- Close to local schools and transport links
- Allocated parking

Tenure: Freehold EPC Rating: D

Council Tax Band: D

offers in excess of

£435,000

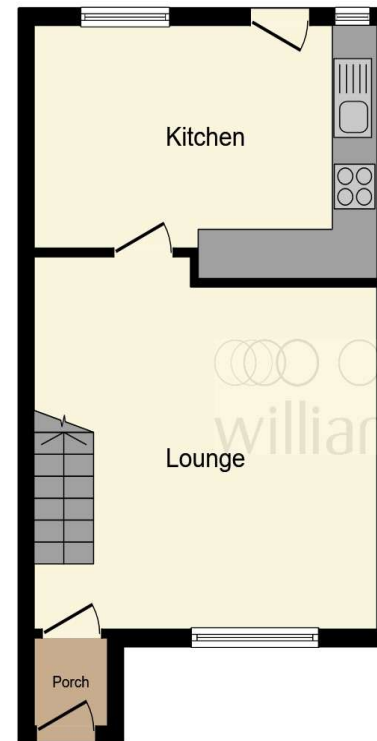

Ground Floor

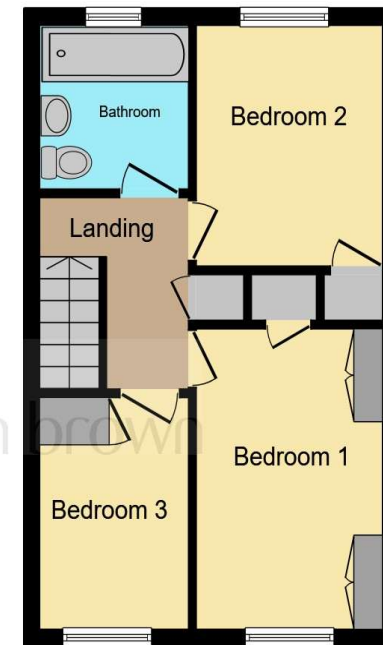

First Floor

Total floor area 69.0 m² (743 sq.ft.) approx

This floor plan is for illustrative purposes only. It is not drawn to scale. Any measurements, floor areas (including any total floor area), openings and orientation are approximate. No details are guaranteed, they cannot be relied upon for any purpose and they do not form part of any agreement. No liability is taken for any error, omission or misstatement. A party must rely upon its own inspection(s). Powered by www.focalagent.com

view this property online williamhbrown.co.uk/Property/BRX109409



Property Ref:
BRX109409 - 0003

1. MONEY LAUNDERING REGULATIONS Intending purchasers will be asked to produce identification documentation at a later stage and we would ask for your co-operation in order that there is no delay in agreeing the sale. 2. These particulars do not constitute part or all of an offer or contract. 3. The measurements indicated are supplied for guidance only and as such must be considered incorrect. Potential buyers are advised to recheck measurements before committing to any expense. 4. We have not tested any apparatus, equipment, fixtures or services and it is in the buyers interest to check the working condition of any appliances. 5. Where an EPC, or a Home Report (Scotland only) is held for this property, it is available for inspection at the branch by appointment. If you require a printed version of a Home Report, you will need to pay a reasonable production charge reflecting printing and other costs. 6. We are not able to offer an opinion either written or verbal on the content of these reports and this must be obtained from your legal representative. 7. Whilst we take care in preparing these reports, a buyer should ensure that his/her legal representative confirms as soon as possible all matters relating to title including the extent and boundaries of the property and other important matters before exchange of contracts.

William H Brown is a trading name of Sequence (UK) Limited which is registered in England and Wales under company number 4268443, Registered Office is Cumbria House, 16-20 Hockliffe Street, Leighton Buzzard, Bedfordshire, LU7 1GN. VAT Registration Number is 500 2481 05.

william h brown



01992 464174



Broxbourne@williamhbrown.co.uk



47 High Road, BROXBOURNE, Hertfordshire,
EN10 7HX



williamhbrown.co.uk



Felton Close, Broxbourne EN10 6BT

welcome to

Felton Close, Broxbourne

William H Brown are pleased to bring to the market this lovely three bedroom family home situated in a popular residential location, with allocated parking. An early viewing is a must to see how nice this house is!

Accommodation Comprises Of:

Lounge

15' 2" x 14' 7" (4.62m x 4.45m)

Double glazed window to front aspect, laminate floor, radiator.

Kitchen

14' 8" x 12' 2" (4.47m x 3.71m)

Double glazed window to rear aspect, double glazed door to rear aspect, a range of wall and base units with complimenting worktops, integrated oven, hob, extractor fan, tiled floor.

Landing

Double glazed window to side aspect, radiator, storage cupboard.

Bedroom 1

12' 7" x 8' 1" (3.84m x 2.46m)

Double glazed window to rear aspect, radiator, storage cupboard.

Bedroom 2

15' 2" x 8' 1" (4.62m x 2.46m)

Double glazed window to front aspect, fitted wardrobe, radiator.

Bedroom 3

9' 6" x 6' 4" (2.90m x 1.93m)

Double glazed window to front aspect, radiator.

Exterior

Rear Garden

To the rear of the property is a lawn area, patio area, side access, shed.





view this property online williamhbrown.co.uk/Property/BRX109409



welcome to

Felton Close, Broxbourne

- Three good sized bedrooms
- End of terrace
- Popular location
- Close to local schools and transport links
- Allocated parking

Tenure: Freehold EPC Rating: D

Council Tax Band: D

offers in excess of

£435,000

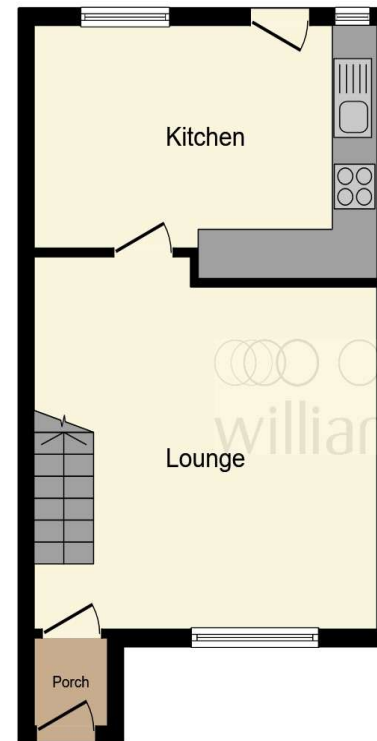

Ground Floor

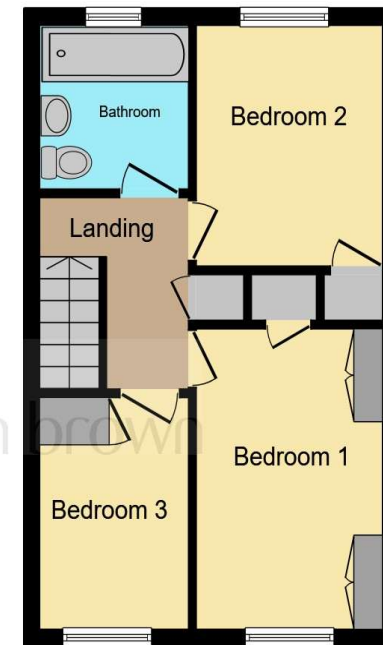

First Floor

Total floor area 69.0 m² (743 sq.ft.) approx

This floor plan is for illustrative purposes only. It is not drawn to scale. Any measurements, floor areas (including any total floor area), openings and orientation are approximate. No details are guaranteed, they cannot be relied upon for any purpose and they do not form part of any agreement. No liability is taken for any error, omission or misstatement. A party must rely upon its own inspection(s). Powered by www.focalagent.com

view this property online williamhbrown.co.uk/Property/BRX109409



Property Ref:
BRX109409 - 0003

1. MONEY LAUNDERING REGULATIONS Intending purchasers will be asked to produce identification documentation at a later stage and we would ask for your co-operation in order that there is no delay in agreeing the sale. 2. These particulars do not constitute part or all of an offer or contract. 3. The measurements indicated are supplied for guidance only and as such must be considered incorrect. Potential buyers are advised to recheck measurements before committing to any expense. 4. We have not tested any apparatus, equipment, fixtures or services and it is in the buyers interest to check the working condition of any appliances. 5. Where an EPC, or a Home Report (Scotland only) is held for this property, it is available for inspection at the branch by appointment. If you require a printed version of a Home Report, you will need to pay a reasonable production charge reflecting printing and other costs. 6. We are not able to offer an opinion either written or verbal on the content of these reports and this must be obtained from your legal representative. 7. Whilst we take care in preparing these reports, a buyer should ensure that his/her legal representative confirms as soon as possible all matters relating to title including the extent and boundaries of the property and other important matters before exchange of contracts.

William H Brown is a trading name of Sequence (UK) Limited which is registered in England and Wales under company number 4268443, Registered Office is Cumbria House, 16-20 Hockliffe Street, Leighton Buzzard, Bedfordshire, LU7 1GN. VAT Registration Number is 500 2481 05.



william h brown



01992 464174



Broxbourne@williamhbrown.co.uk



47 High Road, BROXBOURNE, Hertfordshire,
EN10 7HX



williamhbrown.co.uk