



West End, Northwold, Thetford, IP26 5LG

welcome to

West End, Northwold, Thetford

NO CHAIN! In the centre of a charming Norfolk village, this cottage is truly a must view! Offering a sense of charm and character throughout, a cosy lounge with feature woodburner, a double bedroom, sunny garden to rear, it's thought to make a fabulous first time or investment buy!

Summary

Located in the charming, peaceful and extremely sought after Norfolk village of Northwold, which has easy access to the local market towns of Brandon and Downham Market, both of which offer a wide range of amenities, including main train lines with direct links to Norwich, Cambridge and London King's Cross, is this charming end of terrace cottage.

The first thing you'll notice as you approach this property is the charm and kerb appeal it has, immediately making you want to go inside! Once there, you come into a welcoming and cosy lounge, with exposed beams and a feature woodburner, truly creating a relaxing feel as soon as you walk in! Further from this, there is also a modern kitchen, which then takes you out to the sunny rear garden.

Upstairs, you will find a double bedroom, with built in storage and a bathroom, creating a lovely space for those looking to buy their first home and get on the property ladder or invest and rent out!

Overall, viewing is essential to truly appreciate the charm and potential this cottage has!

The Accommodation

Entrance door to:

Living Room

15' 10" max. x 12' 5" (4.83m max. x 3.78m)
With door to front, under stairs storage cupboard, feature woodburner, TV point, electric heater, window to front and laminate flooring.

Kitchen

12' 8" x 6' 9" (3.86m x 2.06m)
With a range of wall and base units with work surface over, sink unit with mixer tap over, space and point for electric cooker, space and plumbing for washing machine, space for fridge/freezer window to rear and door to stairs, leading to the first floor landing.

Pantry

With consumer unit and window to rear.

First Floor Landing

With access to the loft space and window to rear.

Bedroom

13' x 7' 8" (3.96m x 2.34m)
With built in wardrobe, electric wall heater and window to front.

Bathroom

With W.C, wash hand basin with mixer tap over, panelled bath with electric power shower attachment over, heated towel rail and window to rear.

Outside

To the rear of the property is an enclosed rear garden with an initial patio area and steps up to a lawned area.





check out more properties at williamhbrown.co.uk



welcome to

West End, Northwold, Thetford

- Semi-Detached Cottage
- A Sense of Charm and Character Throughout
- Cosy Lounge with Feature Woodburner
- One Bedroom
- Sold with No Chain!
- In The Centre of a Popular Norfolk Village
- A Great First Time or Investment Buy
- Viewing Essential!

Tenure: Freehold EPC Rating: F

£180,000

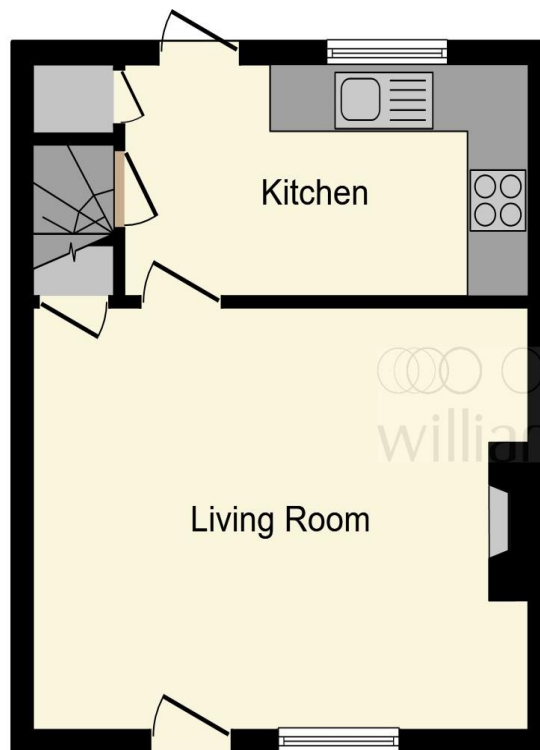

Ground Floor

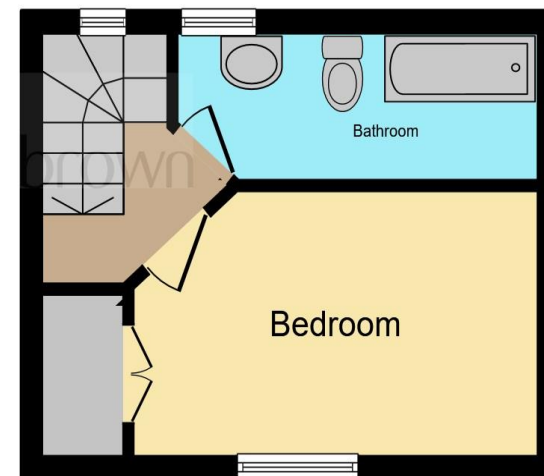

First Floor

This floor plan is for illustrative purposes only. It is not drawn to scale. Any measurements, floor areas (including any total floor area), openings and orientation are approximate. No details are guaranteed, they cannot be relied upon for any purpose and they do not form part of any agreement. No liability is taken for any error, omission or misstatement. A party must rely upon its own inspection(s). Powered by www.focalagent.com

check out more properties at williamhbrown.co.uk



Property Ref:
BRD109499 - 0001

1. MONEY LAUNDERING REGULATIONS Intending purchasers will be asked to produce identification documentation at a later stage and we would ask for your co-operation in order that there is no delay in agreeing the sale. 2. These particulars do not constitute part or all of an offer or contract. 3. The measurements indicated are supplied for guidance only and as such must be considered incorrect. Potential buyers are advised to recheck measurements before committing to any expense. 4. We have not tested any apparatus, equipment, fixtures or services and it is in the buyers interest to check the working condition of any appliances. 5. Where an EPC, or a Home Report (Scotland only) is held for this property, it is available for inspection at the branch by appointment. If you require a printed version of a Home Report, you will need to pay a reasonable production charge reflecting printing and other costs. 6. We are not able to offer an opinion either written or verbal on the content of these reports and this must be obtained from your legal representative. 7. Whilst we take care in preparing these reports, a buyer should ensure that his/her legal representative confirms as soon as possible all matters relating to title including the extent and boundaries of the property and other important matters before exchange of contracts.

William H Brown is a trading name of Sequence (UK) Limited which is registered in England and Wales under company number 4268443, Registered Office is Cumbria House, 16-20 Hockliffe Street, Leighton Buzzard, Bedfordshire, LU7 1GN. VAT Registration Number is 500 2481 05.

 william h brown



01842 811058



Brandon@williamhbrown.co.uk



18-20 High Street, BRANDON, Suffolk, IP27
0AQ



williamhbrown.co.uk