



Steerforth Street, London SW18 4HH

welcome to
Steerforth Street, London

A superb one/two bedroom ground floor period conversion, with sunny rear garden, located in the heart of Earlsfield.

The property benefits from contemporary, stylish decor throughout with wooden flooring and a wealth of character. Further benefits include a versatile layout, a large kitchen/reception room, good storage and a delightful, shared garden with an open aspect to the south-west and with side access. Furthermore, the property has a share of the freehold.

Set in this desirable location, Steerforth Street is a tree-lined residential street moments from Earlsfield mainline station and the popular coffee shops, bars and restaurants of Garratt Lane.

Viewing advised.



Steerforth Street, London, SW18

Approximate Area = 642 sq ft / 59.6 sq m

For identification only - Not to scale

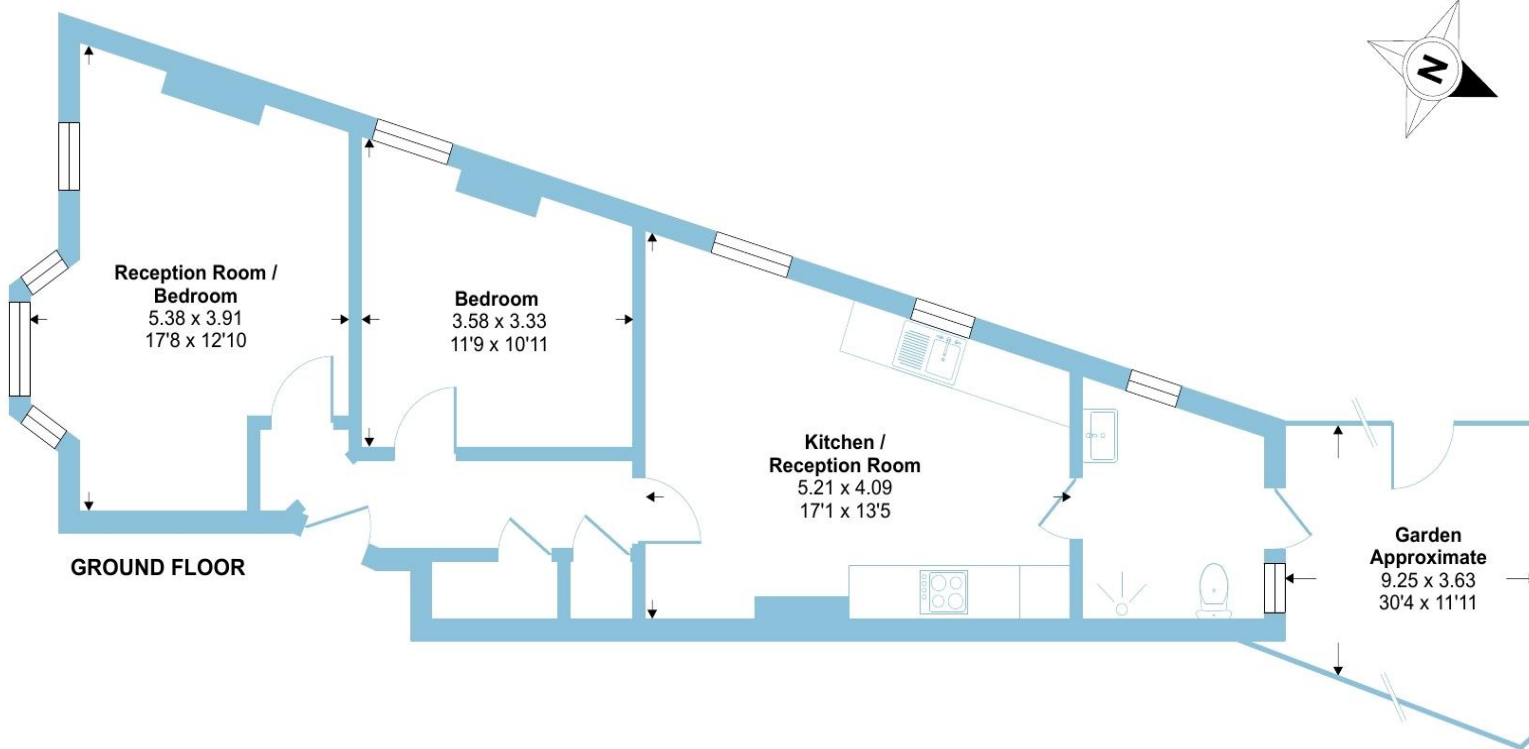

Floor plan produced in accordance with RICS Property Measurement Standards incorporating International Property Measurement Standards (IPMS2 Residential). © nchecon 2022. Produced for Barnard Marcus. REF: 842936



welcome to

Steerforth Street, London

- Superb Period One/Two Bedroom Ground Floor Flat
- Versatile layout
- Shared Garden with South-Westerly Aspect
- Share of Freehold
- Close to Earlsfield Mainline Station

Tenure: Leasehold EPC Rating: D

This is a Leasehold property with details as follows; Term of Lease 999 years from 25 Dec 2006. Should you require further information please contact the branch. Please Note additional fees could be incurred for items such as Leasehold packs.

guide price

£475,000



Please note the marker reflects the postcode not the actual property

view this property online [barnardmarcus.co.uk/Property/EAR104747](https://www.barnardmarcus.co.uk/Property/EAR104747)



Property Ref:
EAR104747 - 0005

1. MONEY LAUNDERING REGULATIONS Intending purchasers will be asked to produce identification documentation at a later stage and we would ask for your co-operation in order that there is no delay in agreeing the sale. 2. These particulars do not constitute part or all of an offer or contract. 3. The measurements indicated are supplied for guidance only and as such must be considered incorrect. Potential buyers are advised to recheck measurements before committing to any expense. 4. We have not tested any apparatus, equipment, fixtures or services and it is in the buyers interest to check the working condition of any appliances. 5. Where an EPC, or a Home Report (Scotland only) is held for this property, it is available for inspection at the branch by appointment. If you require a printed version of a Home Report, you will need to pay a reasonable production charge reflecting printing and other costs. 6. We are not able to offer an opinion either written or verbal on the content of these reports and this must be obtained from your legal representative. 7. Whilst we take care in preparing these reports, a buyer should ensure that his/her legal representative confirms as soon as possible all matters relating to title including the extent and boundaries of the property and other important matters before exchange of contracts.

Barnard Marcus is a trading name of Sequence (UK) Limited which is registered in England and Wales under company number 4268443, Registered Office is Cumbria House, 16-20 Hockliffe Street, Leighton Buzzard, Bedfordshire, LU7 1GN. VAT Registration Number is 500 2481 05.

barnard marcus



020 8879 7222



Earlsfield@barnardmarcus.co.uk



525 Garratt Lane, LONDON, SW18 4SR



[barnardmarcus.co.uk](https://www.barnardmarcus.co.uk)