



Kelso, Croft Lane, Marsham, Norwich, NR10 5PP

welcome to

Kelso, Croft Lane, Marham, Norwich

A substantial four double bedroom detached family home, set within the desirable village of Marham. The property offers generous and well-proportioned accommodation throughout, ideal for modern family living, and benefits from a pleasant setting within this sought-after location.



Description

Set on the edge of the popular village of Marsham is this individual detached residence which enjoys internal accommodation to include a larger than average Kitchen, useful Utility Room, Snug, double aspect Living Room, separate Dining Room & Cloakroom to the ground floor whilst upstairs offers 4 double Bedrooms - main with en-suite, and a Family Bathroom.

Outside enjoys ample parking, generous gardens and a spacious Garage with electric door. This property is well-presented and would benefit from some internal updating.

Marsham itself has a local pub "The Plough Inn" and lies approximately 2.1 miles from the historic Market Town of Aylsham, which has a variety of local amenities & transport links to the North Norfolk Coast & Norwich City Centre.

Entrance Hall

Front door opens into hall with stairs to first floor, coat cupboard, radiator and doors to Living Room, Dining Room, Kitchen & Cloakroom.

Cloakroom

Suite comprising low level WC & wash basin, half-tiled walls, vinyl flooring and double glazed window.

Living Room

Double aspect room with double glazed window to the front aspect and double glazed sliding door to the rear garden, fireplace with surround, wall lights, TV point and 2 radiators. Archway opens to Dining Room.

Dining Room

Radiator & rear aspect double glazed window.

Kitchen

Fitted with a range of wall & base units, wood effect work surface over with tiled splashback and sink & drainer unit with mixer tap. Double electric oven, gas hob with cooker hood over, integrated dishwasher and built-in wine rack. Spotlights, radiator & rear aspect double glazed window. Opens to Snug.

Snug

Radiator & front aspect double glazed window.

Utility Room

Fitted with wall and base unit, work surface over with tiled splashback and stainless steel sink & drainer unit, plumbing for washing machine, airing cupboard and houses central heating boiler. Rear aspect double glazed window, door to outside and an internal door to the Garage.

First Floor Gallery Landing

Loft access, double built-in cupboard & radiator. Doors to Bedrooms and Bathroom.

Bedroom One

Radiator and front aspect double glazed window. Door to En-suite.

En-Suite

Suite comprising low level WC, wash basin vanity unit and corner shower cubicle. Tiled walls, radiator & double glazed window.

Bedroom Two

Built-in wardrobe, radiator & rear aspect double glazed window.

Bedroom Three

Radiator & front aspect double glazed window with rural views.

Bedroom Four

Radiator & rear aspect double glazed window.

Bathroom

Suite comprising low level WC, wash basin vanity unit, separate shower cubicle and bath with mixer tap. Fully-tiled, heated towel rail & double glazed window.

Outside

The front of the property is set back with a small brick wall opening up to a large gravel area which offers ample off-road parking, a front garden laid to lawn with planted borders and leads to the Garage which has an electric roller door, power & lighting.

There is side access to the rear garden which has a patio area and lawned garden with planted borders.

Agent's Note

It is our understanding that the Property is not registered at the Land Registry which is the case with a significant proportion of land across England and Wales. Your conveyancer will take the necessary steps and advise you as to time-frames for registration.



view this property online williamhbrown.co.uk/Property/AYS110102



welcome to

Kelso, Croft Lane, Marsham, Norwich

- Substantial Detached Home
- 4 Double Bedrooms - Main with En-Suite
- Delightful Location
- 3 Reception Areas
- Fantastic Potential
- Front And Rear Gardens
- Ample Parking
- Single Garage With Electric Door.

Tenure: Freehold EPC Rating: D

Council Tax Band: F

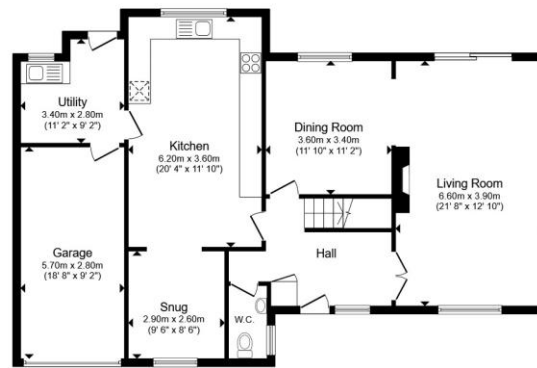

Ground Floor

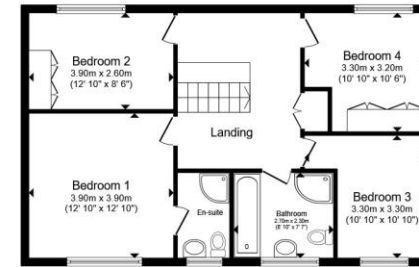

First Floor

Total floor area 178.4 m² (1,920 sq.ft.) approx

This floor plan is for illustrative purposes only. It is not drawn to scale. Any measurements, floor areas (including any total floor area), openings and orientation are approximate. No details are guaranteed, they cannot be relied upon for any purpose and they do not form part of any agreement. No liability is taken for any error, omission or misstatement. A party must rely upon its own inspection(s). Powered by www.propertybox.io

£500,000



Please note the marker reflects the postcode not the actual property

view this property online williamhbrown.co.uk/Property/AYS110102



Property Ref:
AYS110102 - 0002

1. MONEY LAUNDERING REGULATIONS Intending purchasers will be asked to produce identification documentation at a later stage and we would ask for your co-operation in order that there is no delay in agreeing the sale. 2. These particulars do not constitute part or all of an offer or contract. 3. The measurements indicated are supplied for guidance only and as such must be considered incorrect. Potential buyers are advised to recheck measurements before committing to any expense. 4. We have not tested any apparatus, equipment, fixtures or services and it is in the buyers interest to check the working condition of any appliances. 5. Where an EPC, or a Home Report (Scotland only) is held for this property, it is available for inspection at the branch by appointment. If you require a printed version of a Home Report, you will need to pay a reasonable production charge reflecting printing and other costs. 6. We are not able to offer an opinion either written or verbal on the content of these reports and this must be obtained from your legal representative. 7. Whilst we take care in preparing these reports, a buyer should ensure that his/her legal representative confirms as soon as possible all matters relating to title including the extent and boundaries of the property and other important matters before exchange of contracts.

William H Brown is a trading name of Sequence (UK) Limited which is registered in England and Wales under company number 4268443, Registered Office is Cumbria House, 16-20 Hockliffe Street, Leighton Buzzard, Bedfordshire, LU7 1GN. VAT Registration Number is 500 2481 05.



william h brown



01263 735252



Aylsham@williamhbrown.co.uk



23 Market Place, AYLSHAM, NORWICH,
Norfolk, NR11 6EL



williamhbrown.co.uk