



St. Marys Close, Horsham St. Faith, Norwich, NR10 3HP

welcome to

St. Marys Close, Horsham St. Faith, Norwich

A beautifully presented, 3 Bedroom Chalet Bungalow, in a sought after village location with a re-fitted Kitchen/Diner, Bathroom & Shower Room. Externally the property offers driveway parking, single Garage & well-kept rear garden.



Description

Don't miss this immaculate, detached Chalet set in a cul-de-sac location in the popular village of Horsham St Faiths which has a local pub 'The Black Swan' and transport links to the market town of Aylsham & Norwich City Centre.

The property offers spacious internal accommodation and has been updated to include Lounge with feature fireplace opening into Conservatory, re-fitted Kitchen/Diner and re-fitted Bathroom to the ground floor. Upstairs has 3 Bedrooms & re-fitted Shower Room. Outside offers ample off-road driveway parking, single Garage with power & lighting and well-kept rear garden with patio.

Entrance Hall

Front door opens into hall with stairs to first floor, wood effect flooring & radiator.

Lounge

19' 10" x 10' 5" (6.05m x 3.17m)

Feature fireplace with beam over, TV point, spotlights, 2 radiators & front aspect double glazed window. Opens to Conservatory.

Conservatory

10' 10" x 9' 1" (3.30m x 2.77m)

Brick base with uPVC windows, oak flooring, radiator & double doors to outside.

Re-Fitted Kitchen/ Diner

19' 11" x 7' 11" (6.07m x 2.41m)

Double aspect room with a Re-fitted kitchen with a range of wall & base units, work top over with matching upstand and stainless steel sink with mixer tap over. Double oven with and gas hob with stainless steel extractor fan over & glass splash back, space for fridge/freezer, plumbing for washing machine & Neff integrated dishwasher. Breakfast bar, spotlights, wood effect floor, 2 radiators & 2 double glazed windows. Door to outside.

Re-Fitted Bathroom

Fully tiled suite comprising WC, wash basin vanity unit & bath with mixer taps and shower attachment. Spotlights, wood effect floor, heated towel rail & double glazed window.

Landing

Airing cupboard with boiler and doors to Bedrooms & Shower Room.

Bedroom One

11' 10" to wardrobe x 10' 9" (3.61m to wardrobe x 3.28m)
Built-in mirror fronted wardrobes, radiator & front aspect double glazed window with shutters.

Bedroom Two

11' 3" x 10' 4" max (3.43m x 3.15m max)

Built-in mirror fronted wardrobes, radiator & front aspect double glazed window with shutters.

Bedroom Three

10' x 6' 2" (3.05m x 1.88m)

Wood effect floor, radiator & rear aspect double glazed window.

Re-Fitted Shower Room

Suite comprising WC, wash basin vanity unit & shower cubicle. Heated towel rail & double glazed window.

Outside

To the front of the property is a gravel garden with a driveway to the side which leads to a single Garage with up & over door, power, lighting & personal door to the side.

The rear garden is extremely well-kept, partly walled with lawn area, patio and is well stocked with plants & shrubs.

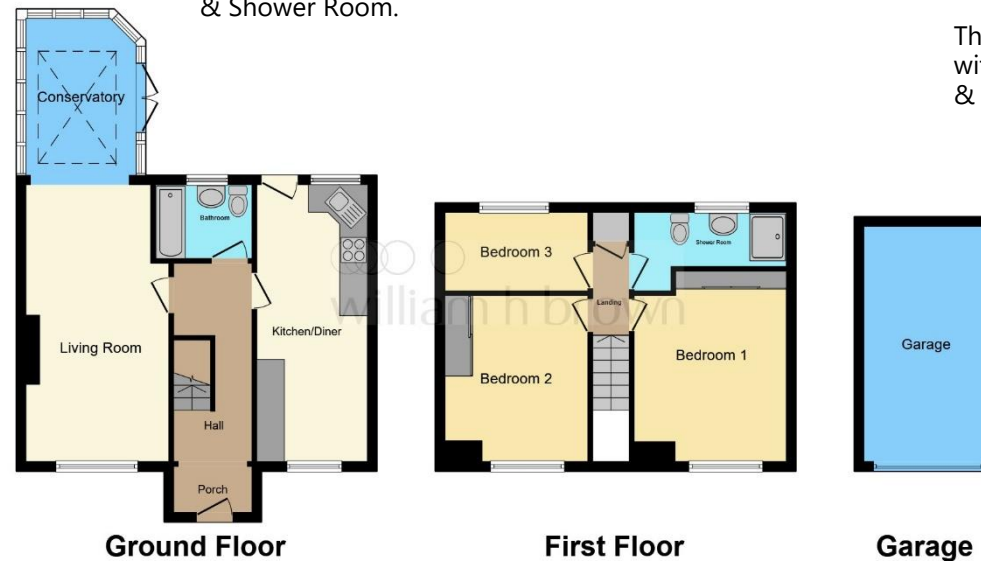

This floor plan is for illustrative purposes only. It is not drawn to scale. Any measurements, floor areas (including any total floor area), openings and orientation are approximate. No details are guaranteed, they cannot be relied upon for any purpose and they do not form part of any agreement. No liability is taken for any error, omission or misstatement. A party must rely upon its own inspection(s). Powered by www.focalagent.com



view this property online williamhbrown.co.uk/Property/AYS109488



welcome to

St. Marys Close, Horsham St. Faith, Norwich

- Detached Chalet Bungalow
- 3 Bedrooms
- Re-Fitted Kitchen/Diner, Bathroom & Shower Room
- Lounge & Conservatory
- Driveway Parking & Single Garage
- Well-Kept Rear Garden
- Sought After Village Location

Tenure: Freehold EPC Rating: C

£365,000



Please note the marker reflects the postcode not the actual property

view this property online williambrown.co.uk/Property/AYS109488



Property Ref:
AYS109488 - 0004

1. MONEY LAUNDERING REGULATIONS Intending purchasers will be asked to produce identification documentation at a later stage and we would ask for your co-operation in order that there is no delay in agreeing the sale. 2. These particulars do not constitute part or all of an offer or contract. 3. The measurements indicated are supplied for guidance only and as such must be considered incorrect. Potential buyers are advised to recheck measurements before committing to any expense. 4. We have not tested any apparatus, equipment, fixtures or services and it is in the buyer's interest to check the working condition of any appliances. 5. Where an EPC, or a Home Report (Scotland only) is held for this property, it is available for inspection at the branch by appointment. If you require a printed version of a Home Report, you will need to pay a reasonable production charge reflecting printing and other costs. 6. We are not able to offer an opinion either written or verbal on the content of these reports and this must be obtained from your legal representative. 7. Whilst we take care in preparing these reports, a buyer should ensure that his/her legal representative confirms as soon as possible all matters relating to title including the extent and boundaries of the property and other important matters before exchange of contracts.

William H Brown is a trading name of Sequence (UK) Limited which is registered in England and Wales under company number 4268443, Registered Office is Cumbria House, 16-20 Hockliffe Street, Leighton Buzzard, Bedfordshire, LU7 1GN. VAT Registration Number is 500 2481 05.



william h brown



01263 735252



Aylsham@williambrown.co.uk



23 Market Place, AYLSHAM, NORWICH,
Norfolk, NR11 6EL



williambrown.co.uk