



**Old Spot Way, Winsford CW7 1GL**



**welcome to**

**Old Spot Way, Winsford**

A well presented Semi-Detached home with Two Double Bedrooms, Downstairs Cloak Room/ W.C, Driveway for off road parking and a Low Maintenance rear Garden.



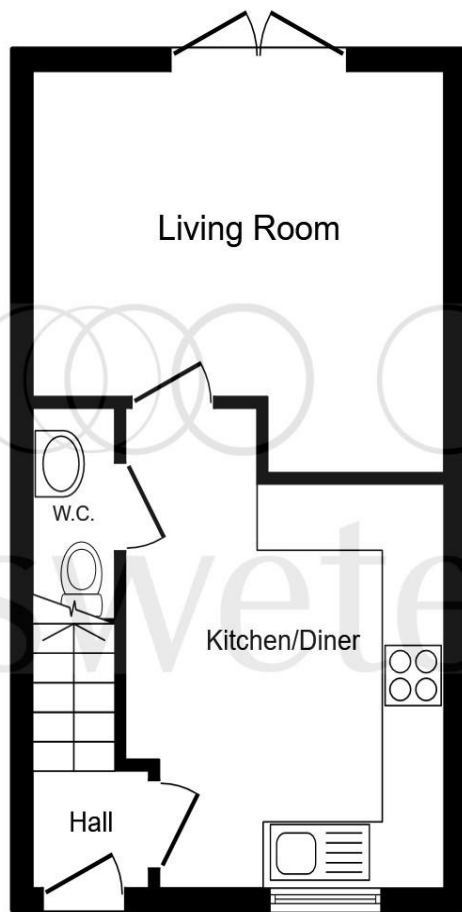

**Ground Floor**

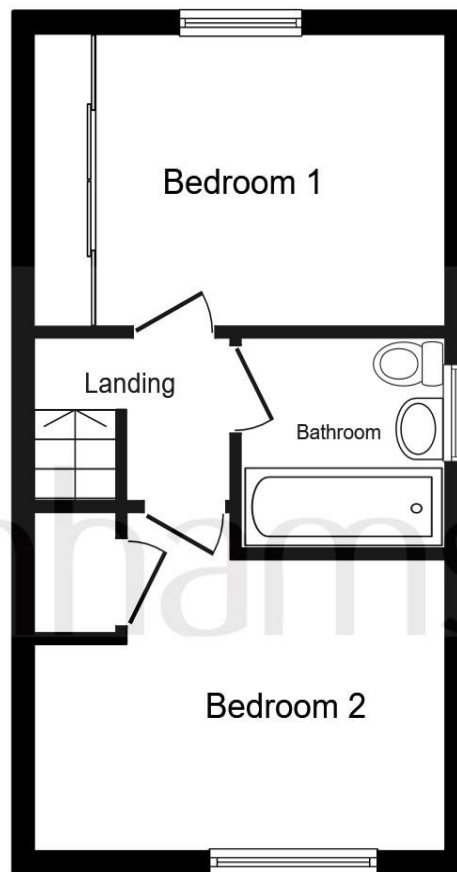

**First Floor**

## Ground Floor

### Entrance Hall

### Kitchen/ Diner

9' 9" x 12' 1" ( 2.97m x 3.68m )

### Living Room

13' x 11' 9" ( 3.96m x 3.58m )

### Cloakroom/ W.C.

## First Floor

### Landing

### Master Bedroom

13' x 8' 9" ( 3.96m x 2.67m )

### Bedroom Two

13' 7" x 8' 4" ( 4.14m x 2.54m )

### Family Bathroom

### External

To the rear, the property boasts a private enclosed garden with low-maintenance Astro turf, perfect for relaxing or entertaining. To the front is a driveway providing off road parking.

welcome to

## Old Spot Way, Winsford

- Semi-Detached
- Two Double Bedrooms
- Downstairs Cloak Room/ W.C.
- Off Road Parking for Two Cars
- Low Maintenance Garden

Tenure: Freehold EPC Rating: B  
Council Tax Band: B

offers over  
**£175,000**



Please note the marker reflects the  
postcode not the actual property

**view this property online** [swetenhams.co.uk/Property/WSF108701](https://swetenhams.co.uk/Property/WSF108701)



Property Ref:  
WSF108701 - 0002

1. MONEY LAUNDERING REGULATIONS Intending purchasers will be asked to produce identification documentation at a later stage and we would ask for your co-operation in order that there is no delay in agreeing the sale. 2. These particulars do not constitute part or all of an offer or contract. 3. The measurements indicated are supplied for guidance only and as such must be considered incorrect. Potential buyers are advised to recheck measurements before committing to any expense. 4. We have not tested any apparatus, equipment, fixtures or services and it is in the buyers interest to check the working condition of any appliances. 5. Where an EPC, or a Home Report (Scotland only) is held for this property, it is available for inspection at the branch by appointment. If you require a printed version of a Home Report, you will need to pay a reasonable production charge reflecting printing and other costs. 6. We are not able to offer an opinion either written or verbal on the content of these reports and this must be obtained from your legal representative. 7. Whilst we take care in preparing these reports, a buyer should ensure that his/her legal representative confirms as soon as possible all matters relating to title including the extent and boundaries of the property and other important matters before exchange of contracts.

Swetenhams is a trading name of Sequence (UK) Limited which is registered in England and Wales under company number 4268443, Registered Office is Cumbria House, 16-20 Hockliffe Street, Leighton Buzzard, Bedfordshire, LU7 1GN. VAT Registration Number is 500 2481 05.



swetenhams



**01606 593344**



[Winsford@swetenhams.co.uk](mailto:Winsford@swetenhams.co.uk)



12 Dingle Walk, Winsford Cross Shopping  
Centre, WINSFORD, Cheshire, CW7 1BA



**[swetenhams.co.uk](https://swetenhams.co.uk)**