



**Williams Way, Marsh Lane, Frodsham WA6 7BX**



**Welcome to**

**Williams Way, Marsh Lane, Frodsham**

Swetenhams are delighted to showcase this superbly appointed Park Home occupying a choice location within this sought after development. The plot size is such that the surrounding infrastructure provides plenty of parking and outdoor space.





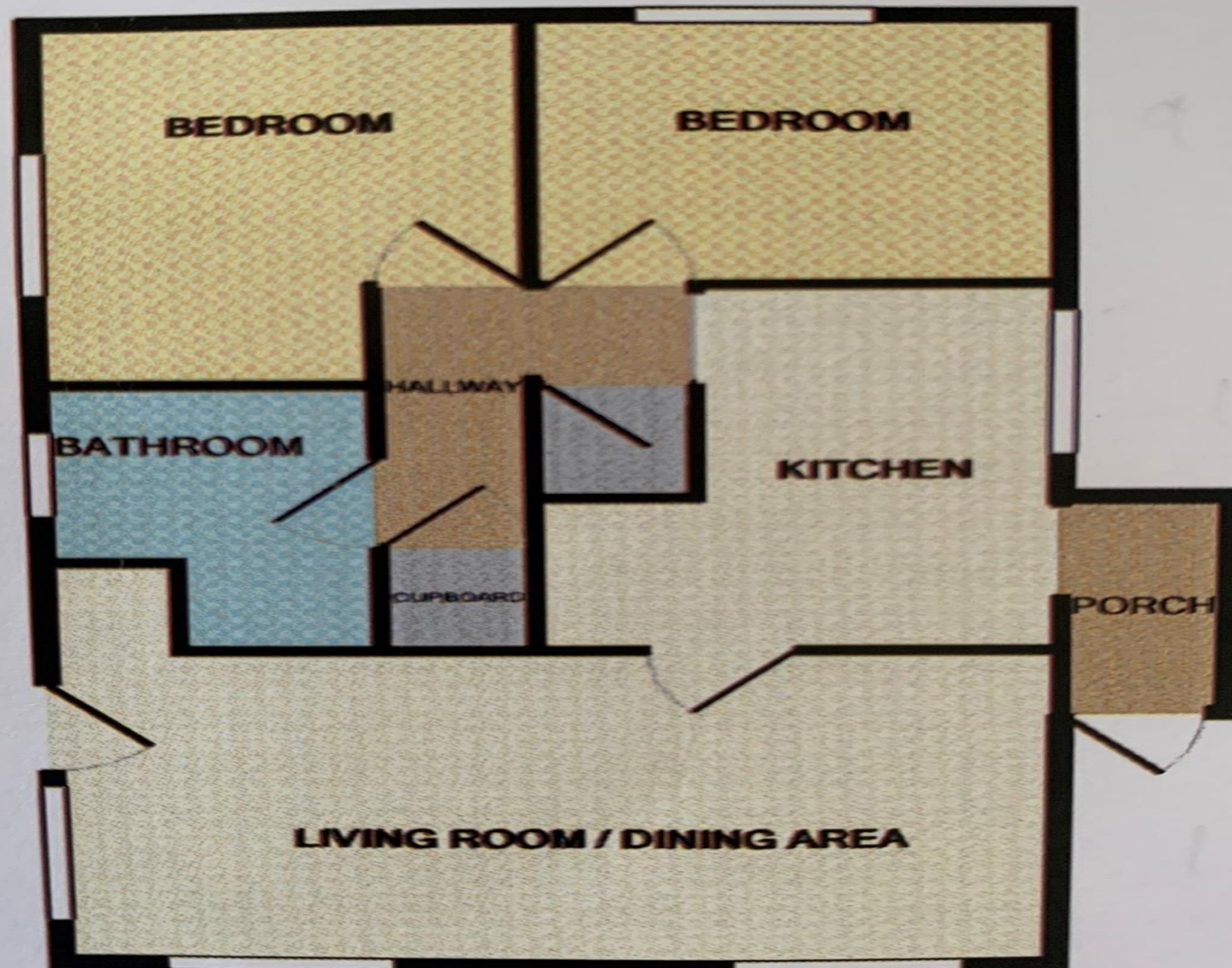

## Entrance

## Kitchen

11' 9" x 7' ( 3.58m x 2.13m )

## Lounge

17' 9" x 10' 5" ( 5.41m x 3.17m )

## Bedroom One

9' 8" x 8' 6" ( 2.95m x 2.59m )

## Bedroom Two

9' 7" x 11' 3" to back of built in wardrobes  
( 2.92m x 3.43m to back of built in wardrobes )

## Shower Room

## Outside

**Welcome to**

## **Williams Way, Marsh Lane, Frodsham**

- PROPERTY CAN BE COMPLETED WITHIN 14 DAYS (terms apply)
- Superb Park Home
- Two bedroom
- High standard of presentation
- Premium location

Tenure: EPC Rating: Exempt

We are currently awaiting Tenure details. For further information please contact the branch. Please note additional fees could be incurred for items such as leasehold packs.

offers over

**£160,000**

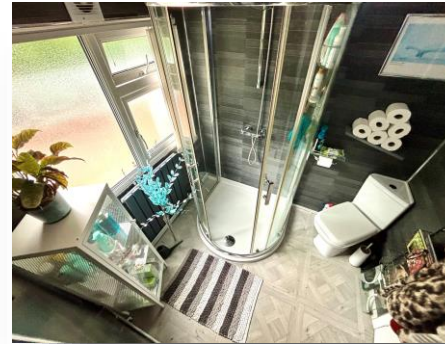

Please note the marker reflects the postcode not the actual property

**view this property online** [swetenhams.co.uk/Property/FRM108991](https://swetenhams.co.uk/Property/FRM108991)



Property Ref:  
FRM108991 - 0007

1. MONEY LAUNDERING REGULATIONS Intending purchasers will be asked to produce identification documentation at a later stage and we would ask for your co-operation in order that there is no delay in agreeing the sale. 2. These particulars do not constitute part or all of an offer or contract. 3. The measurements indicated are supplied for guidance only and as such must be considered incorrect. Potential buyers are advised to recheck measurements before committing to any expense. 4. We have not tested any apparatus, equipment, fixtures or services and it is in the buyers interest to check the working condition of any appliances. 5. Where an EPC, or a Home Report (Scotland only) is held for this property, it is available for inspection at the branch by appointment. If you require a printed version of a Home Report, you will need to pay a reasonable production charge reflecting printing and other costs. 6. We are not able to offer an opinion either written or verbal on the content of these reports and this must be obtained from your legal representative. 7. Whilst we take care in preparing these reports, a buyer should ensure that his/her legal representative confirms as soon as possible all matters relating to title including the extent and boundaries of the property and other important matters before exchange of contracts.

Swetenhams is a trading name of Sequence (UK) Limited which is registered in England and Wales under company number 4268443, Registered Office is Cumbria House, 16-20 Hockliffe Street, Leighton Buzzard, Bedfordshire, LU7 1GN. VAT Registration Number is 500 2481 05.



**swetenhams**



**01928 732626**



[frodsham@swetenhams.co.uk](mailto:frodsham@swetenhams.co.uk)



Froda House, 113 Main Street, FRODSHAM,  
Cheshire, WA6 7AB



**[swetenhams.co.uk](https://swetenhams.co.uk)**