



**Hoole Lane, Chester CH2 3DS**



**Welcome to**

**Hoole Lane, Chester**

Positioned along ever-convenient Hoole Lane, this three-bedroom home makes a great first impression with its inviting layout and surprising depth.



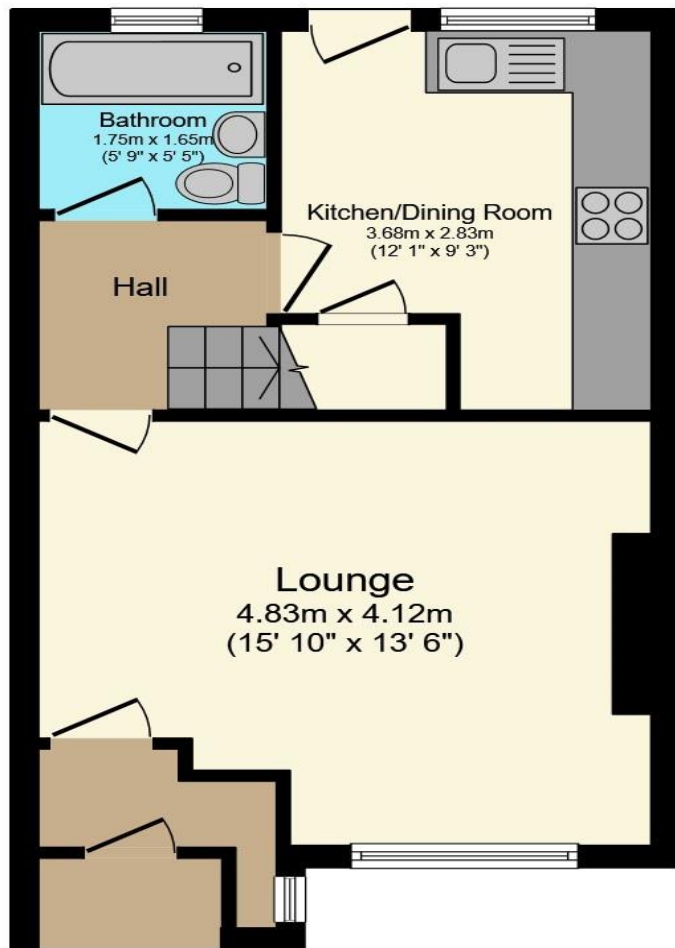

### Ground Floor

Floor area 38.4 m<sup>2</sup> (414 sq.ft.) approx

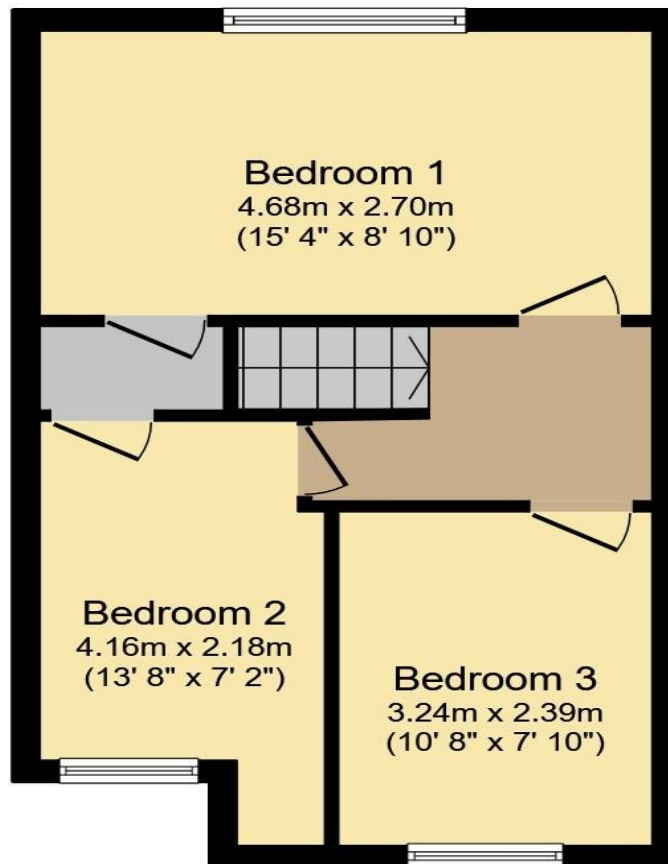

### First Floor

Floor area 35.7 m<sup>2</sup> (385 sq.ft.) approx

**Entrance Porch**

**Lounge**

15' 10" x 13' 6" ( 4.83m x 4.11m )

**Hallway**

**Kitchen**

12' x 9' 3" ( 3.66m x 2.82m )

**Bathroom**

**First Floor Landing**

**Bedroom One**

15' 2" x 8' 10" ( 4.62m x 2.69m )

**Bedroom Two**

13' 8" x 7' 2" ( 4.17m x 2.18m )

**Bedroom Three**

10' 8" x 7' 10" ( 3.25m x 2.39m )

**Front Garden**

**Rear Garden**

Total floor area 74.2 m<sup>2</sup> (798 sq.ft.) approx

This plan is for illustration purposes only and may not be representative of the property. Plan not to scale.

Powered by [audioagent.com](http://audioagent.com)

## Welcome to

## Hoole Lane, Chester

- Terraced Property
- Three Bedrooms
- Off Road Parking
- Perfect For First Time Buyers
- Close To Local Amenities

Tenure: Freehold EPC Rating: D

Council Tax Band: B

# £250,000



Please note the marker reflects the postcode not the actual property

**view this property online** [swetenhams.co.uk/Property/CHS118794](https://swetenhams.co.uk/Property/CHS118794)



Property Ref:  
CHS118794 - 0003

1. MONEY LAUNDERING REGULATIONS Intending purchasers will be asked to produce identification documentation at a later stage and we would ask for your co-operation in order that there is no delay in agreeing the sale. 2. These particulars do not constitute part or all of an offer or contract. 3. The measurements indicated are supplied for guidance only and as such must be considered incorrect. Potential buyers are advised to recheck measurements before committing to any expense. 4. We have not tested any apparatus, equipment, fixtures or services and it is in the buyers interest to check the working condition of any appliances. 5. Where an EPC, or a Home Report (Scotland only) is held for this property, it is available for inspection at the branch by appointment. If you require a printed version of a Home Report, you will need to pay a reasonable production charge reflecting printing and other costs. 6. We are not able to offer an opinion either written or verbal on the content of these reports and this must be obtained from your legal representative. 7. Whilst we take care in preparing these reports, a buyer should ensure that his/her legal representative confirms as soon as possible all matters relating to title including the extent and boundaries of the property and other important matters before exchange of contracts.

Swetenhams is a trading name of Sequence (UK) Limited which is registered in England and Wales under company number 4268443, Registered Office is Cumbria House, 16-20 Hockliffe Street, Leighton Buzzard, Bedfordshire, LU7 1GN. VAT Registration Number is 500 2481 05.



swetenhams



**01244 321321**



[chester@swetenhams.co.uk](mailto:chester@swetenhams.co.uk)



28 Lower Bridge Street, CHESTER, Cheshire,  
CH1 1RS



**[swetenhams.co.uk](https://swetenhams.co.uk)**