



Brook Lane Shops, Brook Lane, Chester CH2 2EB

welcome to

Brook Lane Shops, Brook Lane, Chester

A spacious and beautifully appointed 1st floor apartment in a central location with easy access to local amenities and a short walk to Hoole village and Chester city centre. Unusually, there are no service charges or ground rent, and there is some private outdoor seating space.



Entrance Hall

With timber-effect flooring, coat hanging space, and a meter cupboard with a display shelf over.

Lounge/Kitchen/Dining Room

27' x 9' 8" (8.23m x 2.95m)

A large, light open plan space with uPVC double glazed windows to the front and rear elevations, and timber-effect laminate flooring throughout in contemporary style. The kitchen area is fitted with an extensive range of white kitchen units, both wall and base, work surfaces with cupboards under, an inset stainless steel sink and drainer unit with mixer tap over, space and plumbing under work surface for a washing machine, space for an electric cooker, a matching range of wall cabinets, tiled splashback, a uPVC double glazed window to the front elevation with display sill, and a wall-mounted extractor. The lounge/dining space has timber-effect laminate flooring, ample space for sitting/dining, and two radiators.

Inner Hall

With continuation of the timber-effect laminate flooring, coved ceiling, high-level shelving, and doors of to all rooms.

Bedroom One

11' 4" x 9' 9" (3.45m x 2.97m)

With a uPVC double glazed window to the rear elevation, timber-effect laminate flooring, coved ceiling, built-in boiler cupboard with gas-fired Combi boiler for central heating and domestic hot water, with storage over.

Bedroom Two

9' 9" x 7' 2" (2.97m x 2.18m)

With a uPVC double glazed window to the front elevation overlooking the outside terrace, timber-effect laminate flooring, coved ceiling, and a radiator.

Bathroom

Bathroom suite comprising a panel bath in a tiled surround with an electric shower over, pedestal wash basin, low level WC, tiled floor and complementary contrast wall tiling, a vertical chrome towel rail/radiator.

Outside Space

The metal staircase from the driveway at the rear of the shops leads to a very pleasant, sheltered sun-trap with flagged and artificial grass terrace bounded by screened fencing, which provides a remarkably private and sunny retreat.

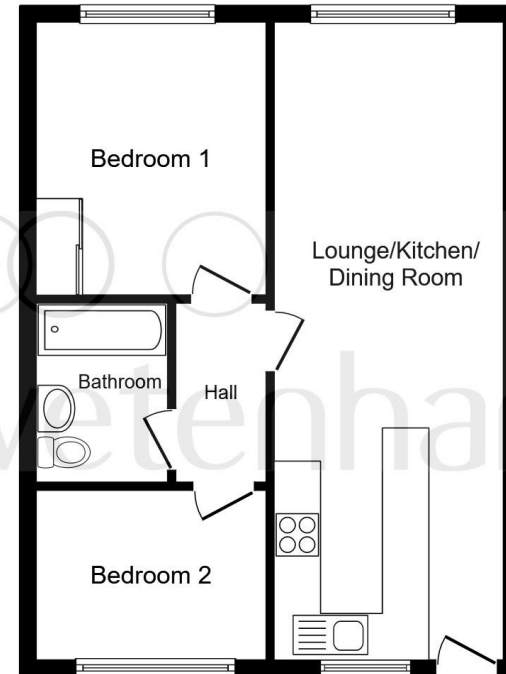

This floor plan is for illustrative purposes only. It is not drawn to scale. Any measurements, floor areas (including any total floor area), openings and orientation are approximate. No details are guaranteed, they cannot be relied upon for any purpose and they do not form part of any agreement. No liability is taken for any error, omission or misstatement. A party must rely upon its own inspection(s). Powered by www.focalagent.com



view this property online swetenhams.co.uk/Property/CHS118343



welcome to

Brook Lane Shops, Brook Lane, Chester

- A Two-Bedroom First Floor Apartment
- Spacious and Beautifully Appointed
- Central Location close to Hoole Village and Chester City Centre
- No Service Charges or Ground Rent
- Private Outside Seating Space

Tenure: Leasehold

EPC Rating: D

Council Tax Band: A

This is a Leasehold property with details as follows; Term of Lease 210 years from 15 Sep 2006. Should you require further information please contact the branch. Please Note additional fees could be incurred for items such as Leasehold packs.

£140,000



Please note the marker reflects the postcode not the actual property

view this property online swetenhams.co.uk/Property/CHS118343



Property Ref:
CHS118343 - 0002

1. MONEY LAUNDERING REGULATIONS Intending purchasers will be asked to produce identification documentation at a later stage and we would ask for your co-operation in order that there is no delay in agreeing the sale. 2. These particulars do not constitute part or all of an offer or contract. 3. The measurements indicated are supplied for guidance only and as such must be considered incorrect. Potential buyers are advised to recheck measurements before committing to any expense. 4. We have not tested any apparatus, equipment, fixtures or services and it is in the buyers interest to check the working condition of any appliances. 5. Where an EPC, or a Home Report (Scotland only) is held for this property, it is available for inspection at the branch by appointment. If you require a printed version of a Home Report, you will need to pay a reasonable production charge reflecting printing and other costs. 6. We are not able to offer an opinion either written or verbal on the content of these reports and this must be obtained from your legal representative. 7. Whilst we take care in preparing these reports, a buyer should ensure that his/her legal representative confirms as soon as possible all matters relating to title including the extent and boundaries of the property and other important matters before exchange of contracts.

Swetenhams is a trading name of Sequence (UK) Limited which is registered in England and Wales under company number 4268443, Registered Office is Cumbria House, 16-20 Hockliffe Street, Leighton Buzzard, Bedfordshire, LU7 1GN. VAT Registration Number is 500 2481 05.

swetenhams



01244 321321



chester@swetenhams.co.uk



28 Lower Bridge Street, CHESTER, Cheshire,
CH1 1RS



swetenhams.co.uk