



Glenfield Crescent, Mickleover Derby DE3 0RF

welcome to

Glenfield Crescent, Mickleover Derby

This property's ground floor accommodation comprises of an entrance hallway, spacious lounge, dining room, sizeable kitchen and a snug with a sliding door leading to the rear garden. To the first floor there are three bedrooms and an immaculate family bathroom.

Entrance Hallway

With a window to the side elevation, laminate flooring, central heating radiator, doors leading to the lounge and kitchen, and the stairs leading to the first floor.

Lounge

12' 9" x 10' 6" (3.89m x 3.20m)

With a window to the front elevation, carpeted flooring, central heating radiator, fireplace and an archway leading to the dining room.

Kitchen

13' x 11' 7" (3.96m x 3.53m)

With a window to the side and rear elevation, tiled flooring, fitted kitchen with a sink set in a base unit, further base, wall and drawer units, rolled edge work top, space for appliances, cooker hood, and a door to the rear garden.

Dining Room

10' 8" x 9' 5" (3.25m x 2.87m)

With carpeted flooring, central heating radiator, archways to the snug and the lounge.

Snug

9' 1" x 8' 8" (2.77m x 2.64m)

With a window to the side elevation, carpeted flooring, central heating radiator, French doors to the rear garden.

Landing

With carpeted flooring and doors leading to the bedrooms and bathroom.

Master Bedroom

12' 7" x 10' 1" (3.84m x 3.07m)

With a window to the front elevation, carpeted flooring, central heating radiator.

Bedroom Two

11' 4" x 10' 4" (3.45m x 3.15m)

With a window to the rear elevation, carpeted flooring, central heating radiator.

Bedroom Three

9' 4" x 6' 4" (2.84m x 1.93m)

With a window to the front elevation, carpeted flooring, central heating radiator.

Bathroom

With a window to the rear elevation, tiled flooring, wash hand basin with a marble effect countertop, low level w/c, bath with shower attachments, shower compartment.

External

To the front of the property there is a brick paved driveway providing ample parking for multiple vehicles and a laid-to-lawn garden. To the rear there is a private and enclosed rear garden with a paved patio area with steps leading to the slightly raised laid-to-lawn garden.





check out more properties at bagshawsresidential.co.uk



welcome to

Glenfield Crescent, Mickleover Derby

- Sizeable kitchen
- Modern family bathroom
- Three well-presented bedrooms
- Private and enclosed rear garden
- Spacious lounge

Tenure: Freehold EPC Rating: E

offers over

£270,000



Ground Floor

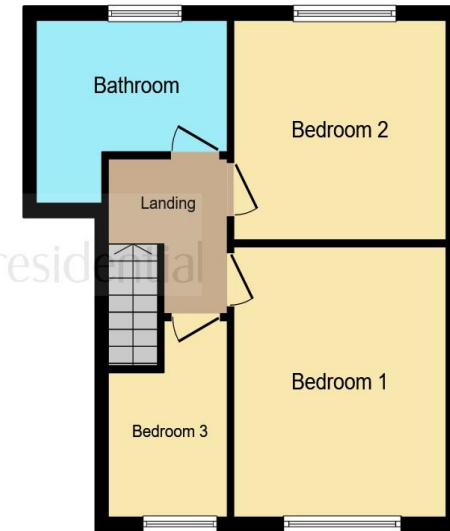

First Floor

This floor plan is for illustrative purposes only. It is not drawn to scale. Any measurements, floor areas (including any total floor area), openings and orientation are approximate. No details are guaranteed, they cannot be relied upon for any purpose and they do not form part of any agreement. No liability is taken for any error, omission or misstatement. A party must rely upon its own inspection(s). Powered by www.focalagent.com

check out more properties at bagshawsresidential.co.uk



Property Ref:
MVR108451 - 0002

1. MONEY LAUNDERING REGULATIONS Intending purchasers will be asked to produce identification documentation at a later stage and we would ask for your co-operation in order that there is no delay in agreeing the sale. 2. These particulars do not constitute part or all of an offer or contract. 3. The measurements indicated are supplied for guidance only and as such must be considered incorrect. Potential buyers are advised to recheck measurements before committing to any expense. 4. We have not tested any apparatus, equipment, fixtures or services and it is in the buyers interest to check the working condition of any appliances. 5. Where an EPC, or a Home Report (Scotland only) is held for this property, it is available for inspection at the branch by appointment. If you require a printed version of a Home Report, you will need to pay a reasonable production charge reflecting printing and other costs. 6. We are not able to offer an opinion either written or verbal on the content of these reports and this must be obtained from your legal representative. 7. Whilst we take care in preparing these reports, a buyer should ensure that his/her legal representative confirms as soon as possible all matters relating to title including the extent and boundaries of the property and other important matters before exchange of contracts.

Bagshaws Residential is a trading name of Sequence (UK) Limited which is registered in England and Wales under company number 4268443, Registered Office is Cumbria House, 16-20 Hockliffe Street, Leighton Buzzard, Bedfordshire, LU7 1GN. VAT Registration Number is 500 2481 05.



01332 518844



mickleover@bagshawsresidential.co.uk



14 The Square, Mickleover, DERBY, Derbyshire,
DE3 0DD



bagshawsresidential.co.uk