



Holcombe Street, Derby DE23 8JB

welcome to

Holcombe Street, Derby

Ideally situated for shops, schools and Derby City Centre, is this two bedroom end of terrace house in Normanton, offered for sale with no onward chain. This conventional terrace home would make an excellent investment or first time buy.



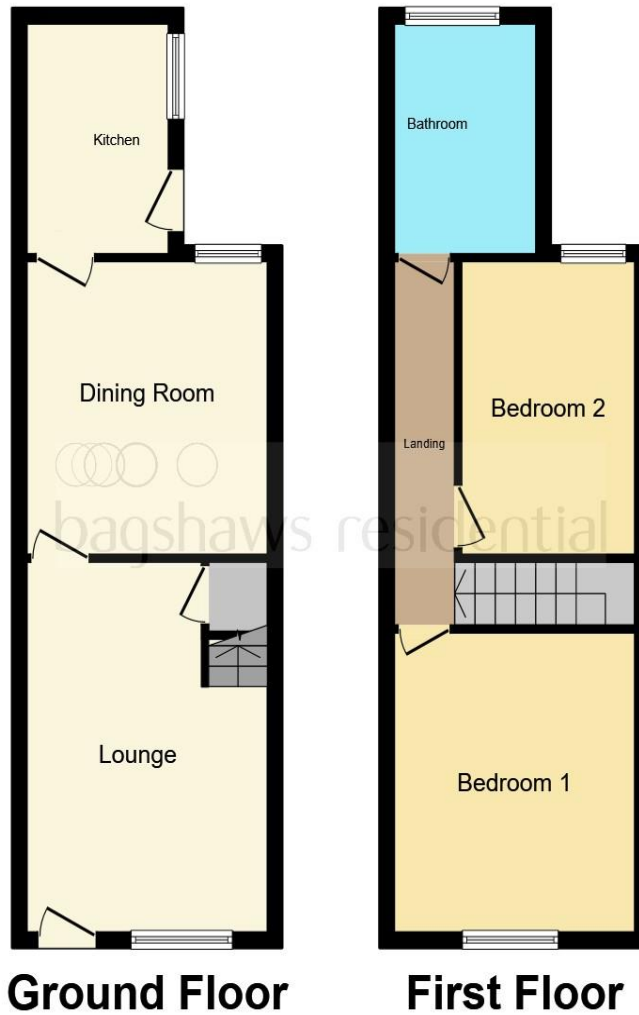

Living Room
15' 5" x 10' 8" (4.70m x 3.25m)

Dining Room
12' 2" x 10' 9" (3.71m x 3.28m)

Kitchen
6' 4" x 9' 7" (1.93m x 2.92m)

Stairs & Landing

Bedroom One
12' 3" x 10' 9" (3.73m x 3.28m)

Bedroom Two
7' 9" x 12' 3" (2.36m x 3.73m)

Bathroom
6' 3" x 9' 11" (1.91m x 3.02m)

This floor plan is for illustrative purposes only. It is not drawn to scale. Any measurements, floor areas (including any total floor area), openings and orientation are approximate. No details are guaranteed, they cannot be relied upon for any purpose and they do not form part of any agreement. No liability is taken for any error, omission or misstatement. A party must rely upon its own inspection(s). Powered by www.focalagent.com

welcome to

Holcombe Street, Derby

- Two Bedroom End Terrace Home
- Modern Kitchen
- Enclosed Garden
- No Onward Chain
- Council Tax Band A

Tenure: Freehold EPC Rating: D

offers in the region of

£125,000

Ideally situated for shops, schools and Derby City Centre, is this two bedroom end of terrace house in Normanton, offered for sale with no onward chain. This conventional terrace home would make an excellent investment or first time buy.

The property briefly comprises of a front living room with stairs leading to the first floor and dining room with outlook into the garden and a galley kitchen with modern base and wall units, freestanding cooker and external doorway to the rear garden. To the first floor is a landing connecting to two bedrooms and the family bathroom to the rear. Outside, the property has a generous rear garden laid to lawn with outside stores, a side gate to the footpath at the front of the property.



Please note the marker reflects the postcode not the actual property

view this property online [bagshawsresidential.co.uk/Property/DBY119570](https://www.bagshawsresidential.co.uk/Property/DBY119570)



Property Ref:
DBY119570 - 0002

1. MONEY LAUNDERING REGULATIONS Intending purchasers will be asked to produce identification documentation at a later stage and we would ask for your co-operation in order that there is no delay in agreeing the sale. 2. These particulars do not constitute part or all of an offer or contract. 3. The measurements indicated are supplied for guidance only and as such must be considered incorrect. Potential buyers are advised to recheck measurements before committing to any expense. 4. We have not tested any apparatus, equipment, fixtures or services and it is in the buyers interest to check the working condition of any appliances. 5. Where an EPC, or a Home Report (Scotland only) is held for this property, it is available for inspection at the branch by appointment. If you require a printed version of a Home Report, you will need to pay a reasonable production charge reflecting printing and other costs. 6. We are not able to offer an opinion either written or verbal on the content of these reports and this must be obtained from your legal representative. 7. Whilst we take care in preparing these reports, a buyer should ensure that his/her legal representative confirms as soon as possible all matters relating to title including the extent and boundaries of the property and other important matters before exchange of contracts.

Bagshaws Residential is a trading name of Sequence (UK) Limited which is registered in England and Wales under company number 4268443, Registered Office is Cumbria House, 16-20 Hockliffe Street, Leighton Buzzard, Bedfordshire, LU7 1GN. VAT Registration Number is 500 2481 05.



bagshaws residential



01332 361308



Derby@bagshawsresidential.co.uk



32-34 Cornmarket, DERBY, Derbyshire, DE1 2DG



bagshawsresidential.co.uk