



**Church Street, Ducklington Witney OX29 7UT**



**welcome to**

## **Church Street, Ducklington Witney**

Situated within a highly popular village location sits this deceptively spacious barn conversion which offers superb character throughout. Briefly comprising kitchen/diner, utility area, living room, three bedrooms, two bathrooms, an enclosed rear garden and driveway parking.



# Tallet Barn, Church Street, Ducklington, Witney, OX29



Denotes restricted head height

Approximate Area = 1496 sq ft / 139 sq m  
 Limited Use Area(s) = 83 sq ft / 7.7 sq m  
 Total = 1579 sq ft / 146.6 sq m  
 For identification only - Not to scale

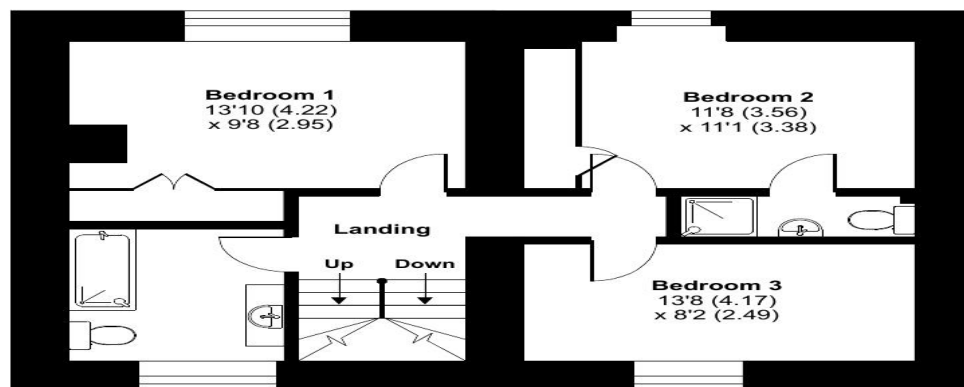

FIRST FLOOR

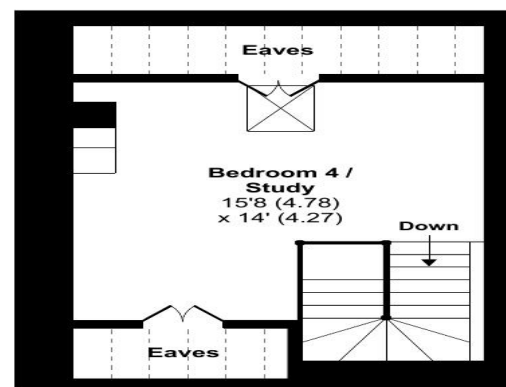

SECOND FLOOR

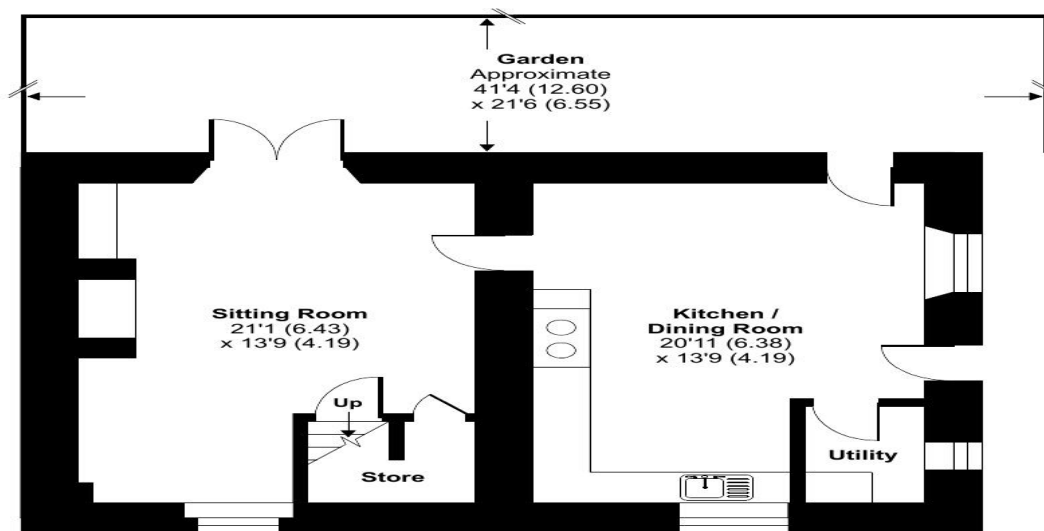

GROUND FLOOR

## Kitchen/Diner

20' 11" x 13' 8" ( 6.38m x 4.17m )

## Utility Room

6' 4" x 4' 3" ( 1.93m x 1.30m )

## Living Room

13' 10" x 21' ( 4.22m x 6.40m )

## Landing

## Bedroom One

11' 1" x 11' 9" ( 3.38m x 3.58m )

## Bedroom Two

9' 8" x 13' 9" ( 2.95m x 4.19m )

## En-Suite Shower Room

## Bedroom Three

13' 8" x 8' 2" ( 4.17m x 2.49m )

## Loft Room / Study

14' 1" x 15' 8" ( 4.29m x 4.78m )

## Family Bathroom

## Rear Garden

## Driveway



Floor plan produced in accordance with RICS Property Measurement Standards incorporating International Property Measurement Standards (IPMS2 Residential). © nñhecom 2024. Produced for Allen & Harris. REF: 1218994

welcome to

## Church Street, Ducklington Witney

- Barn Conversion Set Within An Idyllic Location
- Kitchen/diner
- Living Room
- Three Bedrooms
- En-Suite to Bedroom two & Family Bathroom

Tenure: Freehold EPC Rating: D

guide price

**£650,000**



Please note the marker reflects the postcode not the actual property

**view this property online** [allenandharris.co.uk/Property/WIT105951](https://allenandharris.co.uk/Property/WIT105951)



Property Ref:  
WIT105951 - 0016

1. MONEY LAUNDERING REGULATIONS Intending purchasers will be asked to produce identification documentation at a later stage and we would ask for your co-operation in order that there is no delay in agreeing the sale. 2. These particulars do not constitute part or all of an offer or contract. 3. The measurements indicated are supplied for guidance only and as such must be considered incorrect. Potential buyers are advised to recheck measurements before committing to any expense. 4. We have not tested any apparatus, equipment, fixtures or services and it is in the buyers interest to check the working condition of any appliances. 5. Where an EPC, or a Home Report (Scotland only) is held for this property, it is available for inspection at the branch by appointment. If you require a printed version of a Home Report, you will need to pay a reasonable production charge reflecting printing and other costs. 6. We are not able to offer an opinion either written or verbal on the content of these reports and this must be obtained from your legal representative. 7. Whilst we take care in preparing these reports, a buyer should ensure that his/her legal representative confirms as soon as possible all matters relating to title including the extent and boundaries of the property and other important matters before exchange of contracts.

Allen & Harris is a trading name of Sequence (UK) Limited which is registered in England and Wales under company number 4268443, Registered Office is Cumbria House, 16-20 Hockliffe Street, Leighton Buzzard, Bedfordshire, LU7 1GN. VAT Registration Number is 500 2481 05.

 **allen & harris**



**01993 705915**



[witney@allenandharris.co.uk](mailto:witney@allenandharris.co.uk)



54 Market Square, WITNEY, Oxfordshire, OX28 6AF



**[allenandharris.co.uk](https://allenandharris.co.uk)**