



**Marriotts Walk, Witney OX28 6GX**

**welcome to**

**Marriotts Walk, Witney**

A second floor modern apartment located within the centre of Witney in the Marriotts Walk development. One double bedroom, bathroom and an open plan lounge/kitchen/diner and bathroom. Allocated parking. No onward chain.



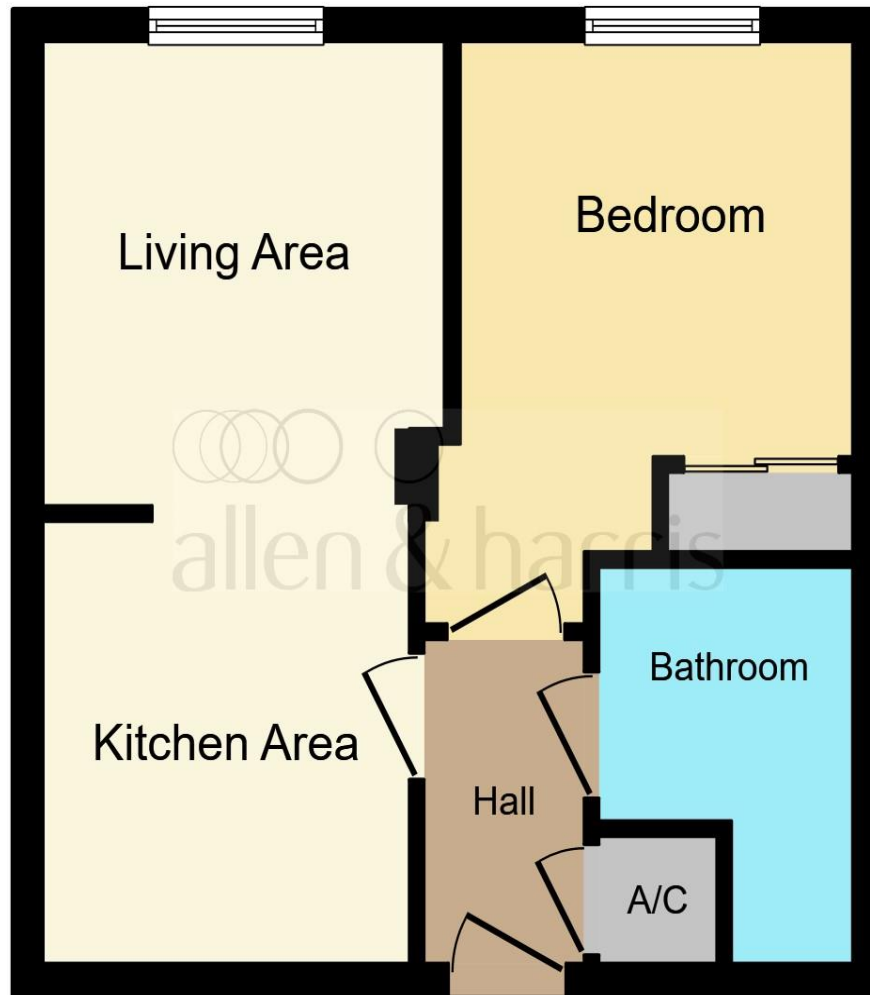

**Kitchen/ Diner**

18' 10" x 8' 10" (5.74m x 2.69m)

**Bedroom One**

11' 1" max x 8' 8" (3.38m max x 2.64m)

**Bathroom**

8' 2" max x 5' 11" (2.49m max x 1.80m)

This floorplan is for illustrative purposes only and is not drawn to scale. Measurements, floor-areas, openings and orientations are approximate. They should not be relied upon for any purpose and do not form any part of an agreement. No liability is taken for any error or mis-statement. All parties must rely on their own inspections.

welcome to

## Marriotts Walk, Witney

- Town centre location
- Double bedroom
- Open plan living
- Allocated parking
- End of Chain

Tenure: Leasehold EPC Rating: C

This is a Leasehold property. We are awaiting further details about the Term of the lease. For further information please contact the branch. Please note additional fees could be incurred for items such as Leasehold packs.

# £190,000



Please note the marker reflects the postcode not the actual property

**view this property online** [allenandharris.co.uk/Property/WIT104384](https://www.allenandharris.co.uk/Property/WIT104384)



Property Ref:  
WIT104384 - 0003

1. MONEY LAUNDERING REGULATIONS Intending purchasers will be asked to produce identification documentation at a later stage and we would ask for your co-operation in order that there is no delay in agreeing the sale. 2. These particulars do not constitute part or all of an offer or contract. 3. The measurements indicated are supplied for guidance only and as such must be considered incorrect. Potential buyers are advised to recheck measurements before committing to any expense. 4. We have not tested any apparatus, equipment, fixtures or services and it is in the buyers interest to check the working condition of any appliances. 5. Where an EPC, or a Home Report (Scotland only) is held for this property, it is available for inspection at the branch by appointment. If you require a printed version of a Home Report, you will need to pay a reasonable production charge reflecting printing and other costs. 6. We are not able to offer an opinion either written or verbal on the content of these reports and this must be obtained from your legal representative. 7. Whilst we take care in preparing these reports, a buyer should ensure that his/her legal representative confirms as soon as possible all matters relating to title including the extent and boundaries of the property and other important matters before exchange of contracts.

  
allen & harris



**01993 705915**



witney@allenandharris.co.uk



54 Market Square, WITNEY, Oxfordshire, OX28 6AF



**allenandharris.co.uk**