



Holloway Lane,Minster Lovell Witney OX29 0AU

welcome to

Holloway Lane, Minster Lovell Witney

Brought to the market in show home order and originally built by Bovis homes sits this spectacular five bedroom detached family residence situated within the highly popular location of Minster Lovell.

The property benefits from light and spacious accommodation throughout, as you walk through the front door you are met with space and natural light. Downstairs the property offers two spacious reception rooms with the living room boasting a log burning stove and boxed bay window, downstairs cloakroom with a shelved storage area and a study with fitted cupboards.

Then you have the truly breath taking kitchen/family room which comes with bi-fold doors which brings the outside in and offers a huge amount of natural light. Completed with a spacious utility room with a side door leading to the driveway and double garage.

To the first floor this property is equally impressive offering five bedrooms three of which have their very own en-suites. There is also a family bathroom. The current owner has also added fitted wardrobes, to the 2nd & 4th bedrooms. There is also an airing cupboard.

Outside this home offers a truly superb, secluded, private rear garden which is not overlooked. It has been beautifully maintained by the current owners and





Ground Floor



First Floor

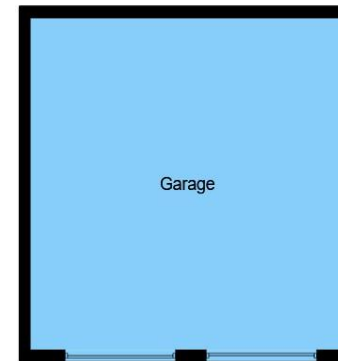

Garage

Entrance Hall

Cloakroom

Study / Play Room

11' 9" x 8' 4" (3.58m x 2.54m)

Kitchen / Family Room

25' 2" x 13' 10" (7.67m x 4.22m)

Dining Room

12' 7" x 9' (3.84m x 2.74m)

Living Room

12' 7" x 17' 7" (3.84m x 5.36m)

Utility Room

7' 6" x 6' 1" (2.29m x 1.85m)

Landing

Principle Room

13' 3" x 12' 3" (4.04m x 3.73m)

Principle En Suite

Bedroom Two

13' 3" x 11' 6" (4.04m x 3.51m)

En Suite

Bedroom Three

10' 9" x 10' 7" (3.28m x 3.23m)

En-Suite

Bedroom Four

11' 6" x 7' 4" (3.51m x 2.24m)

This floor plan is for illustrative purposes only. It is not drawn to scale. Any measurements, floor areas (including any total floor area), openings and orientation are approximate. No details are guaranteed, they cannot be relied upon for any purpose and they do not form part of any agreement. No liability is taken for any error, omission or misstatement. A party must rely upon its own inspection(s). Powered by www.focalagent.com

welcome to

Holloway Lane, Minster Lovell Witney

- Beautiful Detached Family Home
- Constructed By Bovis Homes
- Kitchen/breakfast Family Room
- Two Reception Rooms
- Five Bedrooms

Tenure: Freehold EPC Rating: B

£800,000



view this property online [allenandharris.co.uk/Property/WIT105772](https://www.allenandharris.co.uk/Property/WIT105772)



Property Ref:
WIT105772 - 0005

1. MONEY LAUNDERING REGULATIONS Intending purchasers will be asked to produce identification documentation at a later stage and we would ask for your co-operation in order that there is no delay in agreeing the sale. 2. These particulars do not constitute part or all of an offer or contract. 3. The measurements indicated are supplied for guidance only and as such must be considered incorrect. Potential buyers are advised to recheck measurements before committing to any expense. 4. We have not tested any apparatus, equipment, fixtures or services and it is in the buyers interest to check the working condition of any appliances. 5. Where an EPC, or a Home Report (Scotland only) is held for this property, it is available for inspection at the branch by appointment. If you require a printed version of a Home Report, you will need to pay a reasonable production charge reflecting printing and other costs. 6. We are not able to offer an opinion either written or verbal on the content of these reports and this must be obtained from your legal representative. 7. Whilst we take care in preparing these reports, a buyer should ensure that his/her legal representative confirms as soon as possible all matters relating to title including the extent and boundaries of the property and other important matters before exchange of contracts.

Allen & Harris is a trading name of Sequence (UK) Limited which is registered in England and Wales under company number 4268443, Registered Office is Cumbria House, 16-20 Hockliffe Street, Leighton Buzzard, Bedfordshire, LU7 1GN. VAT Registration Number is 500 2481 05.

 allen & harris



01993 705915



witney@allenandharris.co.uk



54 Market Square, WITNEY, Oxfordshire, OX28 6AF



allenandharris.co.uk

Please note the marker reflects the
postcode not the actual property