



**Northanger Road, Birmingham B27 7RG**

**welcome to**

## **Northanger Road, Birmingham**

\*\*\* NOW BEING SOLD VIA PRIVATE TREATY \*\*\* A beautifully presented three bedroom semi-detached offered CHAIN FREE, in the popular residential area of Acocks Green. The home is located within close proximity to local amenities and transport links.

### **Agents Note**

Council Tax Band B

### **Entrance Porch**

Obscure double glazed door and window to front.

### **Entrance Hall**

Door to front. Central heating radiator.

### **Lounge**

13' 10" excluding bay x 11' 8" ( 4.22m excluding bay x 3.56m )  
Double glazed bay window to front. Central heating radiator. Media wall with electric fire. Access to storage cupboard (obscure double glazed window to side).

### **Kitchen**

9' 7" plus door recess x 10' 7" ( 2.92m plus door recess x 3.23m )  
Double glazed window and door to rear. A range of wall and base units with sink and drainer. Space for free standing appliances (cooker, fridge-freezer & dishwasher). Extractor hood, tiling to splash prone areas and central heating radiator. Access to boiler.

### **Downstairs Bathroom**

Obscure double glazed window to rear. Low level toilet, hand wash basin with vanity and bath. Tiles to splash prone areas and heated towel rail. Space for free standing appliance (washing machine).

### **Landing**

Double glazed window to side. Access to loft.

### **Bedroom One**

12' 9" x 8' 2" ( 3.89m x 2.49m )  
Double glazed window to front. Central heating radiator.

### **Bedroom Two**

10' 7" x 9' 8" max ( 3.23m x 2.95m max )  
Double glazed window to front. Central heating radiator.

### **Bedroom Three**

9' 5" x 7' 8" ( 2.87m x 2.34m )  
Double glazed window to rear. Central heating radiator.

### **Shower Room**

Obscure double glazed window to front. Low level toilet, hand wash basin with pedestal and shower cubicle. Tiling to splash prone areas, heated towel rail and access to storage.

### **Rear Garden**

Patio area with side gate. Laid lawn with path and trees.

### **Outbuilding**

15' 4" x 14' 11" plus door recess ( 4.67m x 4.55m plus door recess )  
Double glazed door to front. Base units. Access to WC (Single glazed window to front. Low level toilet and hand wash basin with pedestal).

### **Parking**

Off road parking for multiple vehicles.





***view this property online*** [shipways.co.uk/Property/SLY111321](https://shipways.co.uk/Property/SLY111321)





welcome to

## Northanger Road, Birmingham

- \*\* NOW BEING SOLD VIA PRIVATE TREATY \*\*
- OFFERED CHAIN FREE
- THREE BEDROOM SEMI-DETACHED
- DOWNSTAIRS BATHROOM & UPSTAIRS SHOWER ROOM
- LOUNGE

Tenure: Freehold EPC Rating: D

offers over

**£250,000**

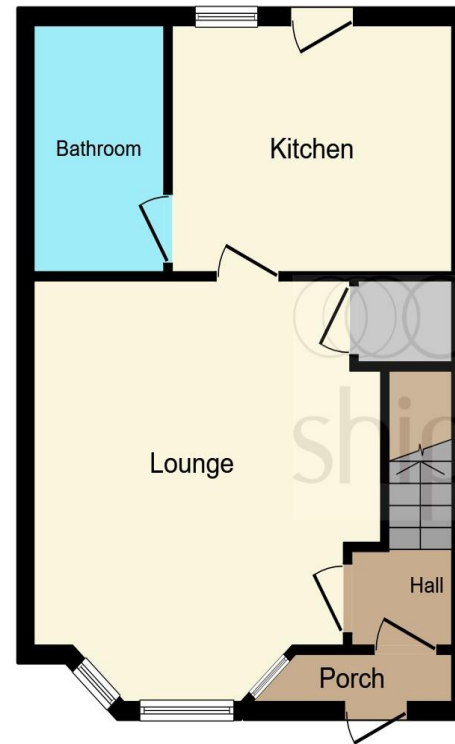

**Ground Floor**

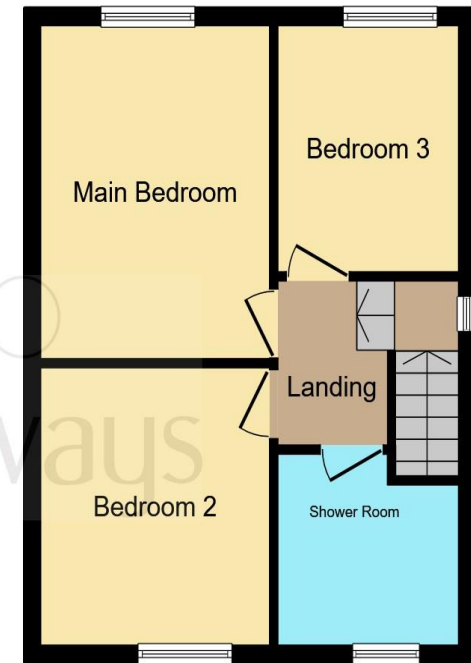

**First Floor**

This floor plan is for illustrative purposes only. It is not drawn to scale. Any measurements, floor areas (including any total floor area), openings and orientation are approximate. No details are guaranteed, they cannot be relied upon for any purpose and they do not form part of any agreement. No liability is taken for any error, omission or misstatement. A party must rely upon its own inspection(s). Powered by [www.focalagent.com](http://www.focalagent.com)

**view this property online** [shipways.co.uk/Property/SLY111321](http://shipways.co.uk/Property/SLY111321)



Property Ref:  
SLY111321 - 0006

1. MONEY LAUNDERING REGULATIONS Intending purchasers will be asked to produce identification documentation at a later stage and we would ask for your co-operation in order that there is no delay in agreeing the sale. 2. These particulars do not constitute part or all of an offer or contract. 3. The measurements indicated are supplied for guidance only and as such must be considered incorrect. Potential buyers are advised to recheck measurements before committing to any expense. 4. We have not tested any apparatus, equipment, fixtures or services and it is in the buyers interest to check the working condition of any appliances. 5. Where an EPC, or a Home Report (Scotland only) is held for this property, it is available for inspection at the branch by appointment. If you require a printed version of a Home Report, you will need to pay a reasonable production charge reflecting printing and other costs. 6. We are not able to offer an opinion either written or verbal on the content of these reports and this must be obtained from your legal representative. 7. Whilst we take care in preparing these reports, a buyer should ensure that his/her legal representative confirms as soon as possible all matters relating to title including the extent and boundaries of the property and other important matters before exchange of contracts.

Shipways is a trading name of Sequence (UK) Limited which is registered in England and Wales under company number 4268443, Registered Office is Cumbria House, 16-20 Hockliffe Street, Leighton Buzzard, Bedfordshire, LU7 1GN. VAT Registration Number is 500 2481 05.



**0121 744 4595**



[shirley@shipways.co.uk](mailto:shirley@shipways.co.uk)



208 Stratford Road, Shirley, SOLIHULL, West Midlands, B90 3AG



**[shipways.co.uk](http://shipways.co.uk)**