



**Dove Tree Court Stratford Road, Shirley Solihull B90 3AR**

**welcome to**

## **Dove Tree Court Stratford Road, Shirley Solihull**

BUYER'S INCENTIVES AVAILABLE. Shipways are delighted to offer this two-bedroom upper floor retirement apartment for people aged 60 or over, situated in the sought after area of Shirley. The well-presented apartment is CHAIN FREE and ideal for someone looking for comfort and convenience.

### **Agent Note**

The Council Tax Band is C.

### **Entrance Porch**

Secure communal entrance with stairs and lift access to upper floors.

### **Entrance Hall**

Door to front. Access to storage (housing water tank) and access to alarm pull chord.

### **Lounge-Diner**

Irregular Shaped Room x ( x )

(Not measured, please ensure it meets your requirements) Double glazed window to rear and side. Double glazed door to rear with balcony. Electric fire.

### **Kitchen**

Irregular Shaped Room x ( x )

(Not measured, please ensure it meets your requirements) Double glazed window to rear. A range of wall and base units with sink and drainer. Integrated appliances (oven, electric hob and fridge-freezer) Extractor hood over and tiling to splash prone areas.

### **Bedroom One**

19' 10" x 13' 5" ( 6.05m x 4.09m )

Double glazed door to rear with balcony. Access to storage cupboard.

### **Ensuite**

Low level toilet, wall mounted hand wash basin with vanity unit and bath with rail. Floor to ceiling tiles and heated towel rail.

### **Bedroom Two**

19' 11" x 9' 6" ( 6.07m x 2.90m )

Double glazed window to rear. Fitted wardrobe.

### **Bathroom**

Low level toilet, wall mounted hand wash basin with vanity unit and walk in shower with rail. Tiling to splash prone areas and heated towel rail.





***view this property online*** [shipways.co.uk/Property/SLY111230](https://shipways.co.uk/Property/SLY111230)





welcome to

## Dove Tree Court Stratford Road, Shirley Solihull

- BUYER'S INCENTIVES AVAILABLE
- OVER 60'S RETIREMENT APARTMENT
- NO ONWARD CHAIN
- KITCHEN
- MASTER BEDROOM WITH BALCONY AND ENSUITE

Tenure: Leasehold EPC Rating: C

This is a Leasehold property with details as follows; Term of Lease 125 years from 01 Jun 2013. Should you require further information please contact the branch. Please Note additional fees could be incurred for items such as Leasehold packs.

**£230,000**

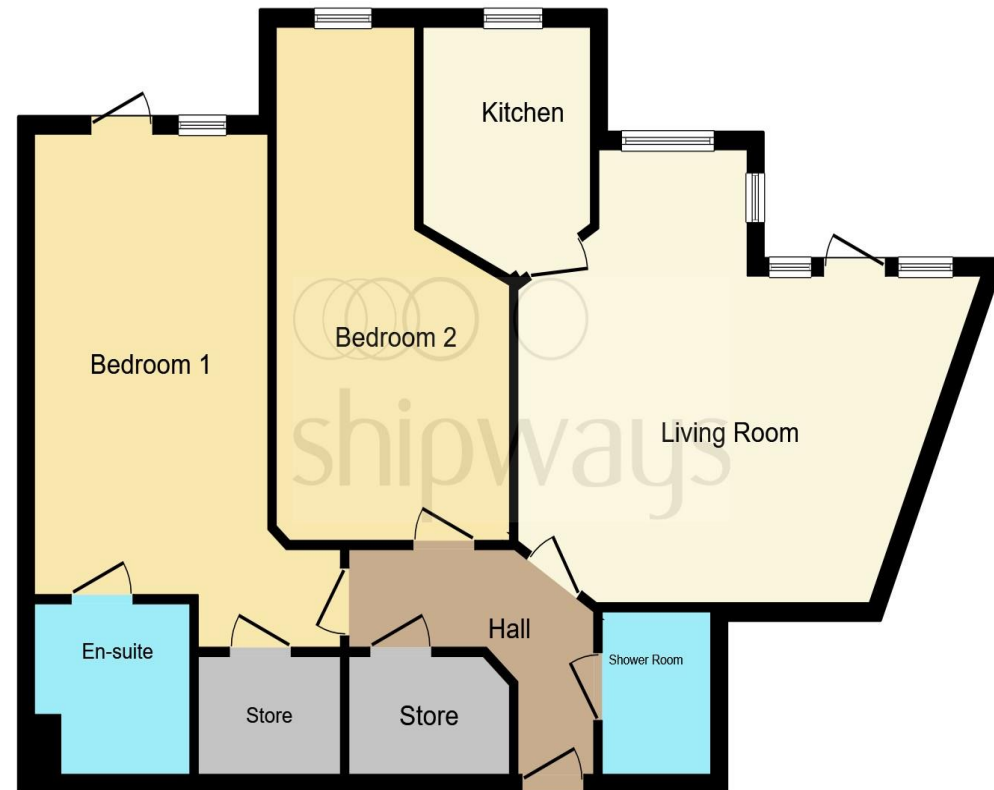

This floor plan is for illustrative purposes only. It is not drawn to scale. Any measurements, floor areas (including any total floor area), openings and orientation are approximate. No details are guaranteed, they cannot be relied upon for any purpose and they do not form part of any agreement. No liability is taken for any error, omission or misstatement. A party must rely upon its own inspection(s). Powered by [www.focalagent.com](http://www.focalagent.com)

**view this property online** [shipways.co.uk/Property/SLY111230](http://shipways.co.uk/Property/SLY111230)



Property Ref:  
SLY111230 - 0011

1. MONEY LAUNDERING REGULATIONS Intending purchasers will be asked to produce identification documentation at a later stage and we would ask for your co-operation in order that there is no delay in agreeing the sale. 2. These particulars do not constitute part or all of an offer or contract. 3. The measurements indicated are supplied for guidance only and as such must be considered incorrect. Potential buyers are advised to recheck measurements before committing to any expense. 4. We have not tested any apparatus, equipment, fixtures or services and it is in the buyers interest to check the working condition of any appliances. 5. Where an EPC, or a Home Report (Scotland only) is held for this property, it is available for inspection at the branch by appointment. If you require a printed version of a Home Report, you will need to pay a reasonable production charge reflecting printing and other costs. 6. We are not able to offer an opinion either written or verbal on the content of these reports and this must be obtained from your legal representative. 7. Whilst we take care in preparing these reports, a buyer should ensure that his/her legal representative confirms as soon as possible all matters relating to title including the extent and boundaries of the property and other important matters before exchange of contracts.

Shipways is a trading name of Sequence (UK) Limited which is registered in England and Wales under company number 4268443, Registered Office is Cumbria House, 16-20 Hockliffe Street, Leighton Buzzard, Bedfordshire, LU7 1GN. VAT Registration Number is 500 2481 05.



**0121 744 4595**



[shirley@shipways.co.uk](mailto:shirley@shipways.co.uk)



208 Stratford Road, Shirley, SOLIHULL, West  
Midlands, B90 3AG



**[shipways.co.uk](http://shipways.co.uk)**