



Barford Road, Shirley Solihull B90 3QR

welcome to

Barford Road, Shirley Solihull

A well presented three bedroom mid-terrace situated in the sought after area of Shirley. The home is an ideal opportunity for First Time Buyers to get onto the property ladder within close proximity to local amenities and transport links.

Agent Note

The Council Tax Band is B.

Entrance Hall

Obscure double glazed door to front. Central heating radiator and access to storage cupboard.

Lounge-Diner

19' 10" x 11' 10" (6.05m x 3.61m)

Double glazed window to front and rear. Central heating radiator and gas fire.

Kitchen

11' 6" plus door recess x 8' (3.51m plus door recess x 2.44m)

Double glazed window and obscure double glazed door to rear. A range of wall and base units with sink and drainer. Integrated appliances (oven & fridge-freezer). Gas hob with splashback and extractor hood over. Space for free standing appliances (washing machine). Central heating radiator.

Landing

Access to loft and storage cupboard (housing the boiler).

Bedroom One

13' 1" max x 11' 2" (3.99m max x 3.40m)

Double glazed window to front. Central heating radiator.

Bedroom Two

13' 1" x 8' 3" (3.99m x 2.51m)

Double glazed window to rear. Central heating radiator.

Bedroom Three

8' 5" x 6' 2" (2.57m x 1.88m)

Double glazed window to front. Central heating radiator and access to storage cupboard.

Bathroom

Obscure double glazed window to rear. Hand wash basin with pedestal and bath with screen and wall mounted shower.

Wc

Obscure double glazed window to rear. Low level toilet.

Front Garden

Laid lawn with hedge and path to approach the main residence.

Rear Garden

Patio area with laid lawn, access to brick built shed, space for greenhouse and side gate access.





view this property online shipways.co.uk/Property/SLY110418



welcome to

Barford Road, Shirley Solihull

- OFFERED CHAIN FREE
- THREE BEDROOM MID-TERRACE
- LOUNGE-DINER
- KITCHEN
- BATHROOM WITH SEPARATE WC

Tenure: Freehold EPC Rating: C

£300,000

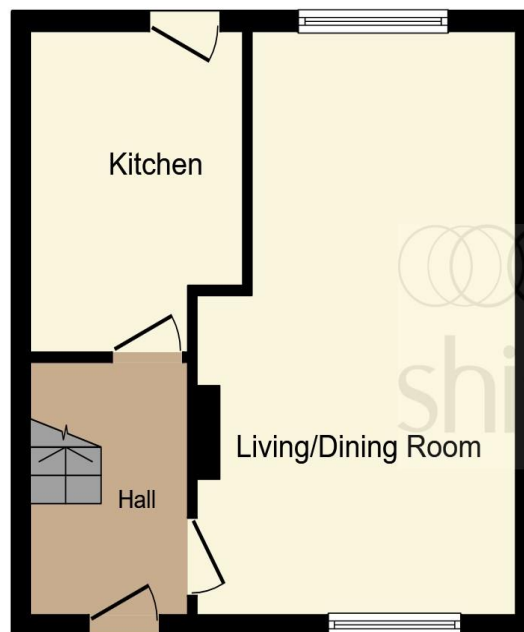

Ground Floor



First Floor

This floor plan is for illustrative purposes only. It is not drawn to scale. Any measurements, floor areas (including any total floor area), openings and orientation are approximate. No details are guaranteed, they cannot be relied upon for any purpose and they do not form part of any agreement. No liability is taken for any error, omission or misstatement. A party must rely upon its own inspection(s). Powered by www.focalagent.com

view this property online shipways.co.uk/Property/SLY110418



Property Ref:
SLY110418 - 0004

1. MONEY LAUNDERING REGULATIONS Intending purchasers will be asked to produce identification documentation at a later stage and we would ask for your co-operation in order that there is no delay in agreeing the sale. 2. These particulars do not constitute part or all of an offer or contract. 3. The measurements indicated are supplied for guidance only and as such must be considered incorrect. Potential buyers are advised to recheck measurements before committing to any expense. 4. We have not tested any apparatus, equipment, fixtures or services and it is in the buyers interest to check the working condition of any appliances. 5. Where an EPC, or a Home Report (Scotland only) is held for this property, it is available for inspection at the branch by appointment. If you require a printed version of a Home Report, you will need to pay a reasonable production charge reflecting printing and other costs. 6. We are not able to offer an opinion either written or verbal on the content of these reports and this must be obtained from your legal representative. 7. Whilst we take care in preparing these reports, a buyer should ensure that his/her legal representative confirms as soon as possible all matters relating to title including the extent and boundaries of the property and other important matters before exchange of contracts.

Shipways is a trading name of Sequence (UK) Limited which is registered in England and Wales under company number 4268443, Registered Office is Cumbria House, 16-20 Hockliffe Street, Leighton Buzzard, Bedfordshire, LU7 1GN. VAT Registration Number is 500 2481 05.



0121 744 4595



shirley@shipways.co.uk



208 Stratford Road, Shirley, SOLIHULL, West Midlands, B90 3AG



shipways.co.uk