



**Bosworth Road, Birmingham B26 1EY**

**welcome to**

## **Bosworth Road, Birmingham**

A deceptively spacious, traditional three bedroom semi-detached, situated in a popular residential area of Birmingham. The home requires modernisation, offering a fantastic opportunity for those seeking a blank canvas with potential to create their own personal touch

### **Agent Note**

The Council Tax Band is B.

### **Entrance Hall**

Obscure double glazed door to front and obscure double glazed window to front. Central heating radiator and access to storage cupboard.

### **Reception Room**

11' 2" excluding bay x 10' 5" into recess ( 3.40m excluding bay x 3.17m into recess )  
Double glazed bay window to front. Central heating radiator.

### **Second Reception Room**

10' 10" x 10' 5" excluding recess ( 3.30m x 3.17m excluding recess )

### **Kitchen**

15' 7" x 6' 5" plus door recess ( 4.75m x 1.96m plus door recess )

Two double glazed windows to rear and double glazed door to rear. A range of wall and base units with sink and drainer. Space for free standing appliances (cooker, washing machine & fridge-freezer). Tiling to splash prone areas and access to boiler.

### **Landing**

Obscure double glazed window to side. Access to loft.

### **Bedroom One**

11' 5" excluding bay x 10' 5" into recess ( 3.48m excluding bay x 3.17m into recess )

Double glazed bay window to front. Central heating radiator.

### **Bedroom Two**

10' 11" x 10' 6" ( 3.33m x 3.20m )

Double glazed window to rear. Central heating radiator.

### **Bedroom Three**

7' 7" x 5' 8" ( 2.31m x 1.73m )

Double glazed window to front. Central heating radiator.

### **Bathroom**

Obscure double glazed window to rear. Low level toilet, hand wash basin with pedestal and bath with wall mounted electric shower over. Central heating radiator and tiling to splash prone areas.

### **Rear Garden**

Patio, laid lawn and bushes.

### **Parking**

Off road parking for multiple vehicles.





***view this property online*** [shipways.co.uk/Property/SLY111186](http://shipways.co.uk/Property/SLY111186)



welcome to

## Bosworth Road, Birmingham

- TRADITIONAL THREE BEDROOM SEMI-DETACHED
- TWO RECEPTION AREAS
- KITCHEN
- BATHROOM
- REAR GARDEN

Tenure: Freehold EPC Rating: Awaiting

offers in the region of

**£230,000**

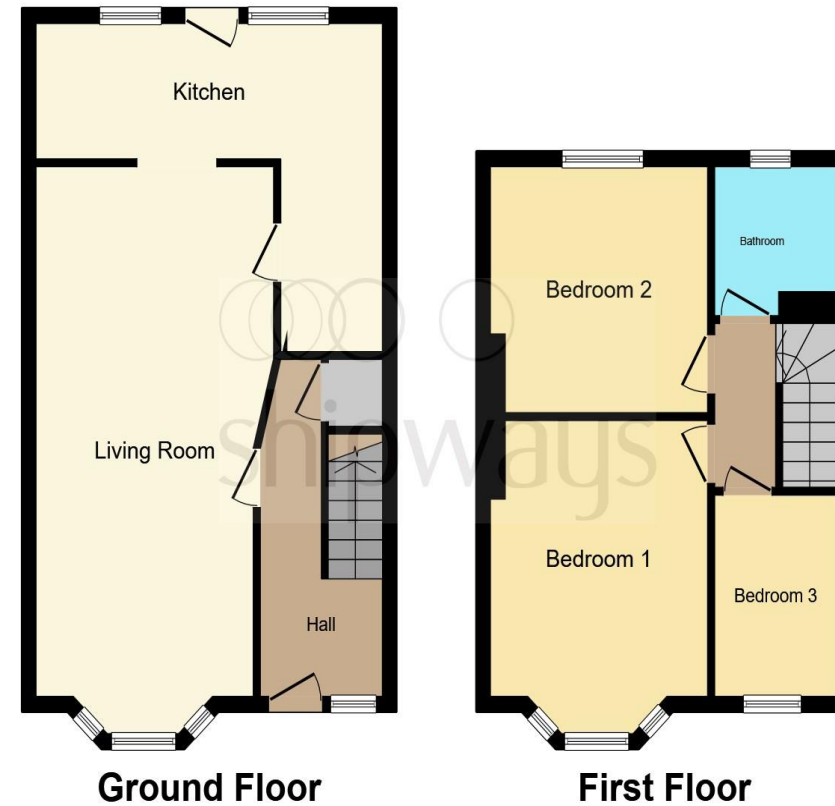

This floor plan is for illustrative purposes only. It is not drawn to scale. Any measurements, floor areas (including any total floor area), openings and orientation are approximate. No details are guaranteed, they cannot be relied upon for any purpose and they do not form part of any agreement. No liability is taken for any error, omission or misstatement. A party must rely upon its own inspection(s). Powered by [www.focalagent.com](http://www.focalagent.com)

view this property online [shipways.co.uk/Property/SLY111186](http://shipways.co.uk/Property/SLY111186)



Property Ref:  
SLY111186 - 0004

1. MONEY LAUNDERING REGULATIONS Intending purchasers will be asked to produce identification documentation at a later stage and we would ask for your co-operation in order that there is no delay in agreeing the sale. 2. These particulars do not constitute part or all of an offer or contract. 3. The measurements indicated are supplied for guidance only and as such must be considered incorrect. Potential buyers are advised to recheck measurements before committing to any expense. 4. We have not tested any apparatus, equipment, fixtures or services and it is in the buyers interest to check the working condition of any appliances. 5. Where an EPC, or a Home Report (Scotland only) is held for this property, it is available for inspection at the branch by appointment. If you require a printed version of a Home Report, you will need to pay a reasonable production charge reflecting printing and other costs. 6. We are not able to offer an opinion either written or verbal on the content of these reports and this must be obtained from your legal representative. 7. Whilst we take care in preparing these reports, a buyer should ensure that his/her legal representative confirms as soon as possible all matters relating to title including the extent and boundaries of the property and other important matters before exchange of contracts.

Shipways is a trading name of Sequence (UK) Limited which is registered in England and Wales under company number 4268443, Registered Office is Cumbria House, 16-20 Hockliffe Street, Leighton Buzzard, Bedfordshire, LU7 1GN. VAT Registration Number is 500 2481 05.

  
shipways



**0121 744 4595**



[shirley@shipways.co.uk](mailto:shirley@shipways.co.uk)



208 Stratford Road, Shirley, SOLIHULL, West Midlands, B90 3AG



[shipways.co.uk](http://shipways.co.uk)