



**Rivendell Court Stratford Road, Hall Green Birmingham B28  
8AT**

**welcome to**

## **Rivendell Court Stratford Road, Hall Green Birmingham**

A well presented two bedroom retirement apartment available for over 60's in the popular residential block of Rivendell Court in Hall Green. The property is offered with NO ONWARD CHAIN and has an emergency pull chord system and access to communal facilities such as the lounge and garden.

### **Agent Note**

The Council Tax Band is C. The length of the lease is 125 years from 1st May 1999. We are informed the annual ground rent is £777.90 and the annual service charge is £4247.24.

### **Entrance Porch**

Open canopy porch.

### **Secure Communal Entrance**

Secure communal door with access to lifts and stairs to upper floors.

### **Communal Area**

Access to communal lounge.

### **Entrance Hall**

Door to front. Electric heater.

### **Lounge**

19' 7" x 11' 10" ( 5.97m x 3.61m )

Double glazed window to rear. Electric heater and fireplace. Alarm Chord.

### **Kitchen**

8' 8" x 5' 5" ( 2.64m x 1.65m )

Double glazed window to rear. A range of wall and base units with sink and drainer. Integrated appliances (oven & gas hob). Space for free standing appliances (fridge). Tiling to splash prone areas.

### **Bedroom One**

22' 4" x 17' 6" ( 6.81m x 5.33m )

Two double glazed windows to rear. Electric heater. Built-in-wardrobes and alarm chord.

### **Bedroom Two**

10' 6" x 8' 9" ( 3.20m x 2.67m )

Double glazed window to rear. Electric heater and alarm chord.

### **Bathroom**

Low level toilet, hand wash basin with vanity unit and bath with screen and wall mounted shower over. Tiling to splash prone areas and alarm chord.



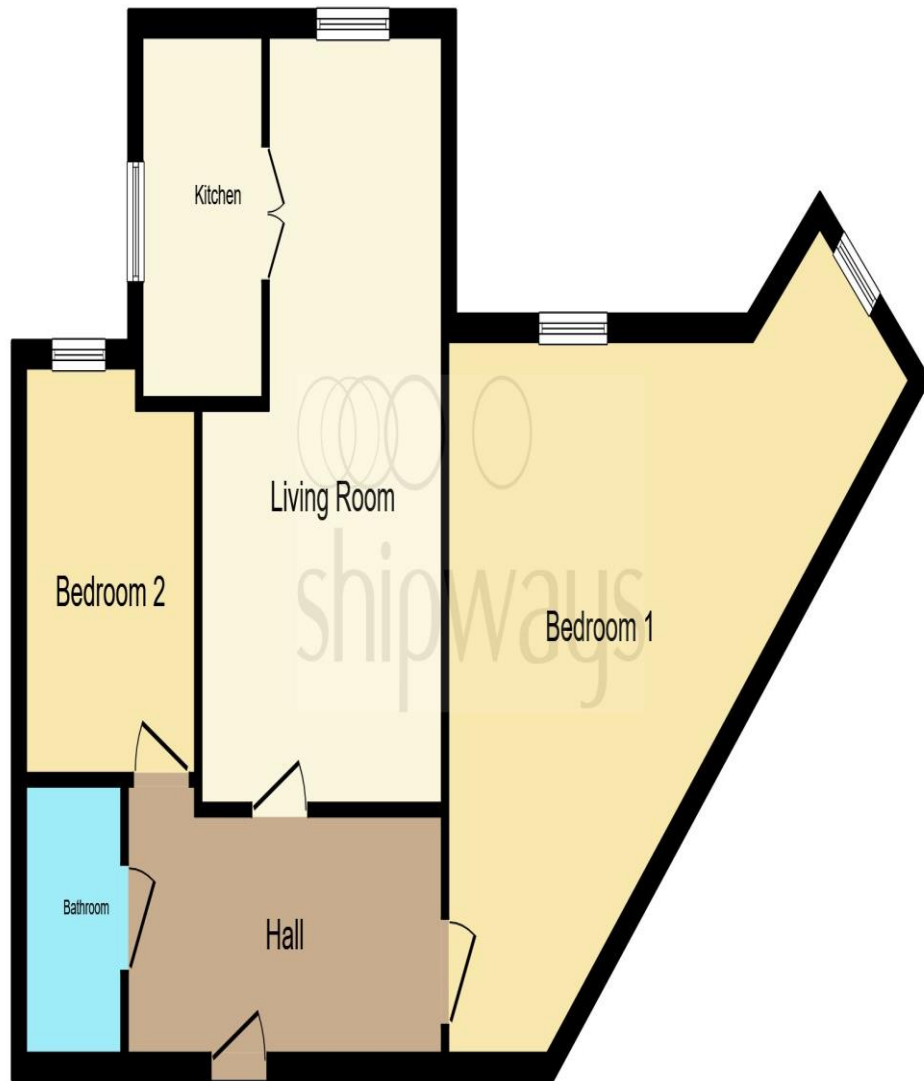

This floor plan is for illustrative purposes only. It is not drawn to scale. Any measurements, floor areas (including any total floor area), openings and orientation are approximate. No details are guaranteed, they cannot be relied upon for any purpose and they do not form part of any agreement. No liability is taken for any error, omission or misstatement. A party must rely upon its own inspection(s). Powered by [www.focalagent.com](http://www.focalagent.com)



**welcome to**

**Rivendell Court Stratford Road,  
Hall Green Birmingham**

- NO ONWARD CHAIN
- TWO BEDROOM RETIREMENT APARTMENT
- LOUNGE
- KITCHEN
- BATHROOM

Tenure: Leasehold EPC Rating: C

This is a Leasehold property with details as follows; Term of Lease 125 years from 01 May 1999. Should you require further information please contact the branch. Please Note additional fees could be incurred for items such as Leasehold packs.

offers over

**£50,000**



**view this property online** [shipways.co.uk/Property/SLY110228](http://shipways.co.uk/Property/SLY110228)



Property Ref:  
SLY110228 - 0006

1. MONEY LAUNDERING REGULATIONS Intending purchasers will be asked to produce identification documentation at a later stage and we would ask for your co-operation in order that there is no delay in agreeing the sale. 2. These particulars do not constitute part or all of an offer or contract. 3. The measurements indicated are supplied for guidance only and as such must be considered incorrect. Potential buyers are advised to recheck measurements before committing to any expense. 4. We have not tested any apparatus, equipment, fixtures or services and it is in the buyers interest to check the working condition of any appliances. 5. Where an EPC, or a Home Report (Scotland only) is held for this property, it is available for inspection at the branch by appointment. If you require a printed version of a Home Report, you will need to pay a reasonable production charge reflecting printing and other costs. 6. We are not able to offer an opinion either written or verbal on the content of these reports and this must be obtained from your legal representative. 7. Whilst we take care in preparing these reports, a buyer should ensure that his/her legal representative confirms as soon as possible all matters relating to title including the extent and boundaries of the property and other important matters before exchange of contracts.

Shipways is a trading name of Sequence (UK) Limited which is registered in England and Wales under company number 4268443, Registered Office is Cumbria House, 16-20 Hockliffe Street, Leighton Buzzard, Bedfordshire, LU7 1GN. VAT Registration Number is 500 2481 05.



**0121 744 4595**



[shirley@shipways.co.uk](mailto:shirley@shipways.co.uk)



208 Stratford Road, Shirley, SOLIHULL, West  
Midlands, B90 3AG



**[shipways.co.uk](http://shipways.co.uk)**