



Gracemere Crescent, Birmingham B28 0TZ

Not for marketing purposes INTERNAL USE ONLY

welcome to

Gracemere Crescent, Birmingham

A well presented three bedroom mid-terrace, situated in the popular residential area of Hall Green. The home is ideal for a First Time Buyer looking to get onto the property ladder or an investment opportunity. The property is within close proximity to local schools, shops and transport links.

Agent Note

The Council Tax Band is B.

Entrance Hall

Obscure double glazed door to front. Central heating radiator.

Lounge

13' 2" excluding bay x 12' 4" max (4.01m excluding bay x 3.76m max)

Double glazed bay window to front. Central heating radiator.

Kitchen

12' 7" x 8' 11" plus door recess (3.84m x 2.72m plus door recess)

Obscure double glazed door to rear. Double glazed window to rear. A range of wall and base units with sink and drainer. Integrated appliances (oven, gas hob and extractor hood over). Space for free standing appliances (washing machine, dishwasher & fridge-freezer). Central heating radiator and access to boiler.

Guest Wc

Obscure double glazed window to rear. Low level toilet, hand wash basin with vanity unit. Central heating radiator and tiling to splash prone areas. Space for free standing appliances (tumble drier).

Landing

Access to loft

Bedroom One

11' 10" max x 11' 2" (3.61m max x 3.40m)

Double glazed window to front. Central heating radiator.

Bedroom Two

11' 2" x 9' 10" max (3.40m x 3.00m max)

Double glazed window to rear. Central heating radiator.

Bedroom Three

8' x 6' 1" (2.44m x 1.85m)

Double glazed window to front. Central heating radiator.

Bathroom

Obscure double glazed window to rear. Low level toilet, hand wash basin with pedestal and bath with screen and wall mounted shower over. Heated towel rail and tiling to splash prone areas.

Front Garden

Steps up to a path with laid lawn and gravel.

Rear Garden

Patio area with fence and gate to laid lawn. Space for shed and side gate access.





check out more properties at shipways.co.uk



welcome to

Gracemere Crescent, Birmingham

- OFFERED CHAIN FREE
- THREE BEDROOM MID-TERRACE
- LOUNGE-DINER
- KITCHEN
- GUEST WC

Tenure: Freehold EPC Rating: D

offers over

£260,000

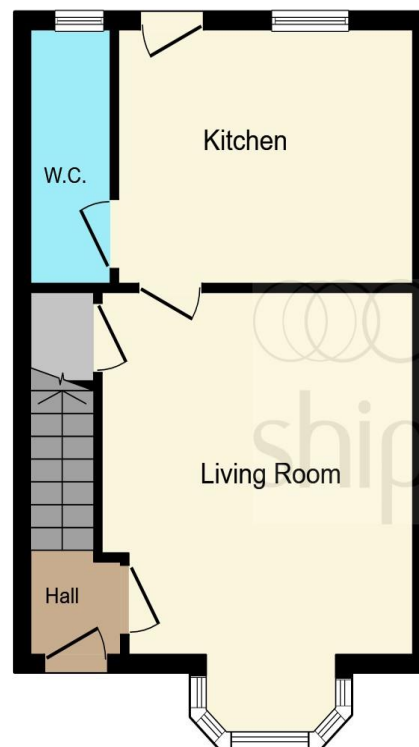

Ground Floor

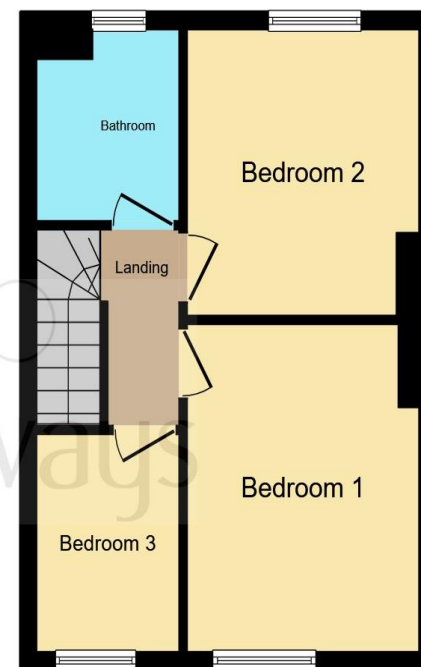

First Floor

This floor plan is for illustrative purposes only. It is not drawn to scale. Any measurements, floor areas (including any total floor area), openings and orientation are approximate. No details are guaranteed, they cannot be relied upon for any purpose and they do not form part of any agreement. No liability is taken for any error, omission or misstatement. A party must rely upon its own inspection(s). Powered by www.focalagent.com

check out more properties at shipways.co.uk



Property Ref:
SLY110937 - 0004

1. MONEY LAUNDERING REGULATIONS Intending purchasers will be asked to produce identification documentation at a later stage and we would ask for your co-operation in order that there is no delay in agreeing the sale. 2. These particulars do not constitute part or all of an offer or contract. 3. The measurements indicated are supplied for guidance only and as such must be considered incorrect. Potential buyers are advised to recheck measurements before committing to any expense. 4. We have not tested any apparatus, equipment, fixtures or services and it is in the buyers interest to check the working condition of any appliances. 5. Where an EPC, or a Home Report (Scotland only) is held for this property, it is available for inspection at the branch by appointment. If you require a printed version of a Home Report, you will need to pay a reasonable production charge reflecting printing and other costs. 6. We are not able to offer an opinion either written or verbal on the content of these reports and this must be obtained from your legal representative. 7. Whilst we take care in preparing these reports, a buyer should ensure that his/her legal representative confirms as soon as possible all matters relating to title including the extent and boundaries of the property and other important matters before exchange of contracts.

Shipways is a trading name of Sequence (UK) Limited which is registered in England and Wales under company number 4268443, Registered Office is Cumbria House, 16-20 Hockliffe Street, Leighton Buzzard, Bedfordshire, LU7 1GN. VAT Registration Number is 500 2481 05.

Not for marketing purposes INTERNAL USE ONLY



0121 744 4595



shirley@shipways.co.uk



208 Stratford Road, Shirley, SOLIHULL, West Midlands, B90 3AG



shipways.co.uk