



**Astley Close, Woodrow Redditch B98 7TZ**

**welcome to**

**Astley Close, Woodrow Redditch**

FANCY A HOUSE THAT'S WELL LOOKED AFTER ? Then come and take a look. This is a THREE bed mid Terrace in really nice condition throughout. What have you got to lose, book your viewing today !





**Ground Floor**

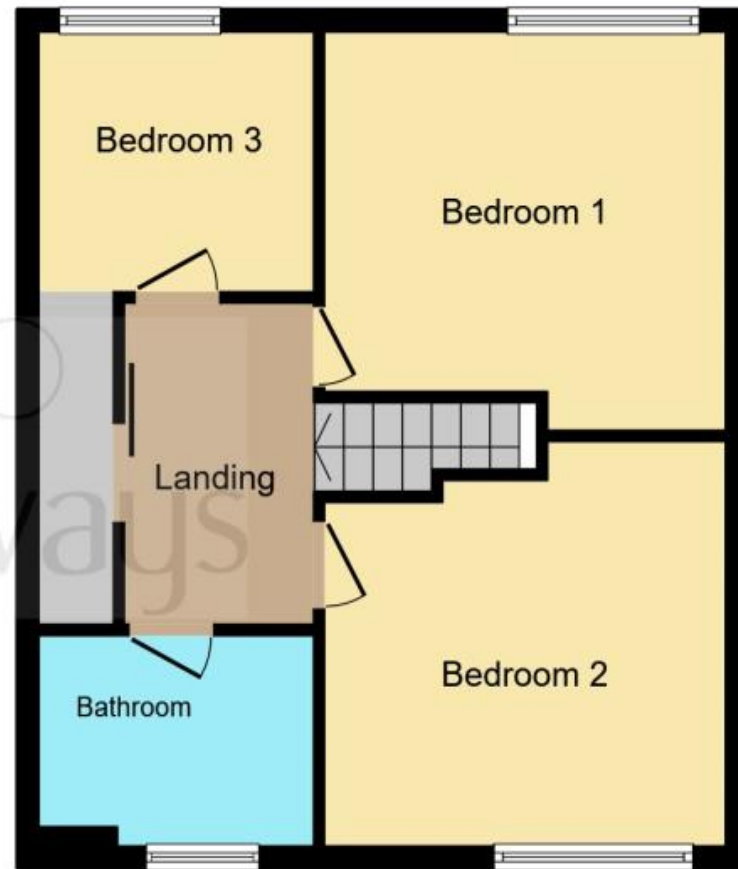

**First Floor**

This floor plan is for illustrative purposes only. It is not drawn to scale. Any measurements, floor areas (including any total floor area), openings and orientation are approximate. No details are guaranteed, they cannot be relied upon for any purpose and they do not form part of any agreement. No liability is taken for any error, omission or misstatement. A party must rely upon its own inspection(s). Powered by [www.focalagent.com](http://www.focalagent.com)

### **Approach**

via pathway leading up to double glazed door.

### **Entrance Hall**

Double glazed door to front, stairs rising to the first floor landing. central heating radiator and doors off to Kitchen Diner, Lounge and downstairs toilet.

### **Guest W.C**

Obscure window to front, low level toilet, wall mounted wash hand basin, tiling to splash prone areas.

### **Kitchen/ Diner**

13' 9" max x 12' 9" max ( 4.19m max x 3.89m max )  
Double glazed window to front, A range of wall and base units worksurface over. Sink and drainer to side. Tiling to splash prone areas. Space for oven, washing machine and fridge-freezer. Central heating radiator.

### **Lounge**

20' max x 10' 9" max ( 6.10m max x 3.28m max )  
Double glazed window to rear. Double glazed door leading to rear garden, Central heating radiator.

### **Landing**

Access to loft, storage cupboard , housing Boiler and doors off to Three bedrooms and a family bathroom.

### **Bedroom**

11' 10" max x 11' 2" max ( 3.61m max x 3.40m max )  
Double glazed window to front, recess for wardrobes and central heating radiator.

### **Bedroom**

11' 9" max x 9' 6" max ( 3.58m max x 2.90m max )  
Double glazed window to rear, recess for wardrobes, central heating radiator.

### **Bedroom**

8' 2" max x 7' 10" max ( 2.49m max x 2.39m max )  
Double glazed window to front and built in storage cupboard. Central heating radiator.

### **Bathroom**

Obscure window to front, central heating radiator, close coupled toilet, wash hand basin and pedestal. Bath with wall mounted electric shower and modern tiles to splash prone areas.

### **Rear Garden**

Feature patio area, space for a shed, surrounded with timber fence.

### **Agents Notes**

This property is non standard construction



***view this property online*** [shipways.co.uk/Property/RDC109576](http://shipways.co.uk/Property/RDC109576)



welcome to

## Astley Close, Woodrow Redditch

- MID TERRACE
- DOWNSTAIRS TOILET
- KITCHEN/DINER
- LOUNGE
- THREE BEDROOMS

Tenure: Freehold EPC Rating: C

**£190,000**



Please note the marker reflects the postcode not the actual property

**view this property online** [shipways.co.uk/Property/RDC109576](https://shipways.co.uk/Property/RDC109576)



Property Ref:  
RDC109576 - 0004

1. MONEY LAUNDERING REGULATIONS Intending purchasers will be asked to produce identification documentation at a later stage and we would ask for your co-operation in order that there is no delay in agreeing the sale. 2. These particulars do not constitute part or all of an offer or contract. 3. The measurements indicated are supplied for guidance only and as such must be considered incorrect. Potential buyers are advised to recheck measurements before committing to any expense. 4. We have not tested any apparatus, equipment, fixtures or services and it is in the buyers interest to check the working condition of any appliances. 5. Where an EPC, or a Home Report (Scotland only) is held for this property, it is available for inspection at the branch by appointment. If you require a printed version of a Home Report, you will need to pay a reasonable production charge reflecting printing and other costs. 6. We are not able to offer an opinion either written or verbal on the content of these reports and this must be obtained from your legal representative. 7. Whilst we take care in preparing these reports, a buyer should ensure that his/her legal representative confirms as soon as possible all matters relating to title including the extent and boundaries of the property and other important matters before exchange of contracts.

Shipways is a trading name of Sequence (UK) Limited which is registered in England and Wales under company number 4268443, Registered Office is Cumbria House, 16-20 Hockliffe Street, Leighton Buzzard, Bedfordshire, LU7 1GN. VAT Registration Number is 500 2481 05.



**01527 65155**



[Redditch@shipways.co.uk](mailto:Redditch@shipways.co.uk)



3 Alcester Street, REDDITCH, Worcestershire,  
B98 8AE



[shipways.co.uk](https://shipways.co.uk)