



Whetstone Street, REDDITCH B98 7WA



welcome to

Whetstone Street, REDDITCH

Three bed semi detached house, offering a hall, downstairs w/c, lounge, kitchen, landing, master bedroom with ENSUITE, Two further bedrooms and a family bathroom. Front and rear gardens, Off road parking

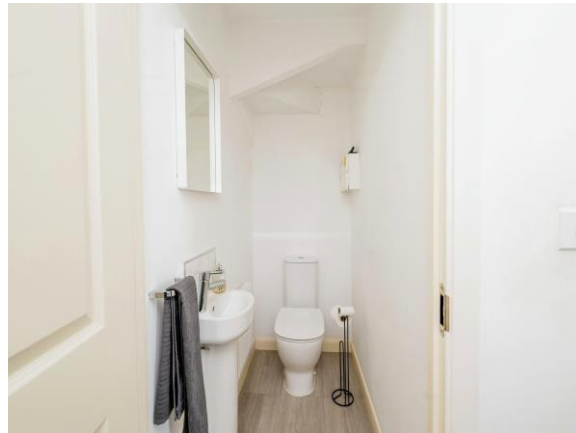



Ground Floor

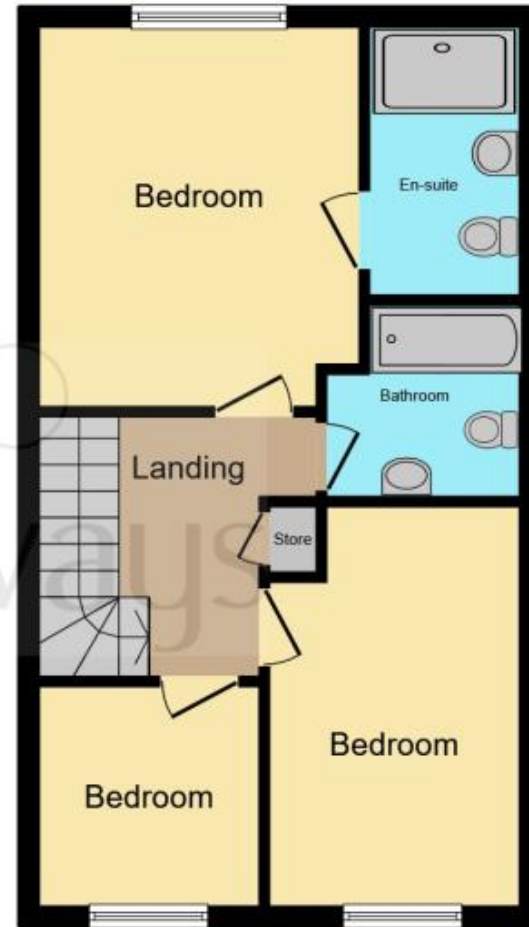

First Floor

This floorplan is for illustrative purposes only and is not drawn to scale. Measurements, floor-areas, openings and orientations are approximate. They should not be relied upon for any purpose and do not form any part of an agreement. No liability is taken for any error or mis-statement. All parties must rely on their own inspections.

Hall

Radiator. Door to

Downstairs Toilet

(Restricted Head Height). Sink, pedestal and mixer tap over. Close coupled toilet. Tiling to splash prone areas. Radiator.

Lounge

16' 5" max into bay x 12' 2" max into recess (5.00m max into bay x 3.71m max into recess)
Double glazed bay window to front. Door to understairs storage cupboard. Two radiators.

Inner Hall

Stairs to upper accommodation. Radiator.

Kitchen

15' 5" max x 11' max (4.70m max x 3.35m max)
Double glazed window and double glazed doors to rear give access to rear garden. A range of fitted wall and base units with roll top work surface over.
Stainless steel sink with mixer tap over and drainer to side. Fitted oven, hob and extractor over. Stainless steel splash back. Space for washing machine.
Radiator.

Landing

Loft access. Door to storage cupboard. Doors off to

Bedroom One

10' 8" max into recess x 9' 7" max into recess (3.25m max into recess x 2.92m max into recess)
Two double glazed windows to rear. Over stairs storage area. Radiator. Door to

Ensuite

Obscure double glazed window to side. White suite comprising of shower tray and wall mounted shower over with sliding screen. Sink and pedestal with mixer tap over. Close coupled toilet. Heated towel rail.

Bedroom Two

13' 1" max into recess x 8' 1" max into recess (3.99m max into recess x 2.46m max into recess)

Double glazed window to front. Radiator.

Bedroom Three

7' 5" max into recess x 7' 2" max (2.26m max into recess x 2.18m max)
Double glazed window to front. Radiator.

Bathroom

Obscure double glazed window to side. White suite comprising of panelled bath with mixer tap over. Close coupled toilet. Sink with pedestal and mixer tap over. Tiling to splash prone areas.

Rear Garden

Paved patio. Fence to sides and rear. Wall to side. Laid lawn. Gravelled bed.



view this property online shipways.co.uk/Property/RDC109238



welcome to

Whetstone Street, REDDITCH

- THREE BED SEMI DETACHED HOUSE
- DOWNSTAIRS WC
- LOUNGE
- KITCHEN
- FAMILY BATHROOM

Tenure: Freehold EPC Rating: B

£300,000



view this property online shipways.co.uk/Property/RDC109238

Please note the marker reflects the postcode not the actual property



Property Ref:
RDC109238 - 0008

1. MONEY LAUNDERING REGULATIONS Intending purchasers will be asked to produce identification documentation at a later stage and we would ask for your co-operation in order that there is no delay in agreeing the sale. 2. These particulars do not constitute part or all of an offer or contract. 3. The measurements indicated are supplied for guidance only and as such must be considered incorrect. Potential buyers are advised to recheck measurements before committing to any expense. 4. We have not tested any apparatus, equipment, fixtures or services and it is in the buyers interest to check the working condition of any appliances. 5. Where an EPC, or a Home Report (Scotland only) is held for this property, it is available for inspection at the branch by appointment. If you require a printed version of a Home Report, you will need to pay a reasonable production charge reflecting printing and other costs. 6. We are not able to offer an opinion either written or verbal on the content of these reports and this must be obtained from your legal representative. 7. Whilst we take care in preparing these reports, a buyer should ensure that his/her legal representative confirms as soon as possible all matters relating to title including the extent and boundaries of the property and other important matters before exchange of contracts.

shipways



01527 65155



Redditch@shipways.co.uk



3 Alcester Street, REDDITCH, Worcestershire,
B98 8AE



shipways.co.uk