



Charles Avenue, Stoke Gifford Bristol BS34 8LW

welcome to

Charles Avenue, Stoke Gifford Bristol

Offered with no onward chain this well presented and refurbished three bedroom home is situated in the very popular Charles Avenue area of Stoke Gifford. Close to local amenities, also convenient for Bristol Parkway Train station and the M4/M5 and M32 motorway networks.

Entrance Hall

Double glazed front door with side radiator.

Living /diner

21' 1" x 10' 4" (6.43m x 3.15m)

Dual aspect double glazing, radiator

Kitchen

10' 1" x 7' 1" (3.07m x 2.16m)

Double glazed overlooking rear garden, door to rear garden, a range of wall and base units, integrated oven and hob with extractor fan over

Bedroom One

10' 7" x 10' 1" (3.23m x 3.07m)

Double glazed to front, radiator

Bedroom Two

10' 2" x 10' 1" (3.10m x 3.07m)

Double glazed to rear, radiator

Bathroom

Double glazed obscured window, radiator, storage cupboard, shower cubicle, hand wash basin, low level WC.

Bedroom Three

8' 7" x 6' 8" (2.62m x 2.03m)

Double glazed to front, radiator

Outside

Rear Garden

Paved patio leading fro the house, grass mainly laid to lawn, enclosed by boundary fence, rear access

Garage And Parking

Off-street parking to the front of the property with integral up and over door

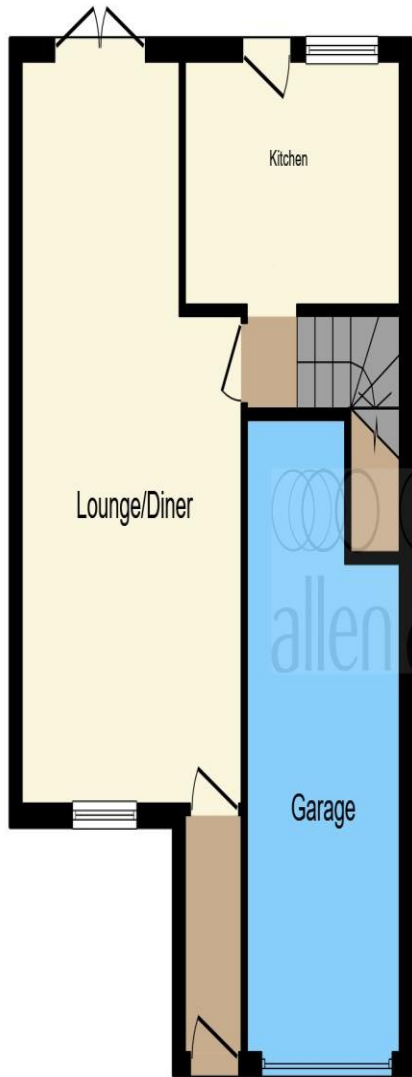

Ground Floor

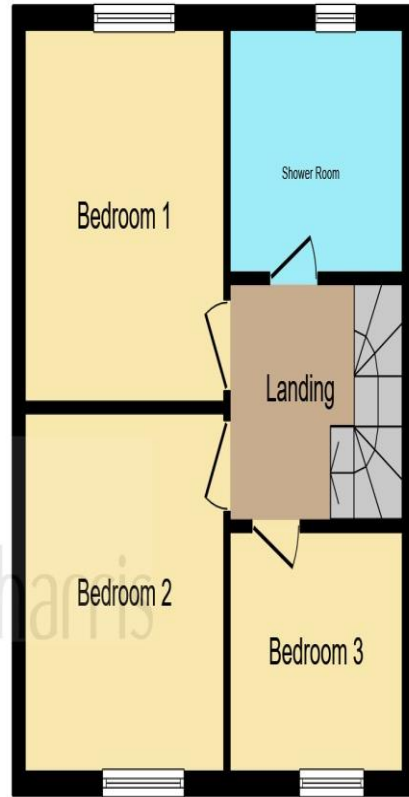

First Floor

This floorplan is for illustrative purposes only and is not drawn to scale. Measurements, floor-areas, openings and orientations are approximate. They should not be relied upon for any purpose and do not form any part of an agreement. No liability is taken for any error or mis-statement. All parties must rely on their own inspections.



welcome to
Charles Avenue,
Stoke Gifford Bristol

- NO CHAIN
- NEWLY RENOVATED
- GARAGE AND PARKING
- EPC - C
- FREEHOLD

Tenure: Freehold EPC Rating: C

from

£335,000



check out more properties at allenandharris.co.uk



Property Ref:
STG109052 - 0003

1. MONEY LAUNDERING REGULATIONS Intending purchasers will be asked to produce identification documentation at a later stage and we would ask for your co-operation in order that there is no delay in agreeing the sale. 2. These particulars do not constitute part or all of an offer or contract. 3. The measurements indicated are supplied for guidance only and as such must be considered incorrect. Potential buyers are advised to recheck measurements before committing to any expense. 4. We have not tested any apparatus, equipment, fixtures or services and it is in the buyers interest to check the working condition of any appliances. 5. Where an EPC, or a Home Report (Scotland only) is held for this property, it is available for inspection at the branch by appointment. If you require a printed version of a Home Report, you will need to pay a reasonable production charge reflecting printing and other costs. 6. We are not able to offer an opinion either written or verbal on the content of these reports and this must be obtained from your legal representative. 7. Whilst we take care in preparing these reports, a buyer should ensure that his/her legal representative confirms as soon as possible all matters relating to title including the extent and boundaries of the property and other important matters before exchange of contracts.



0117 979 8082



StokeGifford@allenandharris.co.uk



41 North Road, Stoke Gifford, BRISTOL, BS34
8PB



allenandharris.co.uk