

Colchester Avenue, Penylan Cardiff CF23 9AZ

welcome to

Colchester Avenue, Penylan Cardiff

Offered with no chain is this lovely family home, with original features, set in this sought after location of Penylan. The property is within walking distance of local shops, schools, bus routes and Waterloo Gardens. An ideal family home which deserves internal inspection. Viewing Recommended!

Ground Floor

Entrance

Via wooden obscured glazed doors into:

Porch

Original tiled flooring and walls and access via a wooden obscured glazed door with obscured glazed decorative insert giving access into:

Hallway

Stairs rising to first floor, obscured decorative window to front aspect, telephone point, radiator, wood block flooring, under stairs storage space and access to:

Lounge

16' 6" into recess x 14' 5" into bay (5.03m into recess x 4.39m into bay)

Double glazed bay window to front aspect with upper part in decorative panel glazing, radiator, picture rail and fireplace.

Dining Room

13' 9" x 13' 3" into recess (4.19m x 4.04m into recess)

Doors with decorative panel glazing providing access to lean to, feature tiled fireplace and hearth, beamed ceiling, radiator and powerpoints.

Kitchen

11' 5" Max x 10' 3" (3.48m Max x 3.12m)

Fitted with a range of wall and base level units with complementary work surfaces over, sink unit with mixer tap over, space for Range cooker, original tiled flooring, powerpoints, door to walk in pantry and window facing lean to.

Lean To

Two double glazed doors providing access to rear garden, original tiled flooring, storage cupboard and WC with door providing access to:

Utility Room

7' 6" x 6' 2" (2.29m x 1.88m)

Stainless steel sink and drainer unit, space for washing machine, powerpoints, radiator and double glazed window to rear aspect.

First Floor

Landing

Coved ceiling, picture rail and doors providing access to:

Bedroom One

14' 3" into recess x 13' 9" into bay (4.34m into recess x 4.19m into bay)

Double glazed bay window to front aspect with upper part in decorative leaded lights, tiled fireplace, radiator, powerpoints, picture rail and coved ceiling.

Bedroom Two

14' 3" into recess x 13' 10" (4.34m into recess x 4.22m)

Two double glazed windows to rear aspect, radiator, powerpoints, picture rail, tiled fireplace, radiator and coved ceiling.

Bedroom Three

10' 4" x 8' 4" (3.15m x 2.54m)

Two double glazed sash windows to front aspect with decorative leaded lights in upper part, coved ceiling, radiator and powerpoints.

Bathroom

Fitted with a four piece suite comprising panelled bath, tiled shower cubicle, pedestal wash hand basin, WC, radiator, tiled flooring, spotlights inset to ceiling and two obscure sash windows to rear aspect.

Outside

Front Forecourt

Enclosed by brick bound wall, gate providing access, paved forecourt area with borders of flowers and shrubs.

Rear Garden

Enclosed by brick bound wall, area laid to lawn and paved area. Mature trees and shrubs and access to a detached garage.

Detached Garage

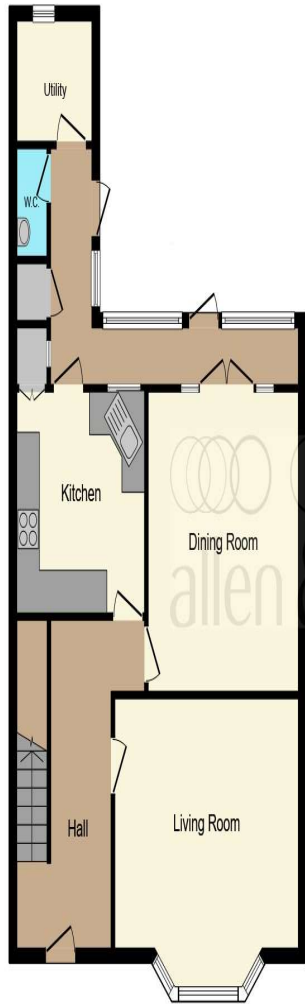

Ground Floor



First Floor

This floor plan is for illustrative purposes only. It is not drawn to scale. Any measurements, floor areas (including any total floor area), openings and orientation are approximate. No details are guaranteed, they cannot be relied upon for any purpose and they do not form part of any agreement. No liability is taken for any error, omission or misstatement. A party must rely upon its own inspection(s). Powered by www.focalagent.com



welcome to
Colchester Avenue,
Penylan Cardiff

- Traditional Double Bay Fronted Mid Terraced Home
- Three Bedrooms
- Lounge and Dining Room
- Fitted Kitchen
- Lean To and Utility Room
- First Floor Bathroom
- Front Forecourt and Rear Garden

Tenure: Freehold EPC Rating: D

offers in excess of
£500,000



check out more properties at [allenandharris.co.uk](https://www.allenandharris.co.uk)



Property Ref:
ROA113102 - 0005

1. MONEY LAUNDERING REGULATIONS Intending purchasers will be asked to produce identification documentation at a later stage and we would ask for your co-operation in order that there is no delay in agreeing the sale. 2. These particulars do not constitute part or all of an offer or contract. 3. The measurements indicated are supplied for guidance only and as such must be considered incorrect. Potential buyers are advised to recheck measurements before committing to any expense. 4. We have not tested any apparatus, equipment, fixtures or services and it is in the buyers interest to check the working condition of any appliances. 5. Where an EPC, or a Home Report (Scotland only) is held for this property, it is available for inspection at the branch by appointment. If you require a printed version of a Home Report, you will need to pay a reasonable production charge reflecting printing and other costs. 6. We are not able to offer an opinion either written or verbal on the content of these reports and this must be obtained from your legal representative. 7. Whilst we take care in preparing these reports, a buyer should ensure that his/her legal representative confirms as soon as possible all matters relating to title including the extent and boundaries of the property and other important matters before exchange of contracts.

Allen & Harris is a trading name of Sequence (UK) Limited which is registered in England and Wales under company number 4268443, Registered Office is Cumbria House, 16-20 Hockliffe Street, Leighton Buzzard, Bedfordshire, LU7 1GN. VAT Registration Number is 500 2481 05.

allen & harris



029 2046 4744



roath@allenandharris.co.uk



84 Albany Road, CARDIFF, South Glamorgan,
CF24 3RS



[allenandharris.co.uk](https://www.allenandharris.co.uk)