



**Cadleigh Gardens, Birmingham B17 0QB**

**welcome to**

## **Cadleigh Gardens, Birmingham**

\*\*\* NO UPWARD CHAIN \*\*\* B17 HARBORNE LOCATION \*\*\* WALKING DISTANCE TO QUEEN ELIZABETH HOSPITAL AND UNIVERSITY OF BIRMINGHAM \*\*\* THREE BEDROOMS \*\*\* MODERNISED THROUGHOUT \*\*\* ENCLOSED REAR GARDEN \*\*\*

### **Agent Note**

This property is council tax band B.

### **Lounge**

14' x 10' ( 4.27m x 3.05m )

Double glazed window to front.

### **Kitchen**

17' x 9' ( 5.18m x 2.74m )

Double glazed door to rear, range of wall & base units with worktops over, plumbing for utilities, extractor hood, induction hob, sink & drainer, integrated appliances - oven, microwave.

### **Landing**

Loft access.

### **Bedroom 1**

10' x 9' ( 3.05m x 2.74m )

Double glazed window to front, central heating radiator.

### **Bedroom 2**

9' x 7' ( 2.74m x 2.13m )

Double glazed window to front, central heating radiator.

### **Bedroom 3**

10' x 9' ( 3.05m x 2.74m )

Double glazed window to front, central heating radiator.

### **Bathroom**

Double glazed frosted window to rear, heated towel rail, large walk in shower, tiled to splash-prone areas, wash hand basin with mixer tap, low level flush w/c.

### **Lean To**

Ground floor, to rear. Potential to extend - subject to planning. Double glazed door to rear.

### **Rear Garden**

Enclosed, rear gate to back road.







***view this property online*** [shipways.co.uk/Property/HBN110479](https://shipways.co.uk/Property/HBN110479)



welcome to

## Cadleigh Gardens, Birmingham

- No upward chain
- B17 Harborne location
- Walking distance to QE Hospital and University of Birmingham
- Close to local amenities and schools
- Ideal first time buy

Tenure: Freehold EPC Rating: E

Council Tax Band: B

offers over

**£260,000**

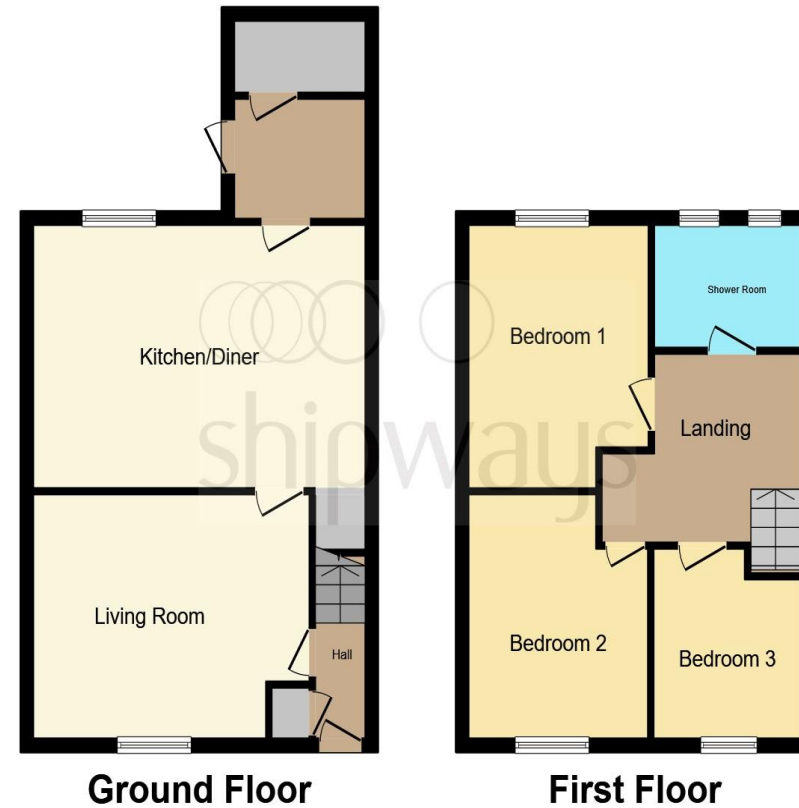

This floor plan is for illustrative purposes only. It is not drawn to scale. Any measurements, floor areas (including any total floor area), openings and orientation are approximate. No details are guaranteed, they cannot be relied upon for any purpose and they do not form part of any agreement. No liability is taken for any error, omission or misstatement. A party must rely upon its own inspection(s). Powered by [www.focalagent.com](http://www.focalagent.com)

view this property online [shipways.co.uk/Property/HBN110479](http://shipways.co.uk/Property/HBN110479)



Property Ref:  
HBN110479 - 0016

1. MONEY LAUNDERING REGULATIONS Intending purchasers will be asked to produce identification documentation at a later stage and we would ask for your co-operation in order that there is no delay in agreeing the sale. 2. These particulars do not constitute part or all of an offer or contract. 3. The measurements indicated are supplied for guidance only and as such must be considered incorrect. Potential buyers are advised to recheck measurements before committing to any expense. 4. We have not tested any apparatus, equipment, fixtures or services and it is in the buyers interest to check the working condition of any appliances. 5. Where an EPC, or a Home Report (Scotland only) is held for this property, it is available for inspection at the branch by appointment. If you require a printed version of a Home Report, you will need to pay a reasonable production charge reflecting printing and other costs. 6. We are not able to offer an opinion either written or verbal on the content of these reports and this must be obtained from your legal representative. 7. Whilst we take care in preparing these reports, a buyer should ensure that his/her legal representative confirms as soon as possible all matters relating to title including the extent and boundaries of the property and other important matters before exchange of contracts.

Shipways is a trading name of Sequence (UK) Limited which is registered in England and Wales under company number 4268443, Registered Office is Cumbria House, 16-20 Hockliffe Street, Leighton Buzzard, Bedfordshire, LU7 1GN. VAT Registration Number is 500 2481 05.



**0121 427 3264**



[harborne@shipways.co.uk](mailto:harborne@shipways.co.uk)



172 High Street, Harborne, BIRMINGHAM,  
West Midlands, B17 9PP



**[shipways.co.uk](http://shipways.co.uk)**