



Morland Place, Birmingham B31 2PF

welcome to

Morland Place, Birmingham

*** BEAUTIFULLY PRESENTED TERRACED PROPERTY *** FOUR BEDROOMS *** TWO RECEPTION ROOMS *** SPACIOUS KITCHEN/DINER *** GROUND FLOOR AND FIRST FLOOR W/C *** FAMILY BATHROOM *** EN - SUITE *** DRIVEWAY *** SECURE REAR GARDEN ***

Agent Note

This property is council tax band D.

Lounge

11' 5" x 9' 3" (3.48m x 2.82m)

Double glazed front facing bay window, central heating radiator.

Kitchen/Diner

19' 3" x 9' 3" (5.87m x 2.82m)

Double glazed Rear facing window, gas hob & electric oven, range of wall and base units with drawers and work-tops over, sink & drainer unit.

Utility Room

7' 6" x 6' 1" (2.29m x 1.85m)

central heating radiator, sink & drainer unit.

Lounge First Floor

15' 8" x 9' 8" (4.78m x 2.95m)

Double glazed rear facing window, central heating radiator.

Bedroom One First Floor

15' 7" x 14' 9" (4.75m x 4.50m)

Double glazed french doors to rear, double glazed rear facing window, central heating radiator.

Toilet First Floor

Central heating radiator, low level flush w/c, wash hand basin.

Bedroom Two Second Floor

11' 5" x 10' 4" (3.48m x 3.15m)

Double glazed front facing window, central heated radiator, fitted wardrobes and en-suite.

En-suite - double glazed window to front, shower, central heating radiator, low level flush w/c, wash hand basin.

Bedroom Three second floor

9' 8" x 8' 8" (2.95m x 2.64m)

Double glazed rear facing window, central heating radiator.

Bedroom Four Second Floor

9' 8" x 6' 6" (2.95m x 1.98m)

Double glazed rear facing window, central heating radiator.

Bathroom Second Floor

Central heating radiator, bath with shower over, low level flush w/c, wash hand basin.

Ground Floor Toilet

Central heating radiator, low level flush w/c, wash hand basin.

Rear Garden

Patio area, rear access.





view this property online shipways.co.uk/Property/HBN111114



welcome to

Morland Place, Birmingham

- Well presented terraced property
- Four bedrooms
- Ground floor and first floor W/C
- Family bathroom
- En-suite

Tenure: Freehold EPC Rating: C

offers in excess of

£315,000

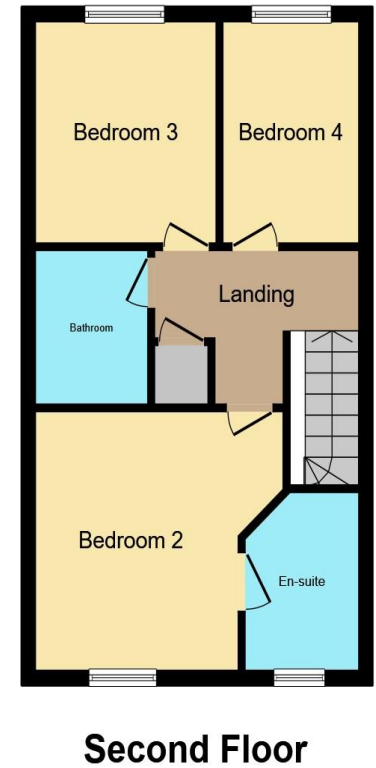
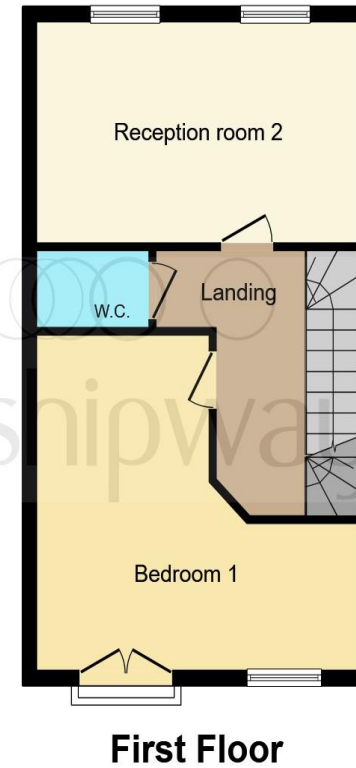
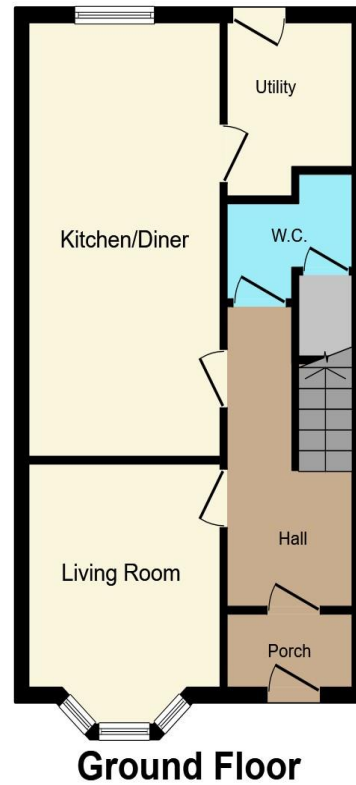

This floor plan is for illustrative purposes only. It is not drawn to scale. Any measurements, floor areas (including any total floor area), openings and orientation are approximate. No details are guaranteed, they cannot be relied upon for any purpose and they do not form part of any agreement. No liability is taken for any error, omission or misstatement. A party must rely upon its own inspection(s). Powered by www.focalagent.com

view this property online shipways.co.uk/Property/HBN111114



Property Ref:
HBN111114 - 0002

1. MONEY LAUNDERING REGULATIONS Intending purchasers will be asked to produce identification documentation at a later stage and we would ask for your co-operation in order that there is no delay in agreeing the sale. 2. These particulars do not constitute part or all of an offer or contract. 3. The measurements indicated are supplied for guidance only and as such must be considered incorrect. Potential buyers are advised to recheck measurements before committing to any expense. 4. We have not tested any apparatus, equipment, fixtures or services and it is in the buyers interest to check the working condition of any appliances. 5. Where an EPC, or a Home Report (Scotland only) is held for this property, it is available for inspection at the branch by appointment. If you require a printed version of a Home Report, you will need to pay a reasonable production charge reflecting printing and other costs. 6. We are not able to offer an opinion either written or verbal on the content of these reports and this must be obtained from your legal representative. 7. Whilst we take care in preparing these reports, a buyer should ensure that his/her legal representative confirms as soon as possible all matters relating to title including the extent and boundaries of the property and other important matters before exchange of contracts.

Shipways is a trading name of Sequence (UK) Limited which is registered in England and Wales under company number 4268443, Registered Office is Cumbria House, 16-20 Hockliffe Street, Leighton Buzzard, Bedfordshire, LU7 1GN. VAT Registration Number is 500 2481 05.



0121 427 3264



harborne@shipways.co.uk



172 High Street, Harborne, BIRMINGHAM,
West Midlands, B17 9PP



shipways.co.uk