



Markford Walk, Birmingham B19 2HD

welcome to

Markford Walk, Birmingham

Spacious two-bedroom home featuring a large lounge, generous kitchen, and a bathroom with a separate toilet. Front and rear gardens provide excellent outdoor space. Conveniently located near local amenities and transport links. Ideal for first-time buyers or investors. Book a viewing today!

Auctioneer's Comments

This property is offered through Modern Method of Auction. Should you view, offer or bid your data will be shared with the Auctioneer, iamsold Limited. This method requires both parties to complete the transaction within 56 days, allowing buyers to proceed with mortgage finance (subject to lending criteria, affordability and survey). The buyer is required to sign a reservation agreement and make payment of a non-refundable Reservation Fee of 4.5% of the purchase price including VAT, subject to a minimum of £6600.00 including VAT. This fee is paid in addition to purchase price and will be considered as part of the chargeable consideration for the property in the calculation for stamp duty liability. Buyers will be required to complete an identification process with iamsold and provide proof of how the purchase would be funded. The property has a Buyer Information Pack containing documents about the property. The documents may not tell you everything you need to know, so you must complete your own due diligence before bidding. A sample of the Reservation Agreement and terms and conditions are contained within this pack. The buyer will also make payment of no more than £349 inc. VAT towards the preparation cost of the pack. Please confirm exact costs with the auctioneer. The estate agent and auctioneer may recommend the services of other providers to you, in which they will be paid for the referral. These services are optional, and you will be advised of any payment, in writing before any services are accepted. Listing is subject to a start price and undisclosed reserve price that can change.

Agent Note

Council Tax Band A

Approach

Front garden with fence borders, path leading to door into

Porch

Double glazed window to the front, door into

Entrance Hall

Stairs to the first floor, ceiling light point, store cupboard, doors into

Lounge

13' 11" x 10' 10" (4.24m x 3.30m)

Double glazed window to the rear of the property, laminate flooring, ceiling light point, radiator

Kitchen

20' 5" x 8' 8" (6.22m x 2.64m)

Double glazed window to the front and rear of the property, a range of wall and floor cabinets with a roll top worksurface, sink and drainer, integrated dish washer, oven and gas hob, a wall mounted boiler, tiled flooring, two ceiling light points, radiator.





Landing

Double glazed window to the side of the property, loft access, storage cupboard, carpeted, ceiling light point

Bedroom One

13' 11" x 10' 9" (4.24m x 3.28m)

Double glazed window to the rear of the property, built in wardrobe, radiator, carpeted, ceiling light point

Bedroom Two

13' 11" x 9' (4.24m x 2.74m)

Double glazed rear window, carpeted, radiator, ceiling light point

Bathroom

Double glazed window to the front of the property, shower over the bath, WC, radiator

Seperate Wc

Seperate WC, Double glazed window to the front

Rear Garden

Gated, Brick built storage and lawn area



view this property online shipways.co.uk/Property/GRB111606



welcome to

Markford Walk, Birmingham

- Sale by Modern Auction (T&Cs apply)
- Subject to an undisclosed Reserve Price
- Buyers fees apply
- MID-TERRACE
- TWO BEDROOMS

Tenure: Freehold EPC Rating: D

guide price

£120,000

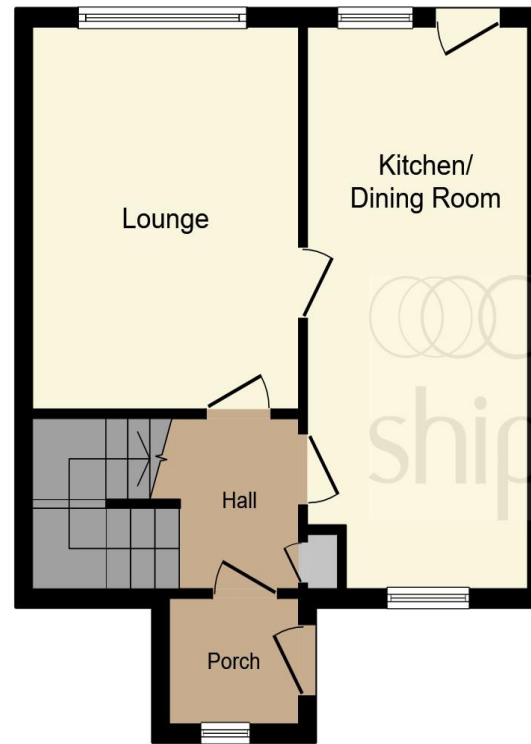

Ground Floor

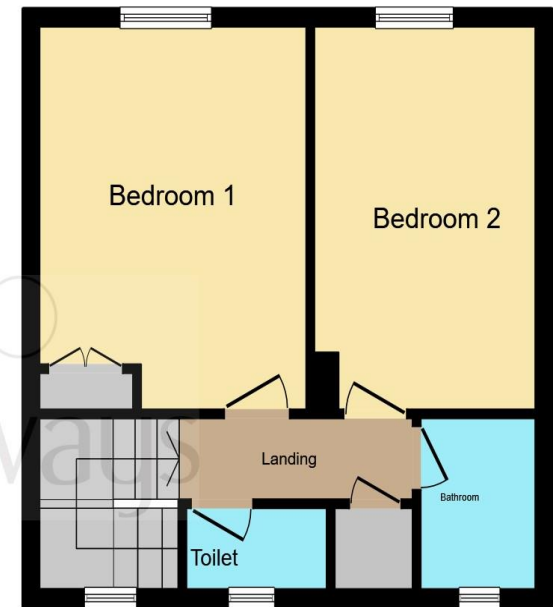

First Floor

This floor plan is for illustrative purposes only. It is not drawn to scale. Any measurements, floor areas (including any total floor area), openings and orientation are approximate. No details are guaranteed, they cannot be relied upon for any purpose and they do not form part of any agreement. No liability is taken for any error, omission or misstatement. A party must rely upon its own inspection(s). Powered by www.focalagent.com

view this property online shipways.co.uk/Property/GRB111606



Property Ref:
GRB111606 - 0002

1. MONEY LAUNDERING REGULATIONS Intending purchasers will be asked to produce identification documentation at a later stage and we would ask for your co-operation in order that there is no delay in agreeing the sale. 2. These particulars do not constitute part or all of an offer or contract. 3. The measurements indicated are supplied for guidance only and as such must be considered incorrect. Potential buyers are advised to recheck measurements before committing to any expense. 4. We have not tested any apparatus, equipment, fixtures or services and it is in the buyers interest to check the working condition of any appliances. 5. Where an EPC, or a Home Report (Scotland only) is held for this property, it is available for inspection at the branch by appointment. If you require a printed version of a Home Report, you will need to pay a reasonable production charge reflecting printing and other costs. 6. We are not able to offer an opinion either written or verbal on the content of these reports and this must be obtained from your legal representative. 7. Whilst we take care in preparing these reports, a buyer should ensure that his/her legal representative confirms as soon as possible all matters relating to title including the extent and boundaries of the property and other important matters before exchange of contracts.

Shipways is a trading name of Sequence (UK) Limited which is registered in England and Wales under company number 4268443, Registered Office is Cumbria House, 16-20 Hockliffe Street, Leighton Buzzard, Bedfordshire, LU7 1GN. VAT Registration Number is 500 2481 05.



0121 358 2281



greatbarr@shipways.co.uk



905 Walsall Road, Great Barr, BIRMINGHAM,
West Midlands, B42 1TN



shipways.co.uk