



Perry Park Crescent, BIRMINGHAM B42 2LS

welcome to

Perry Park Crescent, BIRMINGHAM

FOUR BEDROOMFREEHOLD***SEMI DETACHED***TWO RECEPTION ROOMS***LARGE GARDEN***DRIVEWAY***DOUBLE GLAZED***CENTRAL HEATING***

Agent Note D Entrance Hall

Stairs to first fload , ceiling light point, two radiators

Lounge

16' 10" x 15' 11" (5.13m x 4.85m)

Patio doors to the rear of the property, featured fire place and gas fire, radiator, two ceiling light points

Dining Room

14' 9" x 11' 9" (4.50m x 3.58m)

Patio door to rear, featured fire place, ceiling light point, radiator

Study/Bedroom Four

16' 4" x 7' 7" (4.98m x 2.31m)

Double glazed window to the front of the property, laminate floorin, ceiling light points, spot lights, radiator

Kitchen

12' x 11' (3.66m x 3.35m)

Double glazed window and UPVC door to the rear, a range of wall and base units with roll top worksurface, sink and drain, gas hob and extractor fan, double oven, plumbing for dish washer, radiator, tiled flooring, ceiling light point and fan, spot light

Utility

13' 9" x 4' 4" (4.19m x 1.32m)

Double Glazed Window to the front, UPVC door to the side, Plumbing for appliances, wall mounted boiler.





Landing

Double glazed window to the side of property, loft access, ceiling light point

Bedroom One

10' 11" x 8' 1" to wardrobe (3.33m x 2.46m to wardrobe)
Double glazed window to the front of the property, fitted wardrobes, ceiling light point and fan

Bedroom Two

16' x 10' (4.88m x 3.05m)
Double glazed window to rear, radiator, ceiling light point

Bedroom Three

11' 10" x 6' 8" (3.61m x 2.03m)
Double glazed window to the rear of the property, built in wardrobes, radiator, ceiling light point with fan

Shower Room

Double glazed window to the front of the property, wet room shower, low level WC, wash hand basin with vanity unit, extractor fan, spot lights, tiled flooring

Rear Garden

wrap around garden rear and side, lawn and patio area pond and fence boarder



view this property online shipways.co.uk/Property/GRB110902



welcome to

Perry Park Crescent, BIRMINGHAM

- FOUR BEDROOM
- FREEHOLD
- SEMI DETACHED
- TWO RECEPTION ROOMS
- LARGE GARDEN

Tenure: Freehold EPC Rating: D

offers in excess of

£340,000

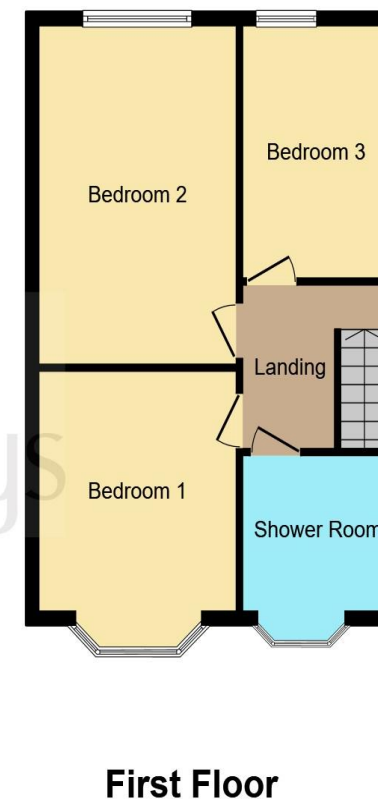

This floor plan is for illustrative purposes only. It is not drawn to scale. Any measurements, floor areas (including any total floor area), openings and orientation are approximate. No details are guaranteed, they cannot be relied upon for any purpose and they do not form part of any agreement. No liability is taken for any error, omission or misstatement. A party must rely upon its own inspection(s). Powered by www.focalagent.com

view this property online shipways.co.uk/Property/GRB110902



Property Ref:
GRB110902 - 0003

1. MONEY LAUNDERING REGULATIONS Intending purchasers will be asked to produce identification documentation at a later stage and we would ask for your co-operation in order that there is no delay in agreeing the sale. 2. These particulars do not constitute part or all of an offer or contract. 3. The measurements indicated are supplied for guidance only and as such must be considered incorrect. Potential buyers are advised to recheck measurements before committing to any expense. 4. We have not tested any apparatus, equipment, fixtures or services and it is in the buyers interest to check the working condition of any appliances. 5. Where an EPC, or a Home Report (Scotland only) is held for this property, it is available for inspection at the branch by appointment. If you require a printed version of a Home Report, you will need to pay a reasonable production charge reflecting printing and other costs. 6. We are not able to offer an opinion either written or verbal on the content of these reports and this must be obtained from your legal representative. 7. Whilst we take care in preparing these reports, a buyer should ensure that his/her legal representative confirms as soon as possible all matters relating to title including the extent and boundaries of the property and other important matters before exchange of contracts.



0121 358 2281



greatbarr@shipways.co.uk



905 Walsall Road, Great Barr, BIRMINGHAM,
West Midlands, B42 1TN



shipways.co.uk