



**Perry Place, West Bromwich B70 0PE**

**welcome to**

## **Perry Place, West Bromwich**

\*\*\*SEMI DETACHED\*\*\*THREE BEDROOMS\*\*\*LOUNGE \*\*\*KITCHEN\*\*\*DOWNSTAIRS WC\*\*\*OFF ROAD PARKING\*\*\*DOUBLE GLAZED & CENTRAL HEATING\*\*\*CHAIN FREE\*\*\*

### **Note**

Council tax band: C

### **Front Garden**

Dropped kerb and parking to front and entry to side garage.

### **Entrance Hall**

Double glazed to side, vinyl floor, ceiling light point and radiator.

### **Cloakroom**

Double glazed window to front, low level WC, wash hand basin, vinyl flooring, ceiling light point and radiator.

### **Lounge**

14' 11" x 13' 11" ( 4.55m x 4.24m )

Double glazed window and UPVC double glazed doors to rear, understairs cupboard, two ceiling light points, carpet flooring and radiator.

### **Kitchen**

12' 10" x 7' 7" ( 3.91m x 2.31m )

Double glazed window to front, wall and base units with work surfaces over, sink and drainer unit, integrated cooker, gas hob with extractor over, space for fridge freezer, vinyl flooring, spotlights and radiator.





### **Landing**

Over stairs cupboard, carpet flooring, ceiling light point and loft access.

### **Bedroom One**

12' 10" x 8' 1" ( 3.91m x 2.46m )

Double glazed window to front, built in wardrobes, carpet flooring, ceiling light point and radiator.

### **Ensuite**

Shower cubicle, wash hand basin, low level WC, tiling to splash prone areas, vinyl flooring, spotlights and heated towel radiator.

### **Bedroom Two**

8' 1" x 8' 1" ( 2.46m x 2.46m )

Double glazed window to rear, carpet flooring, ceiling light point and radiator.

### **Bedroom Three**

9' 4" x 6' 6" ( 2.84m x 1.98m )

Double glazed window to front, carpet flooring, ceiling light point and radiator.

### **Bathroom**

Double glazed window to rear, bath with hose tap, low level WC, wash hand basin, half tiled walls, vinyl flooring, spotlights and heated towel radiator

### **Rear Garden**

Paved patio area, mainly laid to lawn, wooden shed and fenced surround.



***view this property online*** [shipways.co.uk/Property/GRB110476](http://shipways.co.uk/Property/GRB110476)



welcome to

## Perry Place, West Bromwich

- SEMI DETACHED
- THREE BEDROOMS
- LOUNGE
- KITCHEN
- DOWNSTAIRS WC

Tenure: Freehold EPC Rating: B

**£260,000**

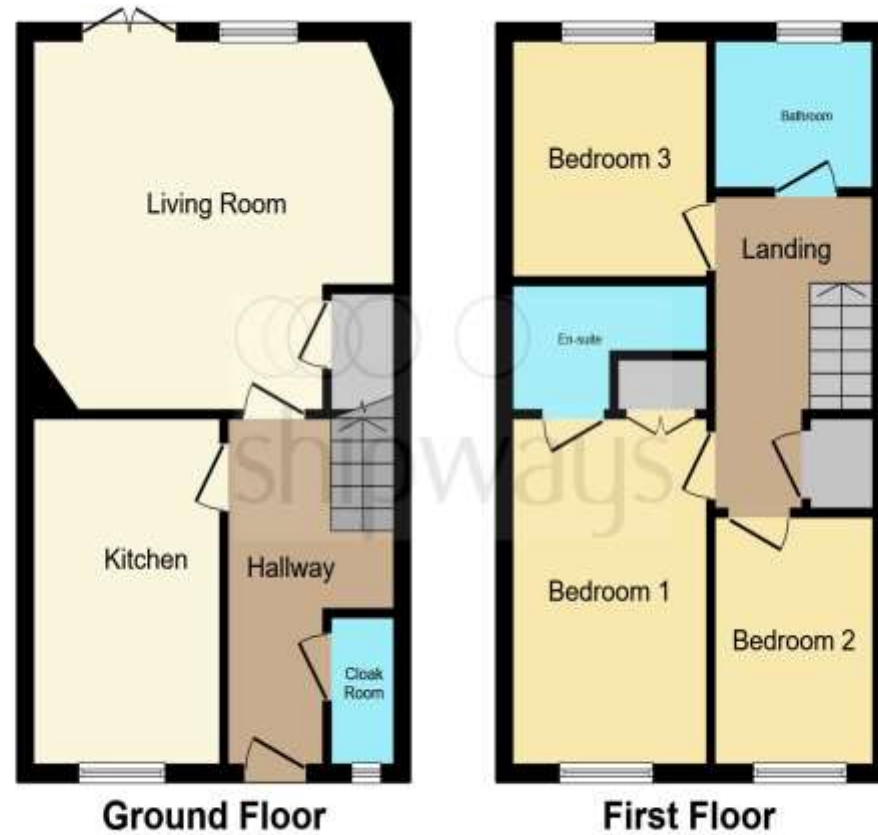

This floorplan is for illustrative purposes only and is not drawn to scale. Measurements, floor-areas, openings and orientations are approximate. They should not be relied upon for any purpose and do not form any part of an agreement. No liability is taken for any error or mis-statement. All parties must rely on their own inspections.

**view this property online** [shipways.co.uk/Property/GRB110476](http://shipways.co.uk/Property/GRB110476)



Property Ref:  
GRB110476 - 0003

1. MONEY LAUNDERING REGULATIONS Intending purchasers will be asked to produce identification documentation at a later stage and we would ask for your co-operation in order that there is no delay in agreeing the sale. 2. These particulars do not constitute part or all of an offer or contract. 3. The measurements indicated are supplied for guidance only and as such must be considered incorrect. Potential buyers are advised to recheck measurements before committing to any expense. 4. We have not tested any apparatus, equipment, fixtures or services and it is in the buyers interest to check the working condition of any appliances. 5. Where an EPC, or a Home Report (Scotland only) is held for this property, it is available for inspection at the branch by appointment. If you require a printed version of a Home Report, you will need to pay a reasonable production charge reflecting printing and other costs. 6. We are not able to offer an opinion either written or verbal on the content of these reports and this must be obtained from your legal representative. 7. Whilst we take care in preparing these reports, a buyer should ensure that his/her legal representative confirms as soon as possible all matters relating to title including the extent and boundaries of the property and other important matters before exchange of contracts.

Shipways is a trading name of Sequence (UK) Limited which is registered in England and Wales under company number 4268443, Registered Office is Cumbria House, 16-20 Hockliffe Street, Leighton Buzzard, Bedfordshire, LU7 1GN. VAT Registration Number is 500 2481 05.

shipways



**0121 358 2281**



[greatbarr@shipways.co.uk](mailto:greatbarr@shipways.co.uk)



905 Walsall Road, Great Barr, BIRMINGHAM,  
West Midlands, B42 1TN



[shipways.co.uk](http://shipways.co.uk)