



**Brook Meadow Road, Birmingham B34 6QR**



**welcome to**

**Brook Meadow Road, Birmingham**

\*\*\* DO NOT MISS OUT \*\*\* END OF TERRACE \*\*\* TWO DOUBLE BEDROOMS \*\*\* THROUGH LOUNGE \*\*\* FITTED KITCHEN \*\*\* LARGE DRIVEWAY \*\*\* FAMILY BATHROOM \*\*\* PERFECT FIRST TIME BUY \*\*\* EXCELLENT TRANSPORT LINKS \*\*\* FREEHOLD \*\*\* CALL SHIPWAYS TO VIEW \*\*\*



### Driveway

Block paved driveway to front

### Entrance Hall

Meter cupboard, ceiling light point and radiator

### Lounge

22' x 10' 1" max (6.71m x 3.07m max)

Double glazing to front, two radiators, two ceiling light points and double-glazed sliding door to garden

### Kitchen

10' 1" x 7' 1" (3.07m x 2.16m)

Double glazing to front, door to utility, base units, roll top work tops, steel sink and drainer, ceiling light point and space for appliances.

### Landing

Double glazing to hall, loft access

### Bedroom One

18' max x 10' max (5.49m max x 3.05m max)

Two double glazed windows to front, ceiling light point, radiator and storage cupboard.

### Bedroom Two

9' 1" max x 11' (2.77m max x 3.35m)

Double glazing to rear, ceiling light point, radiator and two storage cupboards

### Bathroom

Spotlights, radiator, low level W.C., vanity sink, p shaped bath with shower over and double-glazed window to side and rear.

### Rear Garden

Patio and lawn

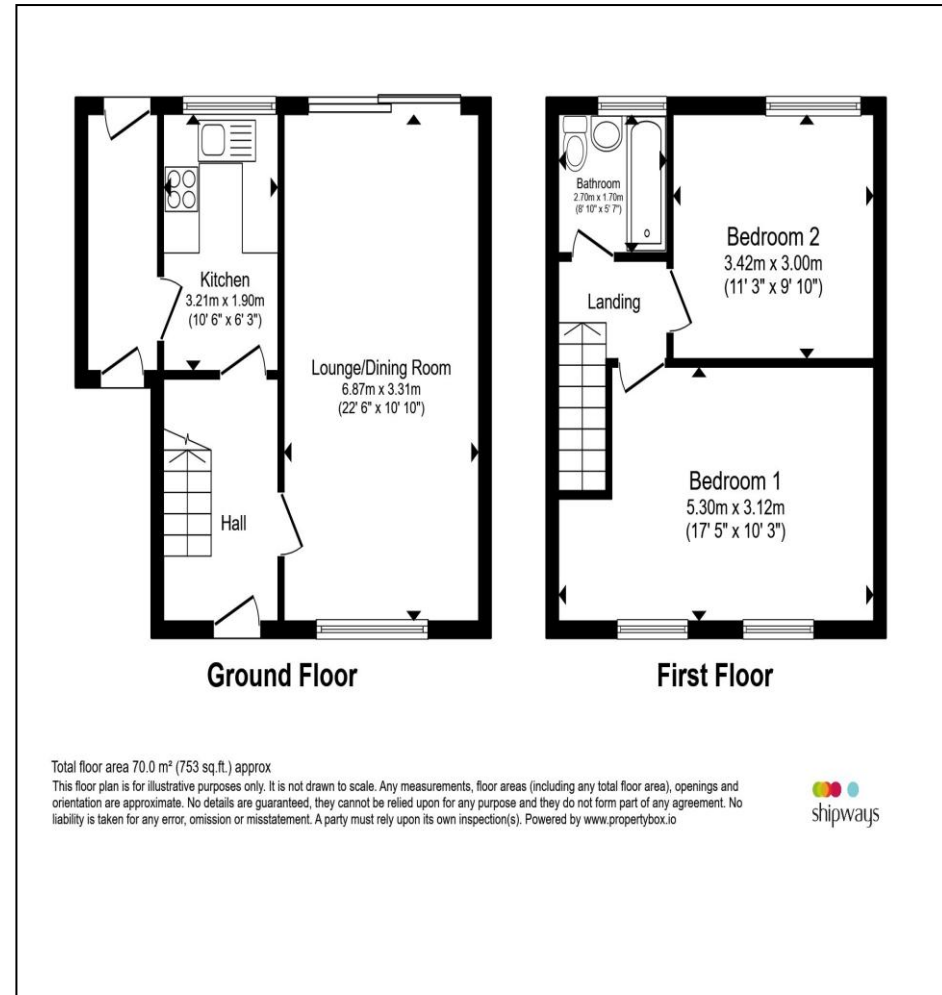

**check out more properties at** [shipways.co.uk](http://shipways.co.uk)



welcome to

## Brook Meadow Road, Birmingham

- END OF TERRACE
- TWO DOUBLE BEDROOMS
- LOUNGE DINER
- FITTED KITCHEN
- FAMILY BATHROOM

Tenure: Freehold EPC Rating: D

Council Tax Band: B

£190,000



Please note the marker reflects the postcode not the actual property

check out more properties at [shipways.co.uk](https://shipways.co.uk)



Property Ref:  
CAB111898 - 0004

1. MONEY LAUNDERING REGULATIONS Intending purchasers will be asked to produce identification documentation at a later stage and we would ask for your co-operation in order that there is no delay in agreeing the sale. 2. These particulars do not constitute part or all of an offer or contract. 3. The measurements indicated are supplied for guidance only and as such must be considered incorrect. Potential buyers are advised to recheck measurements before committing to any expense. 4. We have not tested any apparatus, equipment, fixtures or services and it is in the buyers interest to check the working condition of any appliances. 5. Where an EPC, or a Home Report (Scotland only) is held for this property, it is available for inspection at the branch by appointment. If you require a printed version of a Home Report, you will need to pay a reasonable production charge reflecting printing and other costs. 6. We are not able to offer an opinion either written or verbal on the content of these reports and this must be obtained from your legal representative. 7. Whilst we take care in preparing these reports, a buyer should ensure that his/her legal representative confirms as soon as possible all matters relating to title including the extent and boundaries of the property and other important matters before exchange of contracts.

Shipways is a trading name of Sequence (UK) Limited which is registered in England and Wales under company number 4268443, Registered Office is Cumbria House, 16-20 Hockliffe Street, Leighton Buzzard, Bedfordshire, LU7 1GN. VAT Registration Number is 500 2481 05.



0121 747 4722



[castlebromwich@shipways.co.uk](mailto:castlebromwich@shipways.co.uk)



258 Chester Road, Castle Bromwich,  
BIRMINGHAM, West Midlands, B36 0JE



[shipways.co.uk](https://shipways.co.uk)