



**Air Ministry Houses Chester Road, Castle Vale Birmingham B35 7AA**



**welcome to**

## **Air Ministry Houses Chester Road, Castle Vale Birmingham**

**\*\*LARGER STYLE END TERRACE PROPERTY\*\*NO CHAIN\*\*LOUNGE\*\*DINING ROOM\*\*FITTED KITCHEN\*\*DOWNSTAIRS SHOWER AND TOILET\*\*THREE BEDROOMS\*\*BATHROOM\*\*FRONT AND REAR GARDENS\*\*REAR GARAGE\*\***

### **Agent Note**

Council Tax Band A.

### **Hallway**

Having a radiator, ceiling lightpoint, stairs to the first floor, doors to lounge and dining room.

### **Lounge**

14' 4" x 10' 9" ( 4.37m x 3.28m )

Double glazed window to the front, radiator, ceiling lightpoint and feature fireplace.

### **Dining Room**

11' 4" x 13' 1" ( 3.45m x 3.99m )

Double glazed window to the rear, radiator, ceiling lightpoint, feature fireplace and door to kitchen.

### **Kitchen**

11' 4" x 8' ( 3.45m x 2.44m )

Double glazed window and door to the rear, radiator, wall mounted central heating boiler, door to downstairs shower room, fitted with a range of cupboards, base and draw units, roll top work surface, stainless steel sink and drainer, fitted hob and double oven and plumbing for washing machine.

### **Shower Room**

Double glazed window to the rear, ceiling lightpoint, low level WC, wall mounted sink shower cubicle.

### **Landing**

Double glazed window to the front, two ceiling lightpoints, loft access and radiator.

### **Bedroom 1**

14' 4" x 10' 9" ( 4.37m x 3.28m )

Double glazed window to the front, radiator and ceiling lightpoint.

### **Bedroom 2**

13' 2" x 8' 3" ( 4.01m x 2.51m )

Double glazed window to the rear, radiator, ceiling lightpoint and picture rail.

### **Bedroom 3**

11' 1" x 8' 1" ( 3.38m x 2.46m )

Double glazed window to the rear, radiator and ceiling lightpoint.

### **Bathroom**

Double glazed window to the rear, spotlights, P shape bath with shower over, vanity sink unit, low level WC. tiled walls and floor.

### **Garden**

Paved patio area, tarmac and gravel areas, door to garage, enclosed by fencing with gates to front and rear.





**Ground Floor**

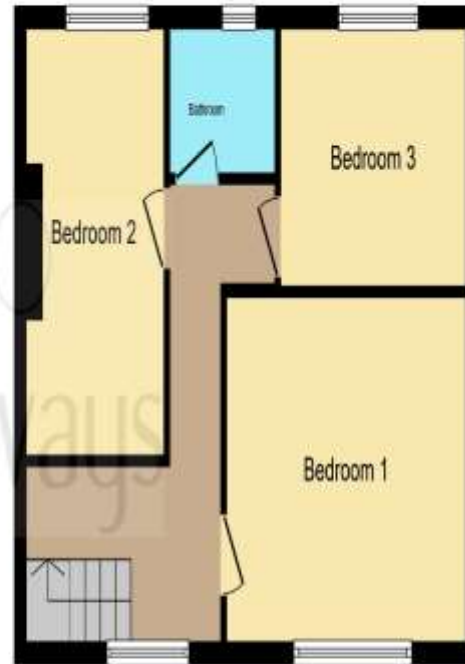

**First Floor**

This floor plan is for illustrative purposes only. It is not drawn to scale. Any measurements, floor areas (including any total floor area), openings and orientation are approximate. No details are guaranteed, they cannot be relied upon for any purpose and they do not form part of any agreement. No liability is taken for any error, omission or misstatement. A party must rely upon its own inspection(s). Powered by [www.focalagent.com](http://www.focalagent.com)



**welcome to**

**Air Ministry Houses Chester Road,  
Castle Vale Birmingham**

- LARGER STYLE END TERRACE PROPERTY
- THREE GOOD SIZE BEDROOMS
- LOUNGE AND SEPARATE DINING ROOM
- FITTED KITCHEN
- DOWNSTAIRS TOILET

Tenure: Freehold EPC Rating: Awaited  
Council Tax Band: A

offers over  
**£260,000**



**view this property online** [shipways.co.uk/Property/CAB111551](https://shipways.co.uk/Property/CAB111551)



Property Ref:  
CAB111551 - 0002

1. MONEY LAUNDERING REGULATIONS Intending purchasers will be asked to produce identification documentation at a later stage and we would ask for your co-operation in order that there is no delay in agreeing the sale. 2. These particulars do not constitute part or all of an offer or contract. 3. The measurements indicated are supplied for guidance only and as such must be considered incorrect. Potential buyers are advised to recheck measurements before committing to any expense. 4. We have not tested any apparatus, equipment, fixtures or services and it is in the buyers interest to check the working condition of any appliances. 5. Where an EPC, or a Home Report (Scotland only) is held for this property, it is available for inspection at the branch by appointment. If you require a printed version of a Home Report, you will need to pay a reasonable production charge reflecting printing and other costs. 6. We are not able to offer an opinion either written or verbal on the content of these reports and this must be obtained from your legal representative. 7. Whilst we take care in preparing these reports, a buyer should ensure that his/her legal representative confirms as soon as possible all matters relating to title including the extent and boundaries of the property and other important matters before exchange of contracts.

Shipways is a trading name of Sequence (UK) Limited which is registered in England and Wales under company number 4268443, Registered Office is Cumbria House, 16-20 Hockliffe Street, Leighton Buzzard, Bedfordshire, LU7 1GN. VAT Registration Number is 500 2481 05.



**0121 747 4722**



[castlebromwich@shipways.co.uk](mailto:castlebromwich@shipways.co.uk)



258 Chester Road, Castle Bromwich,  
BIRMINGHAM, West Midlands, B36 0JE



**[shipways.co.uk](https://shipways.co.uk)**