



Riley Drive, Birmingham B36 9NP

Not for marketing purposes INTERNAL USE ONLY

welcome to

Riley Drive, Birmingham

**** THREE BEDROOMS ** MID TERRACE ** FITTED DINING KITCHEN ** LOUNGE ** UPSTAIRS BATHROOM ** DOWNSTAIRS WC ** RE -WIRED** NO CHAIN ** IDEAL FOR FIRST TIME BUYERS OR BUY TO LET ****

Agent Note

Council Tax Band A.

Entrance Porch

Door to hallway, built in cupboard and meter.

Entrance Hall

Stairs to first floor, tiled floor, radiator and ceiling lightpoint.

Wc

Window to front, low level wc, wall sink and ceiling lightpoint.

Kitchen

16' 3" x 9' 4" (4.95m x 2.84m)

Double glazed window to front, cupboard, draw unit, roll top work surface, sink and drainer with mixer tap, double oven, hob hood, fridge freezer, tiled floor, radiator and spotlights.

Lounge

12' 5" max x 15' 4" (3.78m max x 4.67m)

Double glazed patio to rear, coving, feature fireplace, radiator, two wall lights and two ceiling lightpoints.

Landing

Loft access, cupboard and ceiling lightpoint.

Bedroom One

13' x 8' 5" (3.96m x 2.57m)

Double glazed window to rear, coving, built in wardrobes, radiator and ceiling lightpoint.

Bedroom Two

13' 3" x 9' 2" (4.04m x 2.79m)

Double glazed window to front, radiator and ceiling lightpoint.

Bedroom Three

9' x 6' 6" (2.74m x 1.98m)

Double glazed window to rear, radiator and ceiling lightpoint.

Bathroom

Double glazed window to front, panel bath shower, vanity sink, low level wc, airing cupboard, housing boiler, tiled walls and floor, radiator and spotlights.

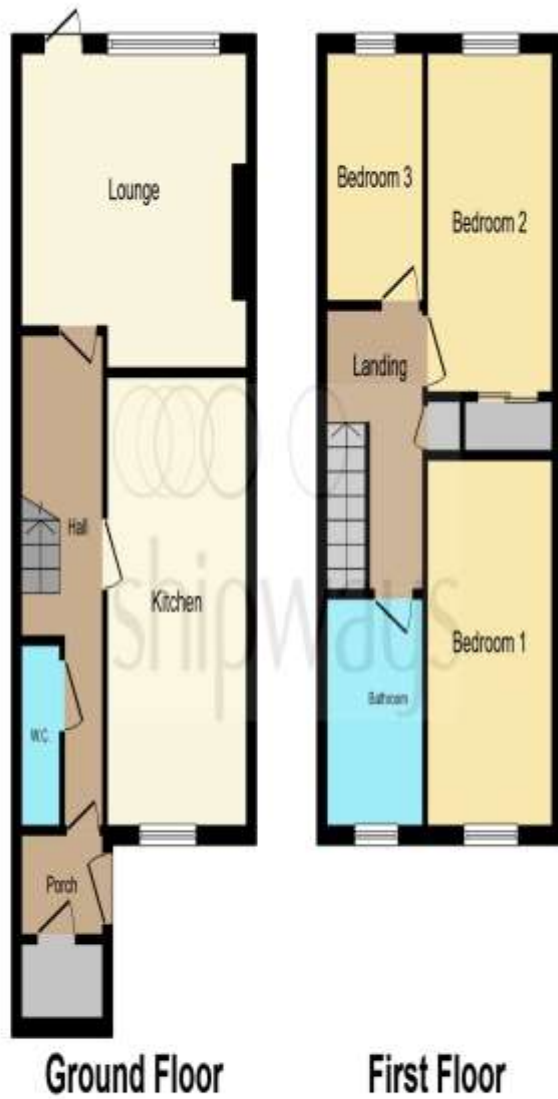

Ground Floor

First Floor

This floor plan is for illustrative purposes only. It is not drawn to scale. Any measurements, floor areas (including any total floor area), openings and orientation are approximate. No details are guaranteed, they cannot be relied upon for any purpose and they do not form part of any agreement. No liability is taken for any error, omission or misstatement. A party must rely upon its own inspection(s). Powered by www.focalagent.com



welcome to
Riley Drive,
Birmingham

- THREE BEDROOMS
- MID TERRACE
- NO CHAIN
- RE-FITTED KITCHEN
- LOUNGE

Tenure: Freehold EPC Rating: Awaited

offers over

£170,000



check out more properties at shipways.co.uk



Property Ref:
CAB111288 - 0002

1. MONEY LAUNDERING REGULATIONS Intending purchasers will be asked to produce identification documentation at a later stage and we would ask for your co-operation in order that there is no delay in agreeing the sale. 2. These particulars do not constitute part or all of an offer or contract. 3. The measurements indicated are supplied for guidance only and as such must be considered incorrect. Potential buyers are advised to recheck measurements before committing to any expense. 4. We have not tested any apparatus, equipment, fixtures or services and it is in the buyers interest to check the working condition of any appliances. 5. Where an EPC, or a Home Report (Scotland only) is held for this property, it is available for inspection at the branch by appointment. If you require a printed version of a Home Report, you will need to pay a reasonable production charge reflecting printing and other costs. 6. We are not able to offer an opinion either written or verbal on the content of these reports and this must be obtained from your legal representative. 7. Whilst we take care in preparing these reports, a buyer should ensure that his/her legal representative confirms as soon as possible all matters relating to title including the extent and boundaries of the property and other important matters before exchange of contracts.

Shipways is a trading name of Sequence (UK) Limited which is registered in England and Wales under company number 4268443, Registered Office is Cumbria House, 16-20 Hockliffe Street, Leighton Buzzard, Bedfordshire, LU7 1GN. VAT Registration Number is 500 2481 05.

Not for marketing purposes INTERNAL USE ONLY



0121 747 4722



castlebromwich@shipways.co.uk



258 Chester Road, Castle Bromwich,
BIRMINGHAM, West Midlands, B36 0JE



shipways.co.uk