

THE WHITCHURCH

1 BEDROOM HOME

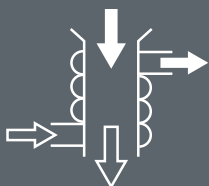

Highly-efficient insulation



Waste Water Heat Recovery Systems



Argon-filled double-glazing



Electric car charging point



House type may include Solar PV Panels, please speak to Sales Adviser for further details.

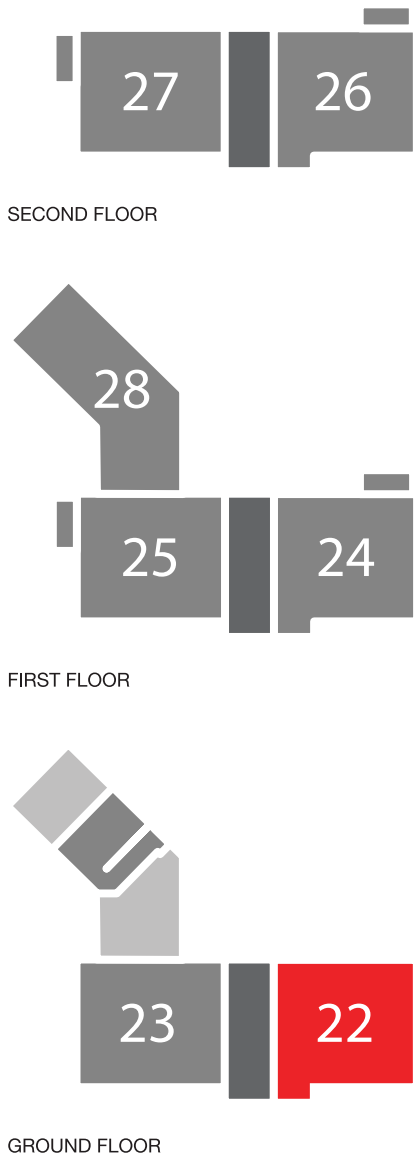

Ground Floor		
Kitchen/Dining	3679 x 5082 mm	12'1" x 16'8"
Lounge	3827 x 2856 mm	12'7" x 9'5"
Bedroom	5746 x 3689 mm	18'10" x 12'1"
Bathroom	2660 x 2235 mm	8'9" x 7'4"

Plot 22

KEY	B	Boiler	w/m	Washing machine space	◀ ▶	Dimension location
	ST	Store	f/f	Fridge/freezer space		
	d/w	Dishwasher space	W	Wardrobe space		

