



34 Penyston Road, Maidenhead SL6 6EH

welcome to

34 Penyston Road, Maidenhead

Full of charm and character, this attractive Victorian terraced home offers spacious accommodation, generous rear garden and potential to create off-street private parking, all within walking distance of the town centre and station. The property retains many character features including high ceilings and period detailing, which blend beautifully with practical modern living.



Penyston Road, Maidenhead, SL6

Approximate Area = 970 sq ft / 90.1 sq m

For identification only - Not to scale

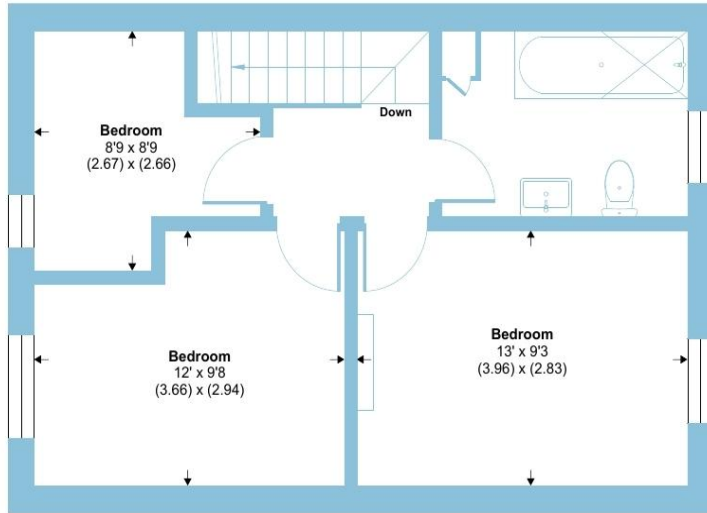

FIRST FLOOR

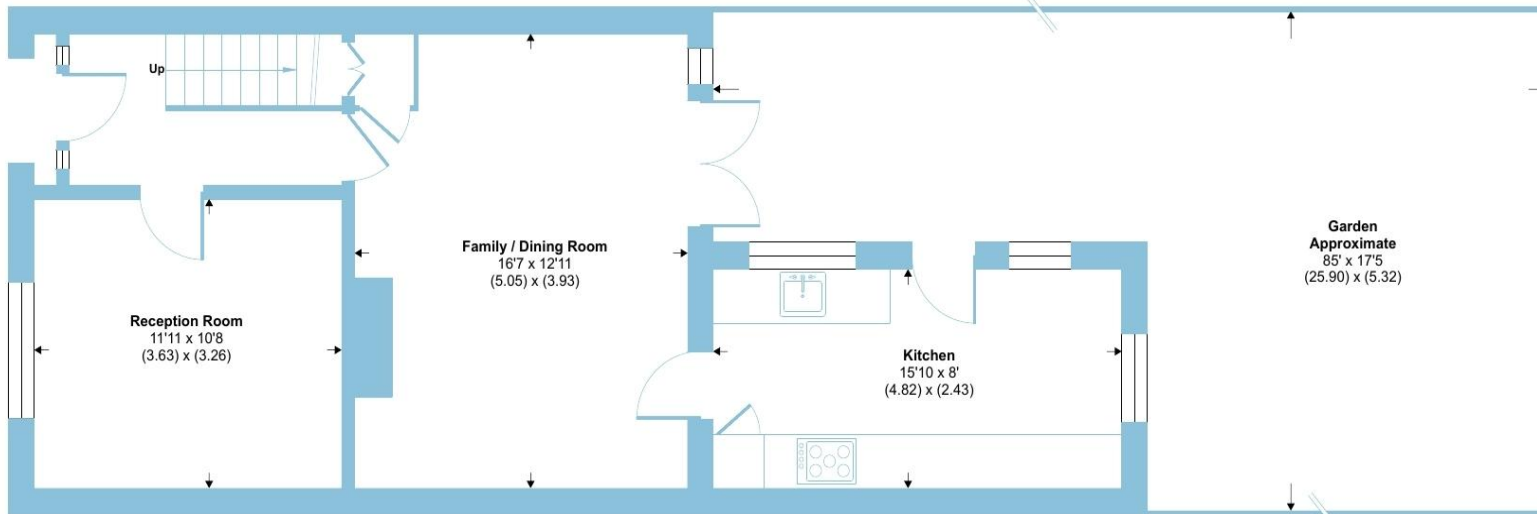

GROUND FLOOR



Floor plan produced in accordance with RICS Property Measurement 2nd Edition, Incorporating International Property Measurement Standards (IPMS2 Residential). © nichecom 2026. Produced for Barnard Marcus. REF: 1400640



The property retains many character features typical of its era, including high ceilings and period detailing, which blend beautifully with practical modern living. The ground floor offers two welcoming reception rooms, ideal for both relaxing and entertaining, alongside a well-arranged kitchen providing ample storage and workspace. The layout flows naturally and makes excellent use of the available space.

Upstairs, the property offers three well-proportioned bedrooms, each enjoying good natural light and flexible accommodation suitable for families, professionals, or home working. A family bathroom serves the bedrooms and completes the internal layout.

To the rear, a good-sized garden provides an excellent outdoor space, ideal for entertaining, gardening, or family use, and offers a peaceful retreat from everyday life. Penyston Road is a popular residential location, conveniently positioned for Maidenhead town centre, local shops, schools, and excellent transport links, including Maidenhead station with services on the Elizabeth Line. Nearby parks and riverside walks further enhance the appeal.

A wonderful opportunity to acquire a characterful period home in a sought-after Maidenhead location.

welcome to

34 Penyston Road, Maidenhead

- FULL OF CHARM & CHARACTER
- ATTRACTIVE VICTORIAN TERRACED HOME
- HIGH CEILINGS & PERIOD DETAILING
- THREE WELL-PROPORTIONED BEDROOMS
- TWO WELCOMING RECEPTION ROOMS
- GOOD SIZE REAR GARDEN
- ON-STREET PARKING WITH POTENTIAL TO CREATE OFF-STREET PARKING
- SOUGHT-AFTER MAIDENHEAD LOCATION WITHIN WALKING DISTANCE OF TOWN & STATION

Tenure: Freehold EPC Rating: D
Council Tax Band: D

£565,000



Please note the marker reflects the postcode not the actual property

check out more properties at rogerplatt.co.uk



Property Ref:
MHD123473 - 0002

1. MONEY LAUNDERING REGULATIONS Intending purchasers will be asked to produce identification documentation at a later stage and we would ask for your co-operation in order that there is no delay in agreeing the sale. 2. These particulars do not constitute part or all of an offer or contract. 3. The measurements indicated are supplied for guidance only and as such must be considered incorrect. Potential buyers are advised to recheck measurements before committing to any expense. 4. We have not tested any apparatus, equipment, fixtures or services and it is in the buyers interest to check the working condition of any appliances. 5. Where an EPC, or a Home Report (Scotland only) is held for this property, it is available for inspection at the branch by appointment. If you require a printed version of a Home Report, you will need to pay a reasonable production charge reflecting printing and other costs. 6. We are not able to offer an opinion either written or verbal on the content of these reports and this must be obtained from your legal representative. 7. Whilst we take care in preparing these reports, a buyer should ensure that his/her legal representative confirms as soon as possible all matters relating to title including the extent and boundaries of the property and other important matters before exchange of contracts.

Roger Platt is a trading name of Sequence (UK) Limited which is registered in England and Wales under company number 4268443, Registered Office is Cumbria House, 16-20 Hockliffe Street, Leighton Buzzard, Bedfordshire, LU7 1GN. VAT Registration Number is 500 2481 05.

roger platt



01628 773333



Maidenhead@rogerplatt.co.uk



25-29 Queen Street, MAIDENHEAD, Berkshire,
SL6 1NB



rogerplatt.co.uk