



**Flat 4 Rize Court, 94-96 High Street, Maidenhead SL6 1PT**

**welcome to**

**Flat 4 Rize Court, 94-96 High Street, Maidenhead**

This superb HIGH SPECIFICATION first floor apartment is set within an EXCLUSIVE DEVELOPMENT of just 12 carefully designed one bedroom apartments, located right in the heart of the well-connected and picturesque town of Maidenhead.



# High Street, Maidenhead, SL6

Approximate Area = 452 sq ft / 42 sq m

For identification only - Not to scale

Flat 4

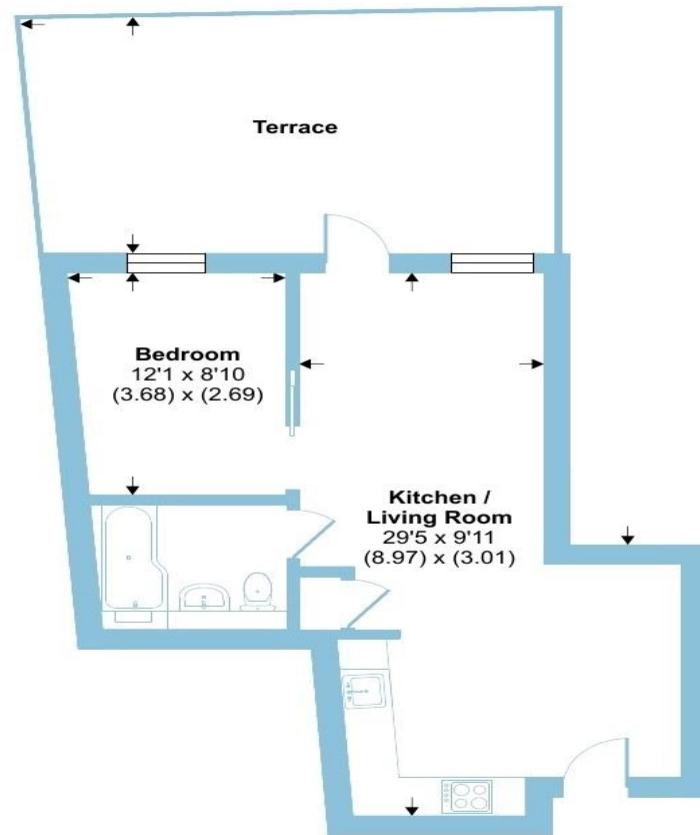

FIRST FLOOR



This enviable pedestrianised High Street location puts you within easy reach of shops, restaurants, gyms, cafes, bars and Maidenhead train station which provides direct access to London Paddington in as little as 18 minutes and the Elizabeth Line. Not only are the properties ideal for the towns facilities, they are also close to open spaces offering multiple outdoor activities.

The High Street where the development is located is pedestrianised and life's everyday essentials can be found on your doorstep. The town centre is packed with large and small shops with a range of convenience stores, a selection of independent stores, eclectic boutiques and popular high street brands.

## Disclaimer

Internal images are of the former show apartment.



Floor plan produced in accordance with RICS Property Measurement Standards incorporating International Property Measurement Standards (IPMS2 Residential). © nichecom 2022.  
Produced for Roger Platt REF: 817777





**welcome to**

## **Flat 4 Rize Court, 94-96 High Street**

- FINISHED TO A HIGH SPECIFICATION
- FIRST FLOOR APARTMENT
- PRIVATE TERRACE
- IDEALLY LOCATED IN THE HEART OF MAIDENHEAD TOWN CENTRE
- EXCELLENT TRANSPORT LINKS
- ONLY 0.4 MILES TO MAIDENHEAD TRAIN STATION & THE ELIZABETH LINE

Tenure: Leasehold EPC Rating: C

Council Tax Band: B Service Charge: Ask Agent

Ground Rent: Ask Agent

This is a Leasehold property with details as follows; Term of Lease 999 years from 01 Aug 2022. Should you require further information please contact the branch. Please Note additional fees could be incurred for items such as Leasehold packs.

**£265,000**



Please note the marker reflects the postcode not the actual property

**check out more properties at [rogerplatt.co.uk](https://rogerplatt.co.uk)**



Property Ref:  
MHD123231 - 0002

1. MONEY LAUNDERING REGULATIONS Intending purchasers will be asked to produce identification documentation at a later stage and we would ask for your co-operation in order that there is no delay in agreeing the sale. 2. These particulars do not constitute part or all of an offer or contract. 3. The measurements indicated are supplied for guidance only and as such must be considered incorrect. Potential buyers are advised to recheck measurements before committing to any expense. 4. We have not tested any apparatus, equipment, fixtures or services and it is in the buyers interest to check the working condition of any appliances. 5. Where an EPC, or a Home Report (Scotland only) is held for this property, it is available for inspection at the branch by appointment. If you require a printed version of a Home Report, you will need to pay a reasonable production charge reflecting printing and other costs. 6. We are not able to offer an opinion either written or verbal on the content of these reports and this must be obtained from your legal representative. 7. Whilst we take care in preparing these reports, a buyer should ensure that his/her legal representative confirms as soon as possible all matters relating to title including the extent and boundaries of the property and other important matters before exchange of contracts.

Roger Platt is a trading name of Sequence (UK) Limited which is registered in England and Wales under company number 4268443, Registered Office is Cumbria House, 16-20 Hockliffe Street, Leighton Buzzard, Bedfordshire, LU7 1GN. VAT Registration Number is 500 2481 05.

roger platt



**01628 773333**



**Maidenhead@rogerplatt.co.uk**



**25-29 Queen Street, MAIDENHEAD, Berkshire,  
SL6 1NB**



**[rogerplatt.co.uk](https://rogerplatt.co.uk)**