



14 Lennox House, Ray Park Avenue, Maidenhead SL6 8DT

welcome to

14 Lennox House, Ray Park Avenue, Maidenhead

A stylish and exceptionally well-presented one bedroom apartment set within a small development, within a few minutes' walk of the River Thames and the attractive Boulders Lock area. The communal area is well maintained and access into the building is via a secured entry-system. This lovely first floor contemporary apartment has a light, bright living room and open-plan kitchen - fitted with a modern range of units and integrated appliances. There is a good size double bedroom with the modern bathroom being en-suite and to the rear of the property, there is residents parking. Further benefits include double glazing and a long lease in excess of 240 years. The property is well located on a sought-after tree-lined road and within easy reach of the town centre & station and this lovely apartment has no onward chain.



Lennox House, Ray Park Avenue, Maidenhead, SL6

Approximate Area = 333 sq ft / 31 sq m

For identification only - Not to scale

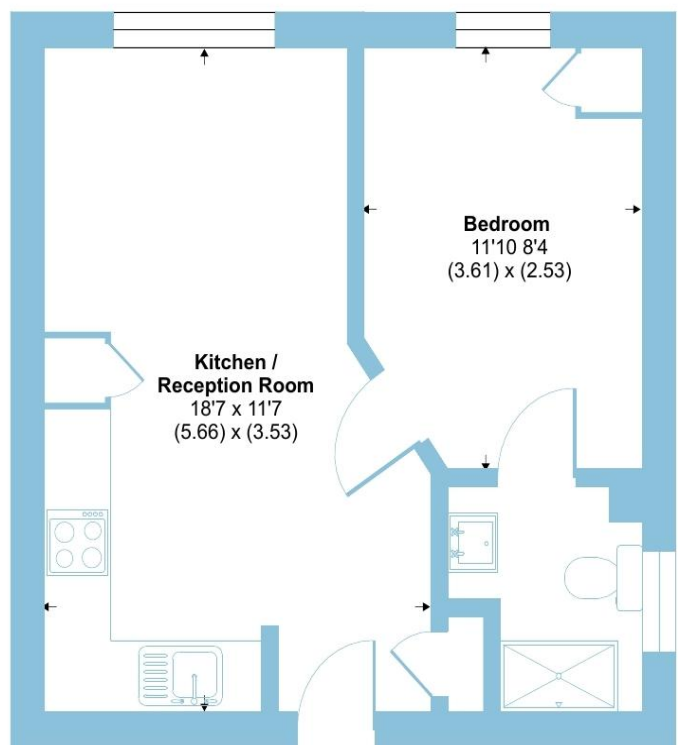

FIRST FLOOR



Floor plan produced in accordance with RICS Property Measurement 2nd Edition, Incorporating International Property Measurement Standards (IPMS2 Residential). © nichecom 2025. Produced for Barnard Marcus. REF: 1327480



welcome to

14 Lennox House, Ray Park Avenue

- STYLISH FIRST FLOOR APARTMENT
- SHORT WALK TO BOULTERS LOCK & RIVER
- SOUGHT-AFTER ROAD
- MODERN KITCHEN & BATHROOM
- LONG LEASE IN EXCESS OF 240 YEARS
- RESIDENTS' PARKING
- EASY ACCESS TO TOWN CENTRE & STATION
- NO ONWARD CHAIN

Tenure: Leasehold EPC Rating: B

Council Tax Band: C Service Charge: 918.86

Ground Rent: 192.00

This is a Leasehold property. We are awaiting further details about the Term of the lease. For further information please contact the branch. Please note additional fees could be incurred for items such as Leasehold packs.

offers over

£200,000



Please note the marker reflects the postcode not the actual property

check out more properties at rogerplatt.co.uk



Property Ref:
MHD122920 - 0005

1. MONEY LAUNDERING REGULATIONS Intending purchasers will be asked to produce identification documentation at a later stage and we would ask for your co-operation in order that there is no delay in agreeing the sale. 2. These particulars do not constitute part or all of an offer or contract. 3. The measurements indicated are supplied for guidance only and as such must be considered incorrect. Potential buyers are advised to recheck measurements before committing to any expense. 4. We have not tested any apparatus, equipment, fixtures or services and it is in the buyers interest to check the working condition of any appliances. 5. Where an EPC, or a Home Report (Scotland only) is held for this property, it is available for inspection at the branch by appointment. If you require a printed version of a Home Report, you will need to pay a reasonable production charge reflecting printing and other costs. 6. We are not able to offer an opinion either written or verbal on the content of these reports and this must be obtained from your legal representative. 7. Whilst we take care in preparing these reports, a buyer should ensure that his/her legal representative confirms as soon as possible all matters relating to title including the extent and boundaries of the property and other important matters before exchange of contracts.

Roger Platt is a trading name of Sequence (UK) Limited which is registered in England and Wales under company number 4268443, Registered Office is Cumbria House, 16-20 Hockliffe Street, Leighton Buzzard, Bedfordshire, LU7 1GN. VAT Registration Number is 500 2481 05.

roger platt



01628 773333



Maidenhead@rogerplatt.co.uk



25-29 Queen Street, MAIDENHEAD, Berkshire,
SL6 1NB



rogerplatt.co.uk