



Apartment 70 St James House, Clivemont Road, Maidenhead SL6 7DY

welcome to

Apartment 70 St James House, Clivemont Road, Maidenhead

Larger than average first floor apartment with a lovely aspect view over communal gardens. Finished to a high specification throughout this one bedroom apartment has access to the communal cinema and gym. A short walk from Maidenhead town centre and station this is ideal for first time buyers.



Clivemont Road, Maidenhead, SL6

Approximate Area = 501 sq ft / 46.5 sq m

For identification only - Not to scale

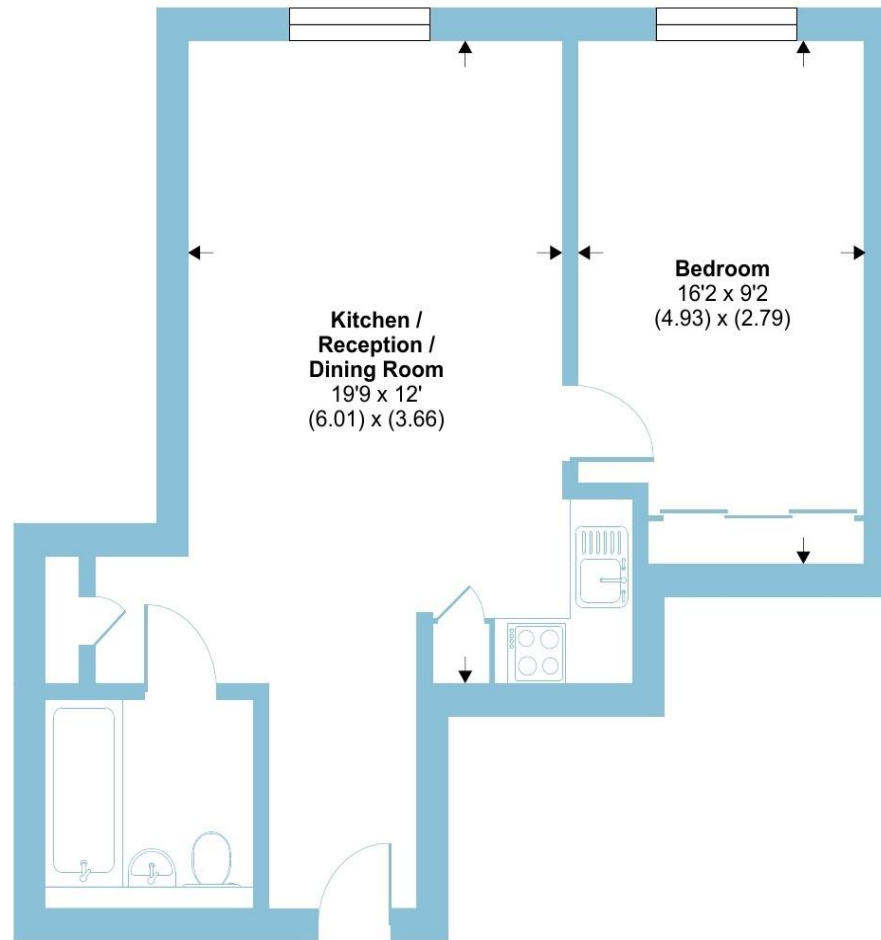

FIRST FLOOR



Floor plan produced in accordance with RICS Property Measurement 2nd Edition, Incorporating International Property Measurement Standards (IPMS2 Residential). © nichecom 2025. Produced for Barnard Marcus. REF: 1282193



welcome to

Apartment 70 St James House

- STYLISH ONE BEDROOM APARTMENT
- HIGH SPECIFICATION THROUGHOUT
- EXTRA TALL CEILINGS
- ACCESS TO COMMUNAL GYM
- ACCESS TO COMMUNAL CINEMA ROOM
- WALKING DISTANCE OF TOWN & STATION

Tenure: Leasehold EPC Rating: D

Council Tax Band: C Service Charge: 1734.00

Ground Rent: 300.00

This is a Leasehold property with details as follows; Term of Lease 999 years from 01 Nov 2018. Should you require further information please contact the branch. Please Note additional fees could be incurred for items such as Leasehold packs.

£238,000



Please note the marker reflects the postcode not the actual property

check out more properties at rogerplatt.co.uk



Property Ref:
MHD122591 - 0002

1. MONEY LAUNDERING REGULATIONS Intending purchasers will be asked to produce identification documentation at a later stage and we would ask for your co-operation in order that there is no delay in agreeing the sale. 2. These particulars do not constitute part or all of an offer or contract. 3. The measurements indicated are supplied for guidance only and as such must be considered incorrect. Potential buyers are advised to recheck measurements before committing to any expense. 4. We have not tested any apparatus, equipment, fixtures or services and it is in the buyers interest to check the working condition of any appliances. 5. Where an EPC, or a Home Report (Scotland only) is held for this property, it is available for inspection at the branch by appointment. If you require a printed version of a Home Report, you will need to pay a reasonable production charge reflecting printing and other costs. 6. We are not able to offer an opinion either written or verbal on the content of these reports and this must be obtained from your legal representative. 7. Whilst we take care in preparing these reports, a buyer should ensure that his/her legal representative confirms as soon as possible all matters relating to title including the extent and boundaries of the property and other important matters before exchange of contracts.

Roger Platt is a trading name of Sequence (UK) Limited which is registered in England and Wales under company number 4268443, Registered Office is Cumbria House, 16-20 Hockliffe Street, Leighton Buzzard, Bedfordshire, LU7 1GN. VAT Registration Number is 500 2481 05.

roger platt



01628 773333



Maidenhead@rogerplatt.co.uk



25-29 Queen Street, MAIDENHEAD, Berkshire,
SL6 1NB



rogerplatt.co.uk