



Earlsfield,Holyport Maidenhead SL6 2LZ

welcome to

Earlsfield, Holyport Maidenhead

Tucked away in the corner of this sought after cul-de-sac in Holyport is this superb four bedroom, two bathroom detached family home being offered for sale with no onward chain.



Earlsfield, Holyport, Maidenhead, SL6

Approximate Area = 1746 sq ft / 162.2 sq m

Garage = 288 sq ft / 26.7 sq m

Total = 2034 sq ft / 188.9 sq m

For identification only - Not to scale

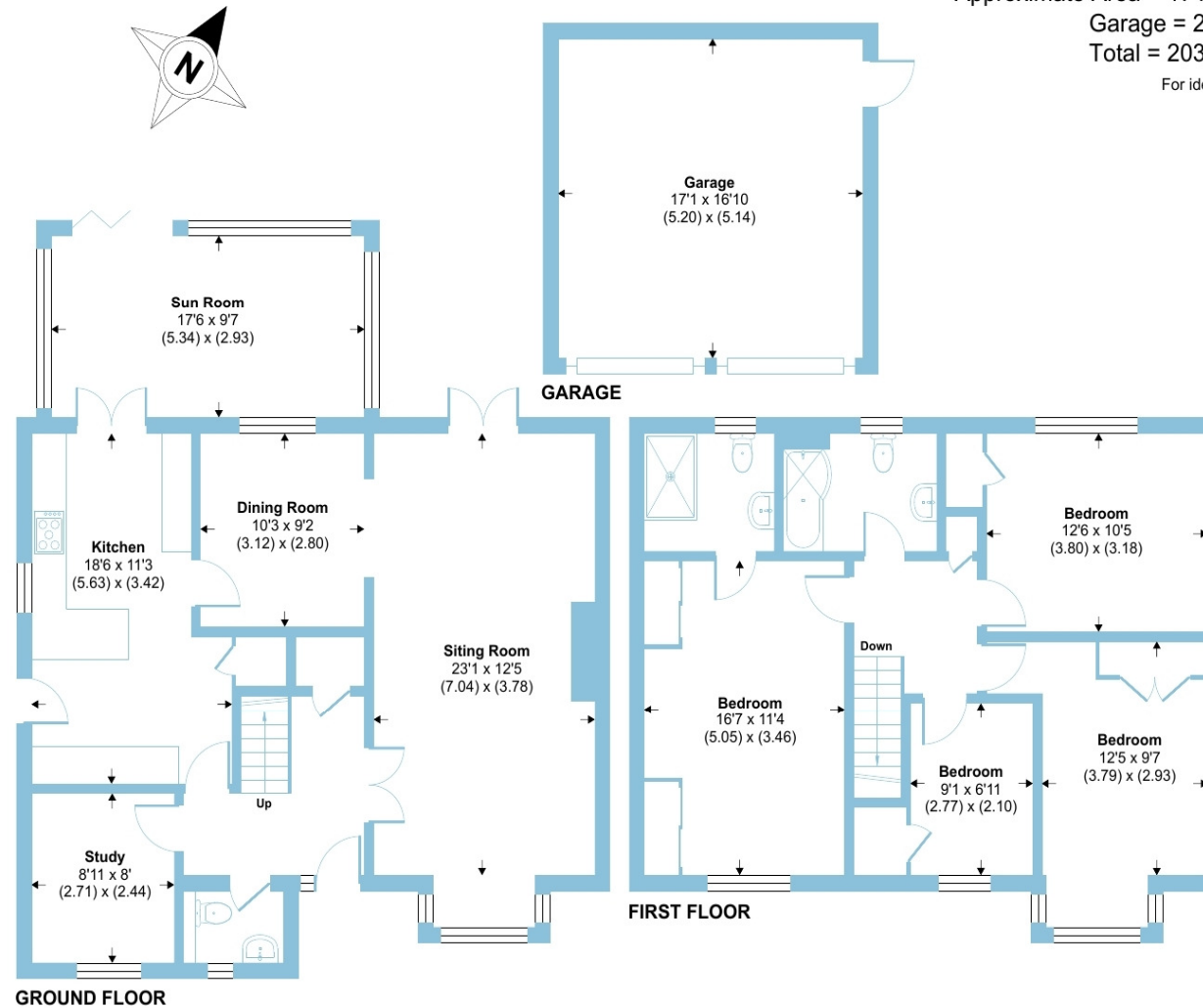

Floor plan produced in accordance with RICS Property Measurement 2nd Edition, Incorporating International Property Measurement Standards (IPMS2 Residential). © nchecom 2025. Produced for Barnard Marcus. REF: 1276189



Beautifully presented throughout having been vastly improved upon by the current owners, the property offers generous accommodation to include; spacious hallway with tiled flooring, study/home office, lovely re-fitted kitchen/breakfast room leading to the family room, large sitting room that opens into the dining room and completing the ground floor is the cloakroom. Upstairs, the principal bedroom has an en-suite and there are two further double bedrooms, a larger than average fourth bedroom and a family bathroom.

The property benefits from under-floor heating, good quality finish throughout and there is ample parking to the front on the driveway and there is also the huge benefit of a double garage. The rear garden has been well-maintained and is mainly laid to lawn.

This superb extended family home is close to several primary schools and the sought-after Holyport College along with local village amenities, whilst the nearby towns of Maidenhead (Elizabeth Line) and Windsor are within easy reach.

welcome to

Earlsfield, Holyport Maidenhead

- EXTENDED FAMILY HOME
- SUPERB CONDITION THROUGHOUT
- FOUR BEDROOMS
- TWO BATHROOMS
- BEAUTIFUL KITCHEN AND FAMILY AREA
- DRIVEWAY & DOUBLE GARAGE
- CLOSE TO HOLYPORT COLLEGE
- NO ONWARD CHAIN

Tenure: Freehold EPC Rating: Awaited

£900,000



Please note the marker reflects the postcode not the actual property

check out more properties at rogerplatt.co.uk



Property Ref:
MHD122588 - 0002

1. MONEY LAUNDERING REGULATIONS Intending purchasers will be asked to produce identification documentation at a later stage and we would ask for your co-operation in order that there is no delay in agreeing the sale. 2. These particulars do not constitute part or all of an offer or contract. 3. The measurements indicated are supplied for guidance only and as such must be considered incorrect. Potential buyers are advised to recheck measurements before committing to any expense. 4. We have not tested any apparatus, equipment, fixtures or services and it is in the buyers interest to check the working condition of any appliances. 5. Where an EPC, or a Home Report (Scotland only) is held for this property, it is available for inspection at the branch by appointment. If you require a printed version of a Home Report, you will need to pay a reasonable production charge reflecting printing and other costs. 6. We are not able to offer an opinion either written or verbal on the content of these reports and this must be obtained from your legal representative. 7. Whilst we take care in preparing these reports, a buyer should ensure that his/her legal representative confirms as soon as possible all matters relating to title including the extent and boundaries of the property and other important matters before exchange of contracts.

Roger Platt is a trading name of Sequence (UK) Limited which is registered in England and Wales under company number 4268443, Registered Office is Cumbria House, 16-20 Hockliffe Street, Leighton Buzzard, Bedfordshire, LU7 1GN. VAT Registration Number is 500 2481 05.



01628 773333



Maidenhead@rogerplatt.co.uk



**25-29 Queen Street, MAIDENHEAD, Berkshire,
SL6 1NB**



rogerplatt.co.uk