



4 Prince Andrew Close, Maidenhead SL6 8QH

welcome to

4 Prince Andrew Close, Maidenhead

A first floor, two double-bedroom balcony flat which is well presented throughout. This apartment is spacious and will prove very popular. Located within walking distance of Maidenhead town centre. This property benefits from a garage as well!



Prince Andrew Close, Maidenhead, SL6

Approximate Area = 607 sq ft / 56.4 sq m

For identification only - Not to scale

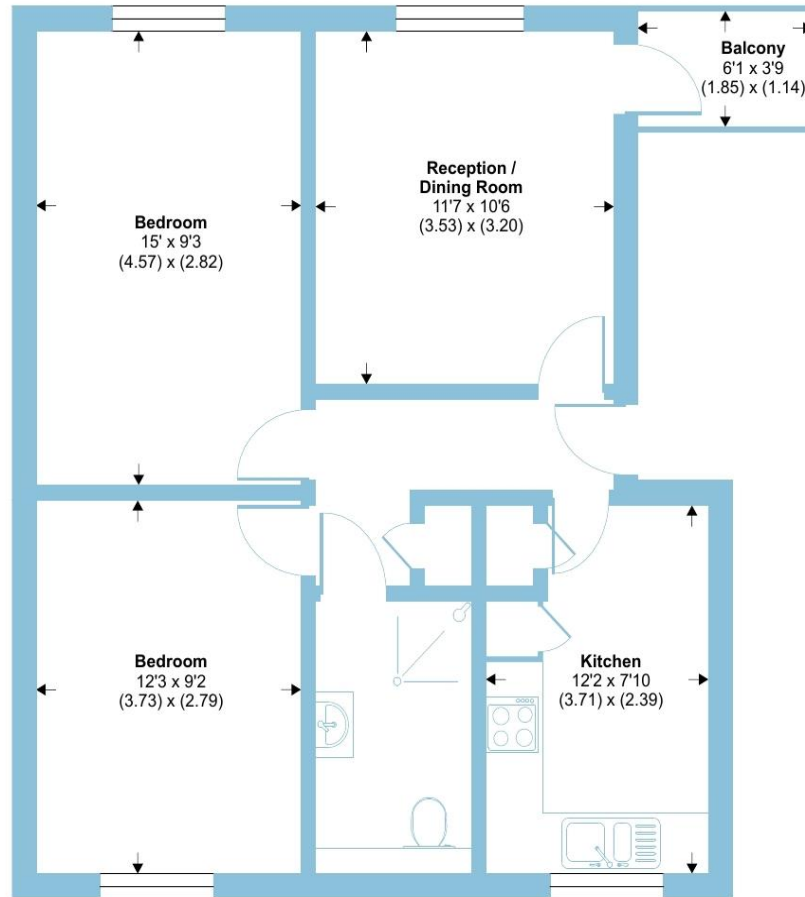

FIRST FLOOR



Floor plan produced in accordance with RICS Property Measurement 2nd Edition, Incorporating International Property Measurement Standards (IPMS2 Residential). © nichecom 2025. Produced for Barnard Marcus. REF: 1266669

welcome to

4 Prince Andrew Close, Maidenhead

- BALCONY
- GARAGE
- WELL-PRESENTED
- SEPERATE KITCHEN
- WALKING DISTANCE TO TOWN CENTRE
- TWO DOUBLE-BEDROOMS

Tenure: Leasehold EPC Rating: C

Council Tax Band: C Service Charge: 1545.00

Ground Rent: 15.00

This is a Leasehold property with details as follows; Term of Lease 1000 years from 13 May 1970. Should you require further information please contact the branch. Please Note additional fees could be incurred for items such as Leasehold packs.

£295,000



Please note the marker reflects the postcode not the actual property

view this property online rogerplatt.co.uk/Property/MHD121709



Property Ref:
MHD121709 - 0003

1. MONEY LAUNDERING REGULATIONS Intending purchasers will be asked to produce identification documentation at a later stage and we would ask for your co-operation in order that there is no delay in agreeing the sale. 2. These particulars do not constitute part or all of an offer or contract. 3. The measurements indicated are supplied for guidance only and as such must be considered incorrect. Potential buyers are advised to recheck measurements before committing to any expense. 4. We have not tested any apparatus, equipment, fixtures or services and it is in the buyers interest to check the working condition of any appliances. 5. Where an EPC, or a Home Report (Scotland only) is held for this property, it is available for inspection at the branch by appointment. If you require a printed version of a Home Report, you will need to pay a reasonable production charge reflecting printing and other costs. 6. We are not able to offer an opinion either written or verbal on the content of these reports and this must be obtained from your legal representative. 7. Whilst we take care in preparing these reports, a buyer should ensure that his/her legal representative confirms as soon as possible all matters relating to title including the extent and boundaries of the property and other important matters before exchange of contracts.

Roger Platt is a trading name of Sequence (UK) Limited which is registered in England and Wales under company number 4268443, Registered Office is Cumbria House, 16-20 Hockliffe Street, Leighton Buzzard, Bedfordshire, LU7 1GN. VAT Registration Number is 500 2481 05.

roger platt



01628 773333



Maidenhead@rogerplatt.co.uk



25-29 Queen Street, MAIDENHEAD, Berkshire,
SL6 1NB



rogerplatt.co.uk