



Flat 1 Butler House, 19-23 Market Street, Maidenhead SL6 8AA

welcome to

Flat 1 Butler House, 19-23 Market Street, Maidenhead

Situated in the heart of the town centre is this re-furbished two double bedroom, two bathroom apartment with lift and a long lease in excess of 100 years. The property is being sold in excellent condition throughout having been vastly updated and improved upon by the current owner. There is a good size entrance hall with built-in storage cupboards, a living room that is open-plan to the well-appointed kitchen. The spacious main bedroom has a lovely re-furbished en-suite and completing the accommodation is the second double bedroom and re-furbished bathroom. Butler House is located in the heart of the town centre, therefore just minutes from the shops and mainline station.



Market Street, Maidenhead, SL6

Approximate Area = 848 sq ft / 78.7 sq m

For identification only - Not to scale

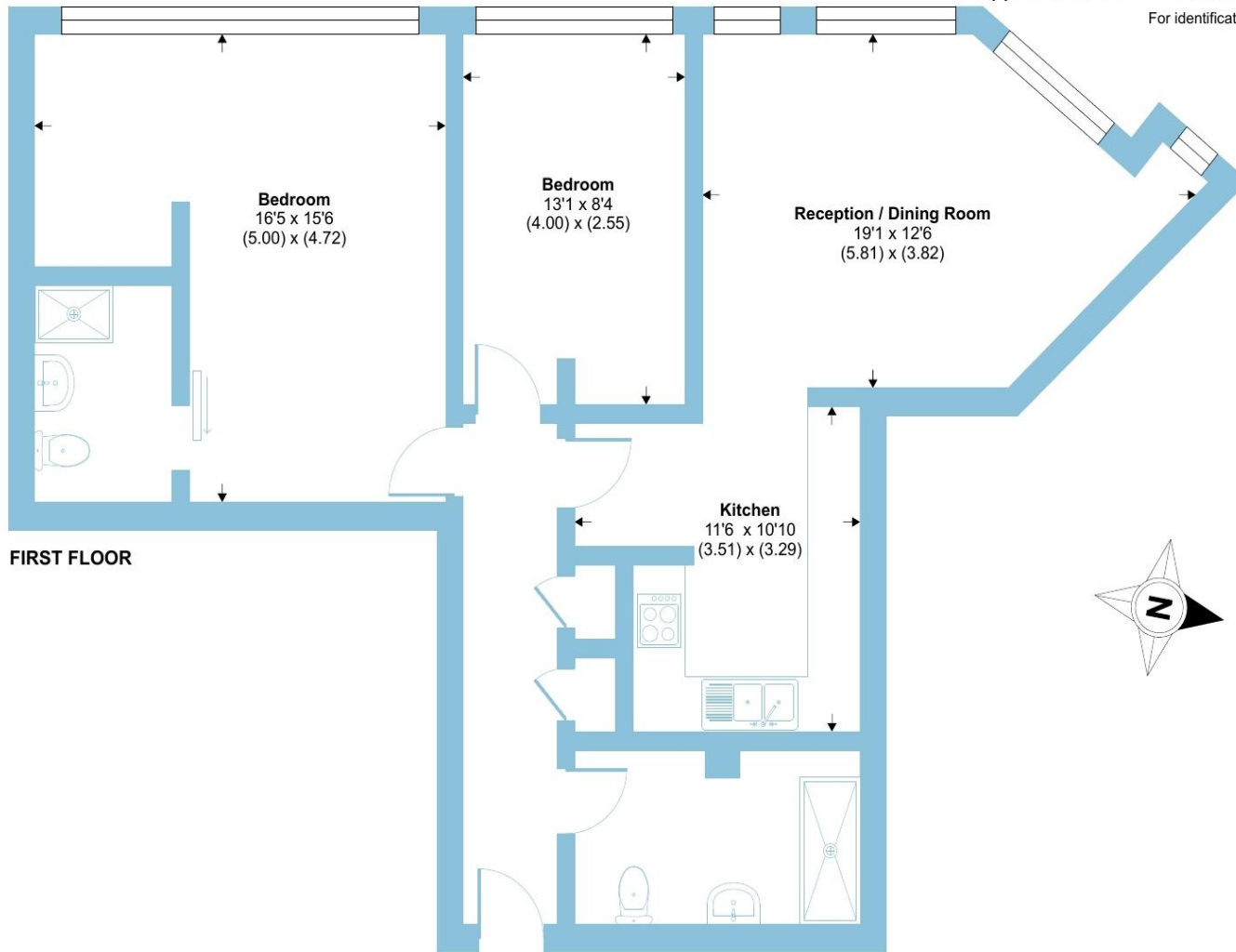

FIRST FLOOR

 Floor plan produced in accordance with RICS Property Measurement 2nd Edition, incorporating International Property Measurement Standards (IPMS2 Residential). © nchecon 2025. Produced for Barnard Marcus. REF: 1244776

 roger platt

welcome to

Flat 1 Butler House, 12-23 Market Street

- TOWN CENTRE APARTMENT
- TWO DOUBLE BEDROOMS
- EN-SUITE TO MAIN BEDROOM
- OPEN PLAN LIVING
- RE-FURBISHED THROUGHOUT
- LEASE IN EXCESS OF 100 YEARS
- CLOSE TO SHOPS & STATION
- COMPLETE UPPER CHAIN

Tenure: Leasehold EPC Rating: B

This is a Leasehold property with details as follows; Term of Lease 125 years from 01 Oct 2006. Should you require further information please contact the branch. Please Note additional fees could be incurred for items such as Leasehold packs.

£200,000



Please note the marker reflects the postcode not the actual property

check out more properties at rogerplatt.co.uk



Property Ref:
MHD122172 - 0001

1. MONEY LAUNDERING REGULATIONS Intending purchasers will be asked to produce identification documentation at a later stage and we would ask for your co-operation in order that there is no delay in agreeing the sale. 2. These particulars do not constitute part or all of an offer or contract. 3. The measurements indicated are supplied for guidance only and as such must be considered incorrect. Potential buyers are advised to recheck measurements before committing to any expense. 4. We have not tested any apparatus, equipment, fixtures or services and it is in the buyers interest to check the working condition of any appliances. 5. Where an EPC, or a Home Report (Scotland only) is held for this property, it is available for inspection at the branch by appointment. If you require a printed version of a Home Report, you will need to pay a reasonable production charge reflecting printing and other costs. 6. We are not able to offer an opinion either written or verbal on the content of these reports and this must be obtained from your legal representative. 7. Whilst we take care in preparing these reports, a buyer should ensure that his/her legal representative confirms as soon as possible all matters relating to title including the extent and boundaries of the property and other important matters before exchange of contracts.

Roger Platt is a trading name of Sequence (UK) Limited which is registered in England and Wales under company number 4268443, Registered Office is Cumbria House, 16-20 Hockliffe Street, Leighton Buzzard, Bedfordshire, LU7 1GN. VAT Registration Number is 500 2481 05.

roger platt



01628 773333



Maidenhead@rogerplatt.co.uk



25-29 Queen Street, MAIDENHEAD, Berkshire,
SL6 1NB



rogerplatt.co.uk