



**Flat 3 Ember Court, 2 Kingfisher Drive, Maidenhead SL6 8EL**



**welcome to**

**Flat 3 Ember Court, 2 Kingfisher Drive, Maidenhead**

Located in the popular Boulders Meadow development of Maidenhead towards the river Thames is this larger than average modern one bedroom ground floor apartment built by Shanly Homes in 2012. This apartment has been newly redecorated and is in immaculate condition.

Comprising: One large double bedroom with neutral colour carpet and built-in wardrobes, open plan living area with high gloss kitchen, under cabinet lighting and wood flooring, white bathroom suite, walk-in storage cupboard/utility room and a private terrace area.



## Kingfisher Drive, Maidenhead, SL6

Approximate Area = 559 sq ft / 51.9 sq m

For identification only - Not to scale

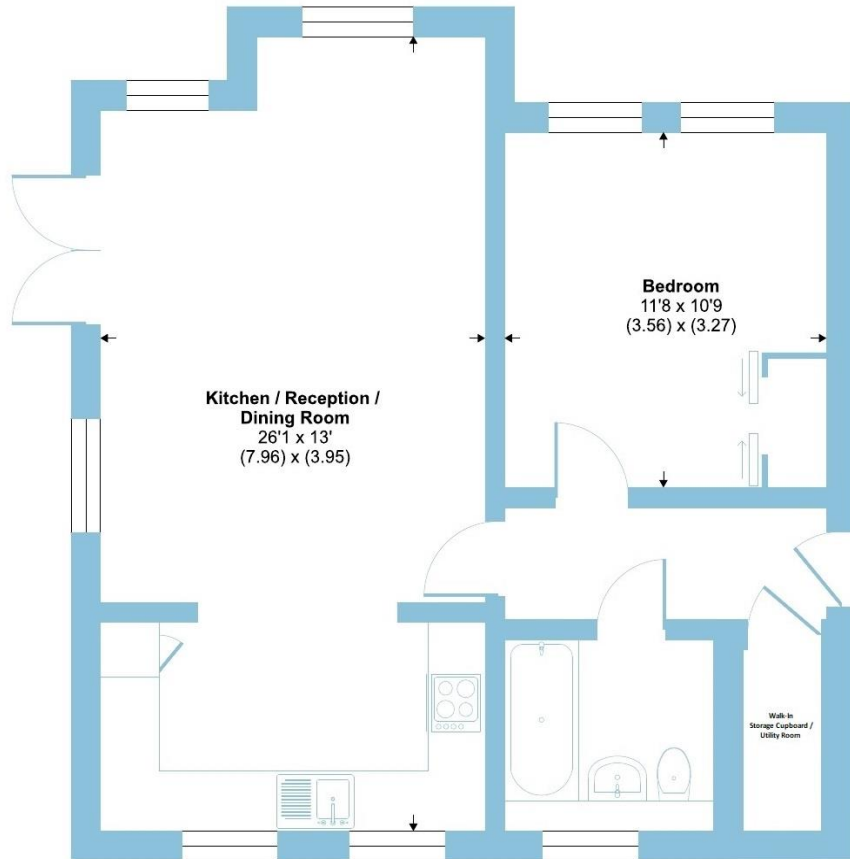

**GROUND FLOOR**



Floor plan produced in accordance with RICS Property Measurement 2nd Edition, Incorporating International Property Measurement Standards (IPMS2 Residential). © nixecom 2025. Produced for Barnard Marcus. REF: 1230199

  
roger platt



welcome to

## Flat 3 Ember Court, 2 Kingfisher Drive

- NO CHAIN GROUND FLOOR APARTMENT BUILT IN 2012
- LARGER THAN AVERAGE
- DOUBLE BEDROOM WITH BUILT-IN WARDROBES
- HIGH GLOSS KITCHEN WITH BUILT-IN APPLIANCES
- WALK-IN STORAGE CUPBOARD/UTILITY ROOM
- PRIVATE TERRACE AREA WITH GARDEN AREA WHICH IS FULLY MAINTAINED BY ONSITE GARDENERS
- PRIVATE PARKING SPACE
- VISITORS PARKING

Tenure: Leasehold EPC Rating: C

This is a Leasehold property with details as follows; Term of Lease 99 years from 01 Jul 2012. Should you require further information please contact the branch. Please Note additional fees could be incurred for items such as Leasehold packs.

**£230,000**



Please note the marker reflects the postcode not the actual property

**view this property online** [rogerplatt.co.uk/Property/MHD122094](https://rogerplatt.co.uk/Property/MHD122094)



Property Ref:  
MHD122094 - 0008

1. MONEY LAUNDERING REGULATIONS Intending purchasers will be asked to produce identification documentation at a later stage and we would ask for your co-operation in order that there is no delay in agreeing the sale. 2. These particulars do not constitute part or all of an offer or contract. 3. The measurements indicated are supplied for guidance only and as such must be considered incorrect. Potential buyers are advised to recheck measurements before committing to any expense. 4. We have not tested any apparatus, equipment, fixtures or services and it is in the buyers interest to check the working condition of any appliances. 5. Where an EPC, or a Home Report (Scotland only) is held for this property, it is available for inspection at the branch by appointment. If you require a printed version of a Home Report, you will need to pay a reasonable production charge reflecting printing and other costs. 6. We are not able to offer an opinion either written or verbal on the content of these reports and this must be obtained from your legal representative. 7. Whilst we take care in preparing these reports, a buyer should ensure that his/her legal representative confirms as soon as possible all matters relating to title including the extent and boundaries of the property and other important matters before exchange of contracts.

Roger Platt is a trading name of Sequence (UK) Limited which is registered in England and Wales under company number 4268443, Registered Office is Cumbria House, 16-20 Hockliffe Street, Leighton Buzzard, Bedfordshire, LU7 1GN. VAT Registration Number is 500 2481 05.

  
roger platt



**01628 773333**



[Maidenhead@rogerplatt.co.uk](mailto:Maidenhead@rogerplatt.co.uk)



25-29 Queen Street, MAIDENHEAD, Berkshire,  
SL6 1NB



**[rogerplatt.co.uk](https://rogerplatt.co.uk)**