



**Flat 4 Ember Court, 2 Kingfisher Drive, Maidenhead SL6 8EL**

**welcome to**

**Flat 4 Ember Court, 2 Kingfisher Drive, Maidenhead**

A very well presented two bedroom, two bathroom first floor apartment being offered for sale with **NO UPPER CHAIN**. The property has spacious open plan living, with access onto a private balcony. There is residents parking and the property is located within a cul-de-sac development, within easy reach of the town centre and station.



# Ember Court, 2 Kingfisher Drive, Maidenhead, SL6

Approximate Area = 746 sq ft / 69.3 sq m

For identification only - Not to scale

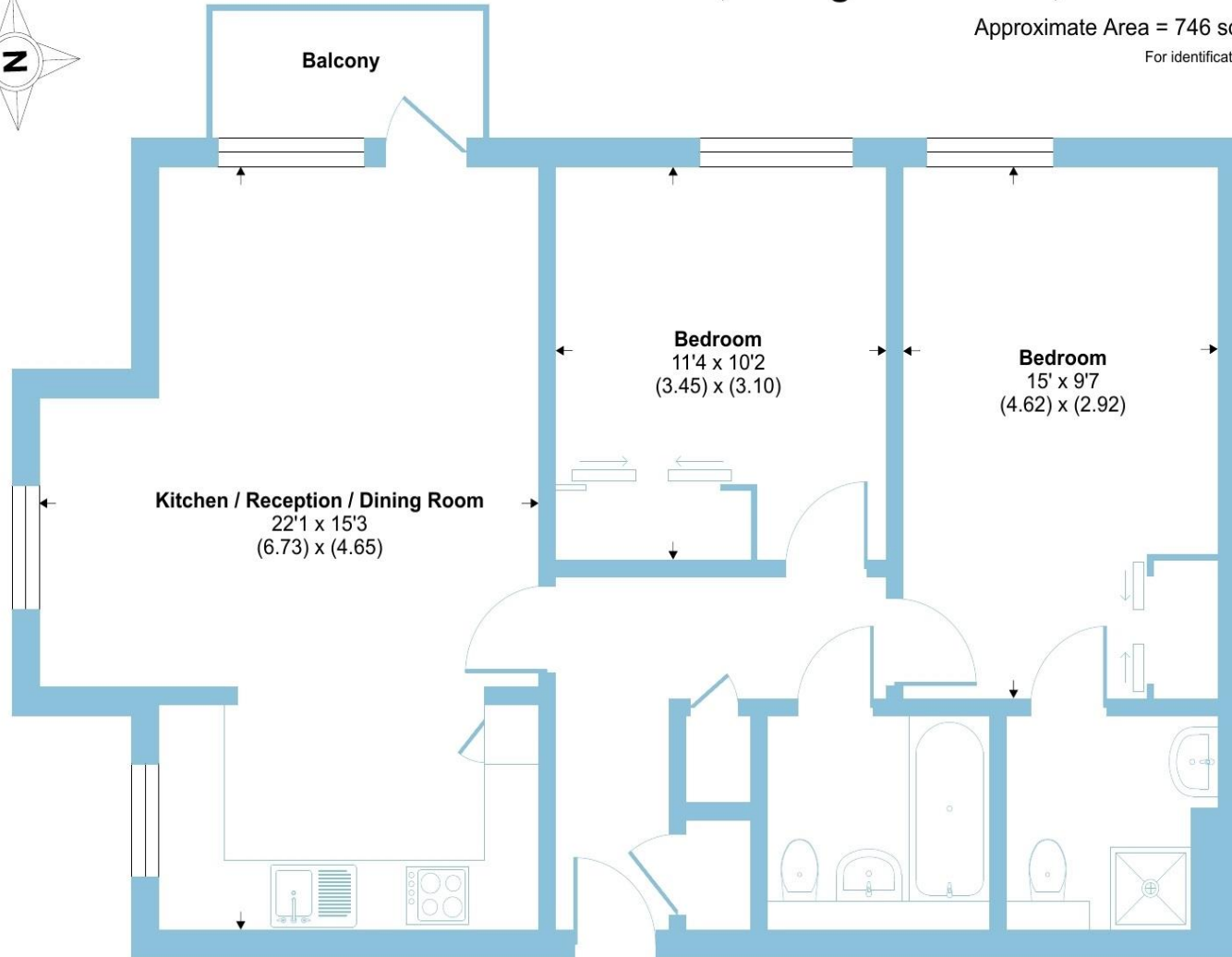

FIRST FLOOR



Floor plan produced in accordance with RICS Property Measurement Standards incorporating International Property Measurement Standards (IPMS2 Residential). © ncheocom 2024. Produced for Barnard Marcus. REF: 1192404



welcome to

## Flat 4 Ember Court, 2 Kingfisher Drive, Maidenhead

- NO UPPER CHAIN
- PRIVATE BALCONY
- TWO BEDROOMS
- TWO BATHROOMS
- RESIDENTS PARKING
- POPULAR DEVELOPMENT
- CLOSE TO TOWN CENTRE

Tenure: Leasehold EPC Rating: B

This is a Leasehold property with details as follows; Term of Lease 99 years from 01 Jul 2012. Should you require further information please contact the branch. Please Note additional fees could be incurred for items such as Leasehold packs.

# £325,000



Please note the marker reflects the postcode not the actual property

**view this property online** [rogerplatt.co.uk/Property/MHD121834](https://rogerplatt.co.uk/Property/MHD121834)



Property Ref:  
MHD121834 - 0006

1. MONEY LAUNDERING REGULATIONS Intending purchasers will be asked to produce identification documentation at a later stage and we would ask for your co-operation in order that there is no delay in agreeing the sale. 2. These particulars do not constitute part or all of an offer or contract. 3. The measurements indicated are supplied for guidance only and as such must be considered incorrect. Potential buyers are advised to recheck measurements before committing to any expense. 4. We have not tested any apparatus, equipment, fixtures or services and it is in the buyers interest to check the working condition of any appliances. 5. Where an EPC, or a Home Report (Scotland only) is held for this property, it is available for inspection at the branch by appointment. If you require a printed version of a Home Report, you will need to pay a reasonable production charge reflecting printing and other costs. 6. We are not able to offer an opinion either written or verbal on the content of these reports and this must be obtained from your legal representative. 7. Whilst we take care in preparing these reports, a buyer should ensure that his/her legal representative confirms as soon as possible all matters relating to title including the extent and boundaries of the property and other important matters before exchange of contracts.

Roger Platt is a trading name of Sequence (UK) Limited which is registered in England and Wales under company number 4268443, Registered Office is Cumbria House, 16-20 Hockliffe Street, Leighton Buzzard, Bedfordshire, LU7 1GN. VAT Registration Number is 500 2481 05.

  
roger platt



**01628 773333**



[Maidenhead@rogerplatt.co.uk](mailto:Maidenhead@rogerplatt.co.uk)



25-29 Queen Street, MAIDENHEAD, Berkshire,  
SL6 1NB



[rogerplatt.co.uk](https://rogerplatt.co.uk)