



**Flat 11 Jubilee Mill, Glen Island, Taplow, Maidenhead SL6 0BN**



**welcome to**

**Flat 11 Jubilee Mill, Glen Island, Taplow, Maidenhead**

Beautifully presented two bedroom apartment built in 2021 by Berkeley homes boasting over 980 square foot of living space with two balconies capturing fantastic views of the Jubilee River. The property consists of: two large double bedrooms - the main offering an impeccably kept en-suite as well as a balcony overlooking the river, another bathroom suite, 25ft living room with plenty of dining space as well as a second balcony overlooking the river, contemporary kitchen which can be separated or kept open plan and plenty of extra storage space.



# Jubilee Mill, Glen Island, Taplow, Maidenhead, SL6

Approximate Area = 983 sq ft / 91.3 sq m

For identification only - Not to scale

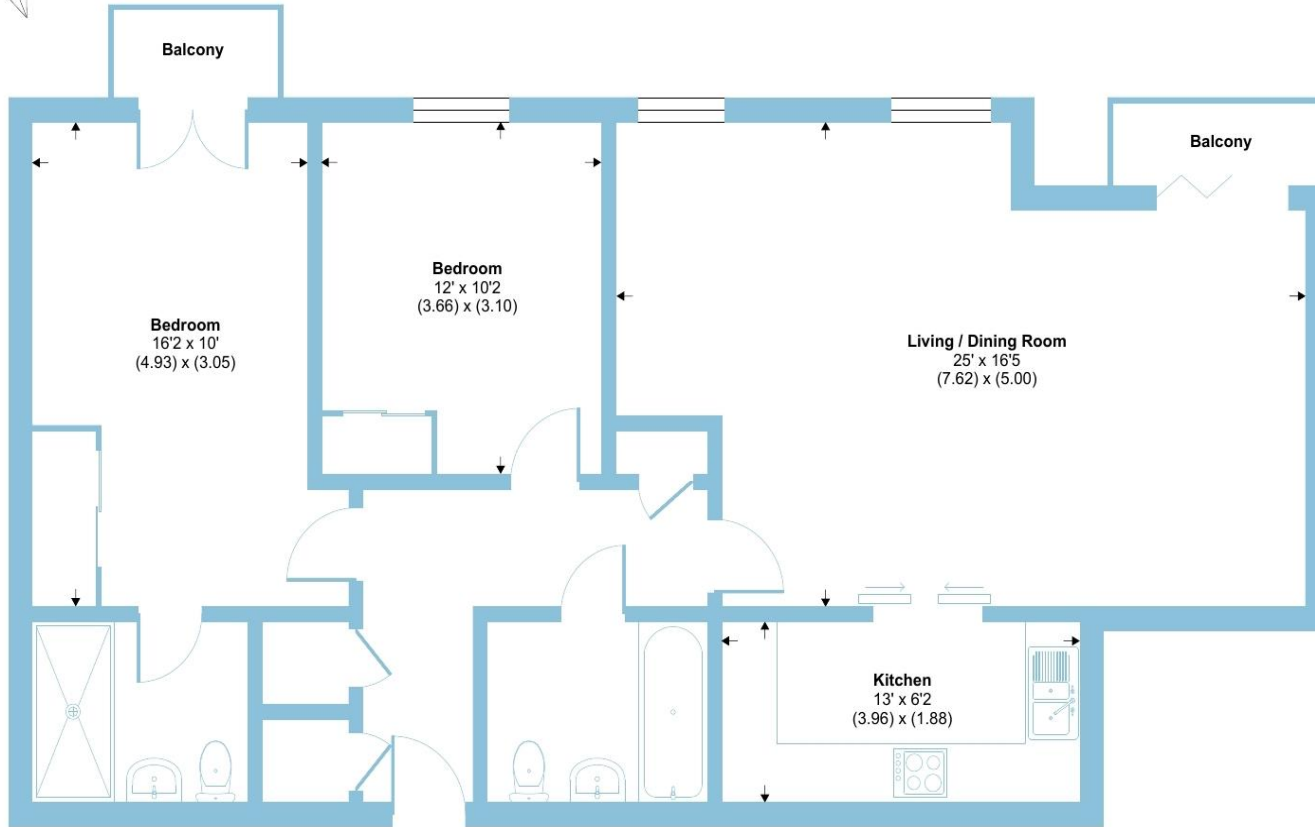

FIRST FLOOR



Floor plan produced in accordance with RICS Property Measurement Standards incorporating International Property Measurement Standards (IPMS2 Residential). © nchecon 2024. Produced for Barnard Marcus. REF: 1109436



welcome to

## Flat 11 Jubilee Mill, Glen Island, Taplow

- BEAUTIFULLY PRESENTED
- VIEWS OVER THE JUBILEE RIVER
- OVER 980 SQFT
- TWO BALCONIES
- TWO LARGE DOUBLE BEDROOMS
- 25FT LIVING ROOM
- PLENTY OF EXTRA STORAGE SPACE
- PARKING

Tenure: Leasehold EPC Rating: B

This is a Leasehold property with details as follows; Term of Lease 999 years from 01 Aug 2018. Should you require further information please contact the branch. Please Note additional fees could be incurred for items such as Leasehold packs.

guide price

**£700,000**



check out more properties at [rogerplatt.co.uk](http://rogerplatt.co.uk)



Property Ref:  
MHD121280 - 0001

1. MONEY LAUNDERING REGULATIONS Intending purchasers will be asked to produce identification documentation at a later stage and we would ask for your co-operation in order that there is no delay in agreeing the sale. 2. These particulars do not constitute part or all of an offer or contract. 3. The measurements indicated are supplied for guidance only and as such must be considered incorrect. Potential buyers are advised to recheck measurements before committing to any expense. 4. We have not tested any apparatus, equipment, fixtures or services and it is in the buyers interest to check the working condition of any appliances. 5. Where an EPC, or a Home Report (Scotland only) is held for this property, it is available for inspection at the branch by appointment. If you require a printed version of a Home Report, you will need to pay a reasonable production charge reflecting printing and other costs. 6. We are not able to offer an opinion either written or verbal on the content of these reports and this must be obtained from your legal representative. 7. Whilst we take care in preparing these reports, a buyer should ensure that his/her legal representative confirms as soon as possible all matters relating to title including the extent and boundaries of the property and other important matters before exchange of contracts.

Roger Platt is a trading name of Sequence (UK) Limited which is registered in England and Wales under company number 4268443, Registered Office is Cumbria House, 16-20 Hockliffe Street, Leighton Buzzard, Bedfordshire, LU7 1GN. VAT Registration Number is 500 2481 05.

  
roger platt



**01628 773333**



[Maidenhead@rogerplatt.co.uk](mailto:Maidenhead@rogerplatt.co.uk)



25-29 Queen Street, MAIDENHEAD, Berkshire,  
SL6 1NB



[rogerplatt.co.uk](http://rogerplatt.co.uk)

Please note the marker reflects the  
postcode not the actual property